

SWITCH FUNCTION		
POS. 1	POS. 2	POS. 3
ON	NONE	ON
2-3, 5-6	OPEN	2-1, 5-4

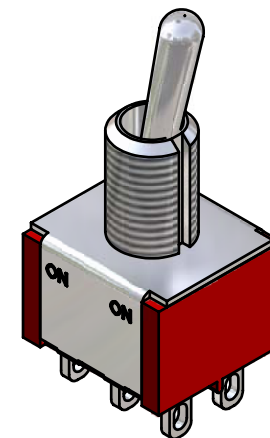

ISOMETRIC

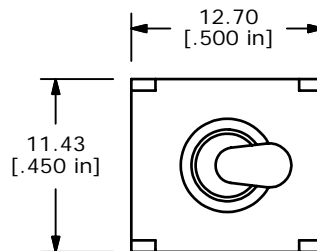
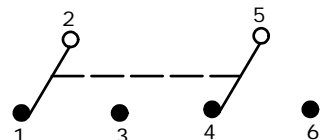

CIRCUIT: DPDT

NOTE:

- ALL DIMENSIONS IN MM [INCH]
- GENERAL TOLERANCE: X.X=±0.4
X.XX=±0.25
- TERMINAL NUMBERS FOR REF ONLY
- ▲ PLATING MATERIAL: GOLD OVER SILVER
GOLD: 10 MICRO INCH OVER
SILVER: 400 MICRO INCH
- RATING: 5A @120 VAC; 2A @250 VAC
- ELECTRIC LIFE: 40,000 MAKE-AND-BREAK CYCLES AT FULL LOAD.
- INSULATION RESISTANCE: 1,000 MEGA-OHMS MIN
- DIELECTRIC STRENGTH: 1,000 V RMS @SEA LEVEL.
- OPERATING TEMP.: -30°C to 85°C
- ▲ DENOTES CRITICAL PARAMETER.
- 2002/95/EC (ROHS) COMPLIANT

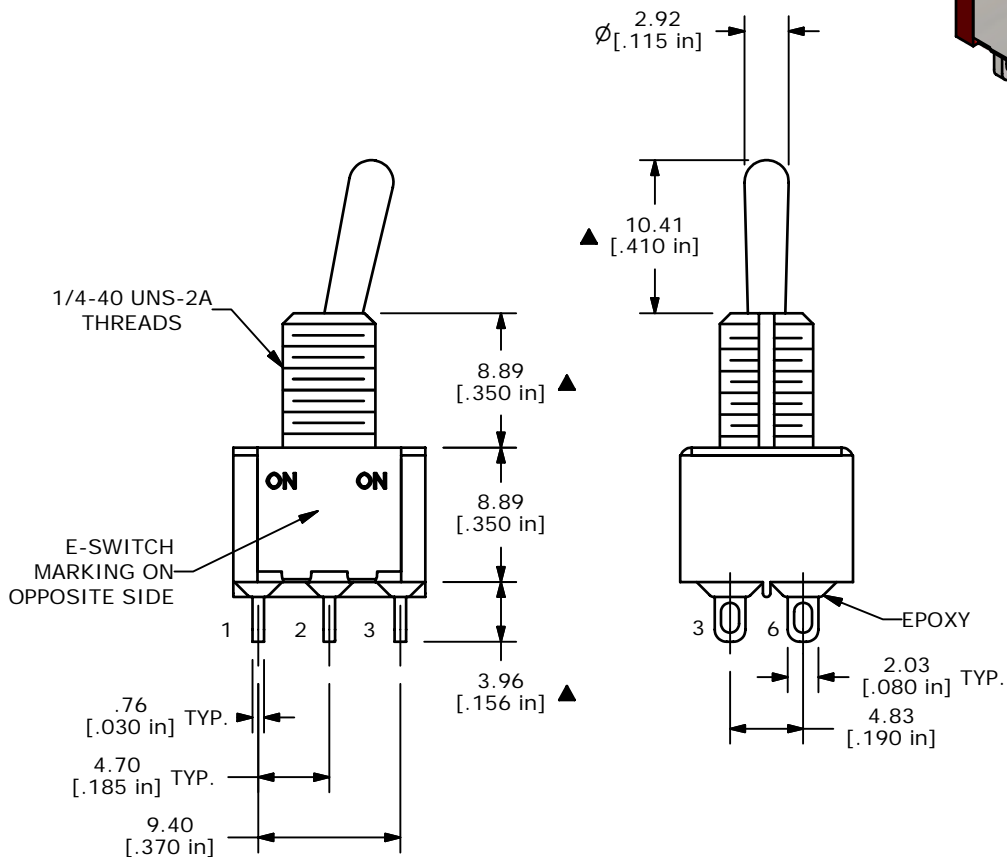

E	15831	EDIT SWITCH FUNCTION	3/1/06	PH
D	15789	ADD ROHS	2/17/06	PH
C	14949	CORRECTED RATING	5/26/05	JB
B	14550	CORRECT RATING & PLATING NOTES	11/30/04	AR
A	14200	RELEASED FOR PRODUCTION	8/2/04	AR
REV	PCR NO	DESCRIPTION	DATE	BY

E-SWITCH®

TITLE 100DP1T1B1M1CE

THE INFORMATION CONTAINED IN THIS DOCUMENT IS PROPRIETARY TO E-SWITCH AND IS NOT TO BE COPIED OR TRANSFERRED

SCALE	DATE	DR	DWG	REV
2:1	8/2/2004	AR	T121025	E