

UNAUTHORIZED USE OF THIS  
DRAWING IS STRICTLY PROHIBITED

DAR	REV	DESCRIPTION	APPVD	DATE
2580	A	INITIAL RELEASE	DG	7-10
4048	B	SEE DAR	DG	12-12

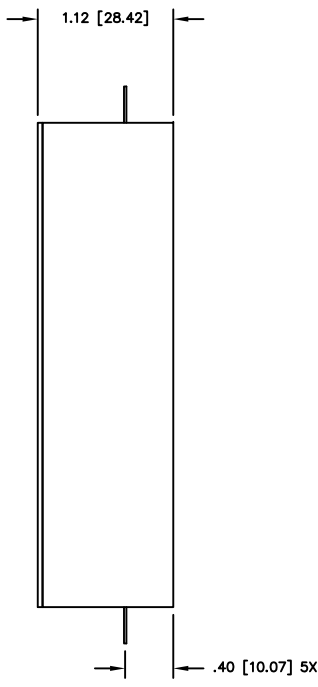
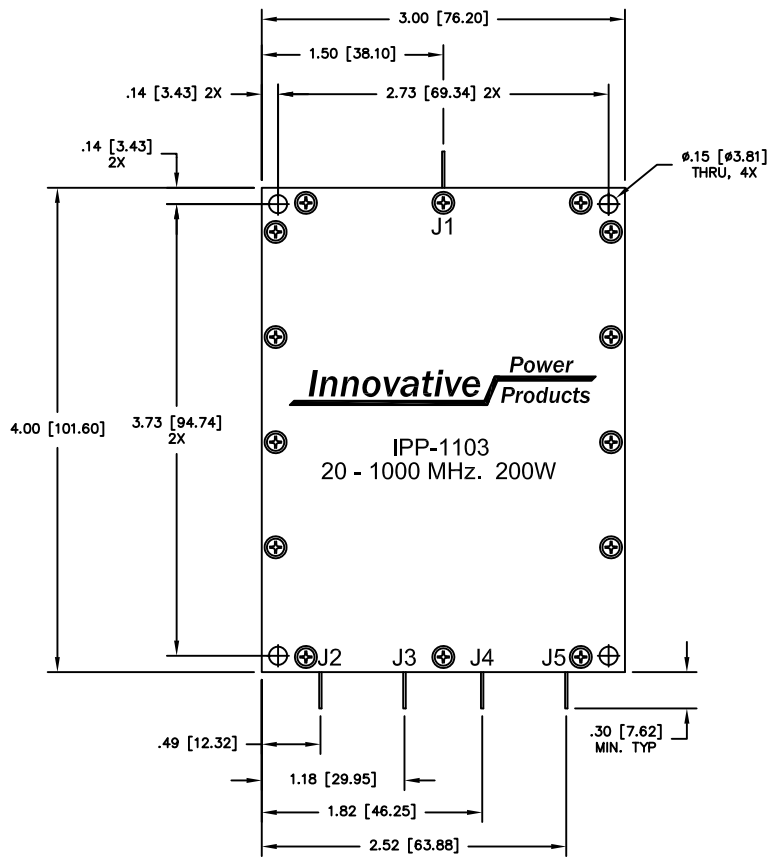

NOTES:

1. CONNECTORS: J1 - J5: .020 DIA PIN

ELECTRICAL SPECIFICATIONS

FREQUENCY: 20 - 1000 MHz.  
 INSERTION LOSS: < 0.75 dB  
 VSWR: < 1.30:1  
 PHASE BALANCE: ±5°  
 AMPLITUDE BALANCE: ±0.25 dB  
 POWER: 200 WATT  
 ISOLATION: >12 dB 20-125 MHz  
 >15 dB 125-1000 MHz  
 TEMPERATURE: -55°C TO 85°C

MATERIAL AL. ALLOY 6061-T651	DWN S.Cornell	DATE 4-30-10	<b>Innovative Power Products</b>		
	ENG DG	DATE 7-10			
FINISH CHEM FILM CLEAR PER MIL-DTL-5541, TYPE 2, REV F, CLASS 3 ROHS COMPLIANT	MANUF	DATE	TITLE OUTLINE		
	CAGE CODE: 437R2		4 - WAY 20 - 1000 MHz 200 WATT		
TOLERANCE .XX ±.02 .XXX ±.010 ANG. ±1/2°	SHEET OF 1 1	SCALE 1:1	SIZE B	P/N IPP-1103	REV. B