

Rev	AWO #	Description	Date	Appr
-		RELEASED	4/21/11	

APPROVED: _____
 DATE: _____ TITLE: _____

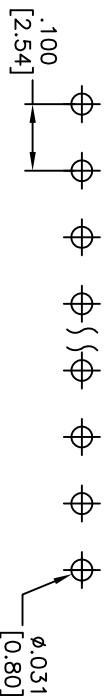

RECOMMENDED PCB LAYOUT

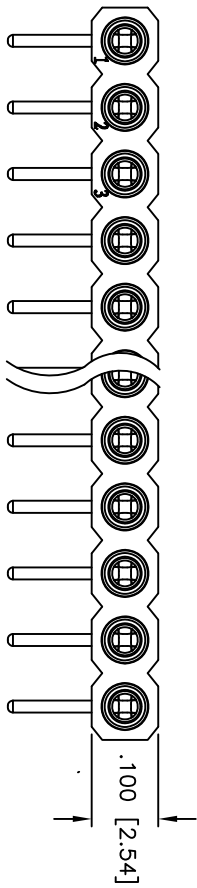
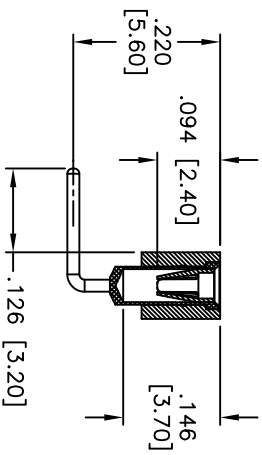
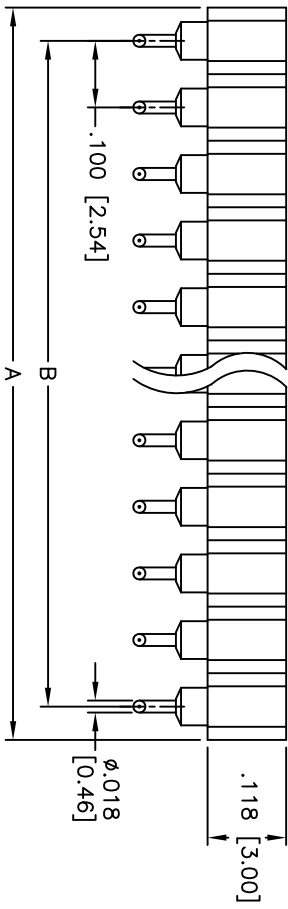

SPECIFICATIONS:
 Material: HI-thermoplastic, Glass reinforced, rated UL 94V-0
 Insulator color: Black
 Contacts: BeCu
 Sleeve: Brass

Plating:
 Inner contact: Gold flash over Nickel underplate
 Outer sleeve: Tin over Copper underplate overall

Electrical:
 Current rating: 3 Amp
 Contact resistance: 10 mohms max
 Dielectric Strength: 1000V RMS min
 Temperature Rating:
 Operating temperature: -40°C to +105°C

Environmental:
 Lead free, RoHS compliant
 Recommended soldering temp: 260°C for 5 seconds

Positions: 2 thru 40
 A = .100 [2.54] x No. of Positions
 B = .100 [2.54] x No. of Spaces

UNLESS OTHERWISE SPECIFIED
 ALL DIMENSIONS ARE INCHES [MM]
 TOLERANCES: EXCEPT AS NOTED
 INCHES: .X ± .10 ØXX ± .10
 .XX ± .020 ØXXX ± .015
 .XXX ± .015 ØXXXX ± .010

DRAWN		DY		4/21/11	
CHECKED					
APPROVED					

ADAM TECH

909 Rahway Avenue, Union, NJ 07083
 Phone: 908-687-5000 Fax: 908-687-5710

TITLE: .100 [2.54] MACHINED FEMALE HEADER,
 SINGLE ROW, RIGHT ANGLE, GOLD/TIN PLATED

SIZE	PART NO.	REV.
X	SMC-1R-XX-1GT-HT	
REF:	S00019C	SHEET 1 OF 1



6 5 4 3 2 1