

Jam Nut Receptacle

MS 3114H

KPT07H

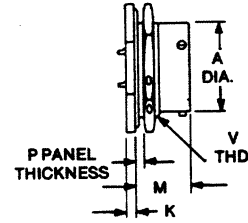
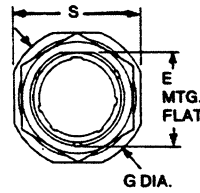
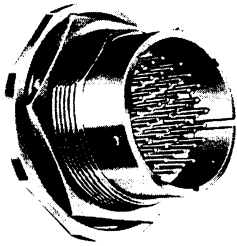

KPTH/  
PVAH

Shell Size	A	E	G	K		P		S	V	
	± .003 (0.08)	± .005 (0.13)	Max.	+ .001 (0.03)	- .016 (0.41)	± .015 (0.38)	Min.	Max.	Max.	
8	.471 (11.96)	.525 (13.34)	1.078 (27.38)	.094 (2.39)	-.016 (0.41)	.707 (17.96)	.062 (1.57)	.125 (3.18)	.954 (24.23)	9/16-24UNEF-2A
10	.588 (14.94)	.650 (16.51)	1.203 (30.56)	.094 (2.39)	-.016 (0.41)	.707 (17.96)	.062 (1.57)	.125 (3.18)	1.078 (27.38)	11/16-24UNEF-2A
12	.748 (19.00)	.813 (20.65)	1.391 (35.33)	.094 (2.39)	-.016 (0.41)	.707 (17.96)	.062 (1.57)	.125 (3.18)	1.266 (32.16)	7/8-20UNEF-2A
14	.873 (22.17)	.937 (23.80)	1.516 (38.51)	.094 (2.39)	-.016 (0.41)	.707 (17.96)	.062 (1.57)	.125 (3.18)	1.391 (35.33)	1-20UNEF-2A
16	.998 (25.35)	1.061 (26.95)	1.641 (41.68)	.094 (2.39)	-.016 (0.41)	.707 (17.96)	.062 (1.57)	.125 (3.18)	1.516 (38.51)	1-1/8-18UNEF-2A
18	1.123 (28.52)	1.186 (30.12)	1.766 (44.86)	.094 (2.39)	-.016 (0.41)	.707 (17.96)	.062 (1.57)	.125 (3.18)	1.641 (41.68)	1-1/4-18UNEF-2A
20	1.248 (31.70)	1.311 (33.30)	1.954 (49.63)	.125 (3.18)	-.016 (0.41)	.895 (22.73)	.062 (1.57)	.250 (6.35)	1.828 (46.43)	1-3/8-18UNEF-2A
22	1.373 (34.87)	1.436 (36.47)	2.078 (52.78)	.125 (3.18)	-.016 (0.41)	.895 (22.73)	.062 (1.57)	.250 (6.35)	1.954 (49.63)	1-1/2-18UNEF-2A
24	1.498 (38.05)	1.561 (39.65)	2.203 (55.96)	.125 (3.18)	-.016 (0.41)	.928 (23.59)	.062 (1.57)	.250 (6.35)	2.078 (52.78)	1-5/8-18UNEF-2A

Panel Cutouts — KPTH

Flange Mounted Receptacle  
(Front Mounting)

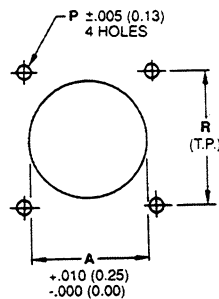

Jam Nut Receptacle

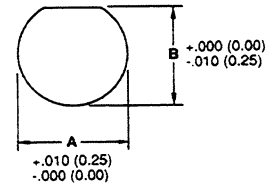

Shell Size	KPT02H/KPT01H		KPT02H	
	A	R*	± .005 (0.13)	Screw
8	.565 (14.35)	.594 (15.09)	.125 (3.18)	#4
10	.675 (17.14)	.719 (18.26)	.125 (3.18)	#4
12	.784 (19.91)	.812 (20.62)	.125 (3.18)	#4
14	.909 (23.09)	.906 (23.01)	.125 (3.18)	#4
16	1.034 (26.26)	.969 (24.62)	.125 (3.18)	#4
18	1.159 (29.44)	1.062 (26.97)	.125 (3.18)	#4
20	1.253 (31.83)	1.156 (29.36)	.125 (3.18)	#4
22	1.378 (35.00)	1.250 (31.75)	.125 (3.18)	#4
24	1.503 (38.18)	1.375 (34.92)	.155 (3.94)	#6

Shell Size	KPT07H	
	A	B
8	.567 (14.40)	.531 (13.49)
10	.692 (17.58)	.656 (16.66)
12	.880 (22.35)	.819 (20.80)
14	1.005 (25.53)	.943 (23.95)
16	1.130 (28.70)	1.067 (27.10)
18	1.255 (31.88)	1.192 (30.28)
20	1.380 (35.05)	1.317 (33.45)
22	1.505 (38.23)	1.442 (36.63)
24	1.630 (41.40)	1.567 (39.80)

\*Not used in KPT01H connectors.