

**MICRO SWITCH**  
a Honeywell Division

FED. MFG. CODE 91 929

**SWITCH-BASIC**

CATALOG LISTING  
**V7-1A17D8**  
**CW-B0240**

CATALOG LISTING  
**V7-1A17D8**

ISSUE  
**M**  
5

REPLACES X94122-V7  
RELEASE NO. PR-17140

REVISIONS	
A	C066350 JAP 21 SEP 89
B	C069746 WJC 15 MAR 91
C	C074430 D.H.D. 24 FEB 93
D	0085964 SBH 30 JAN 12

CHECK 30 JAN 12  
CHECK CMH  
CHECK J A P  
CHECK 27 FEB 89  
DRAWN DCS

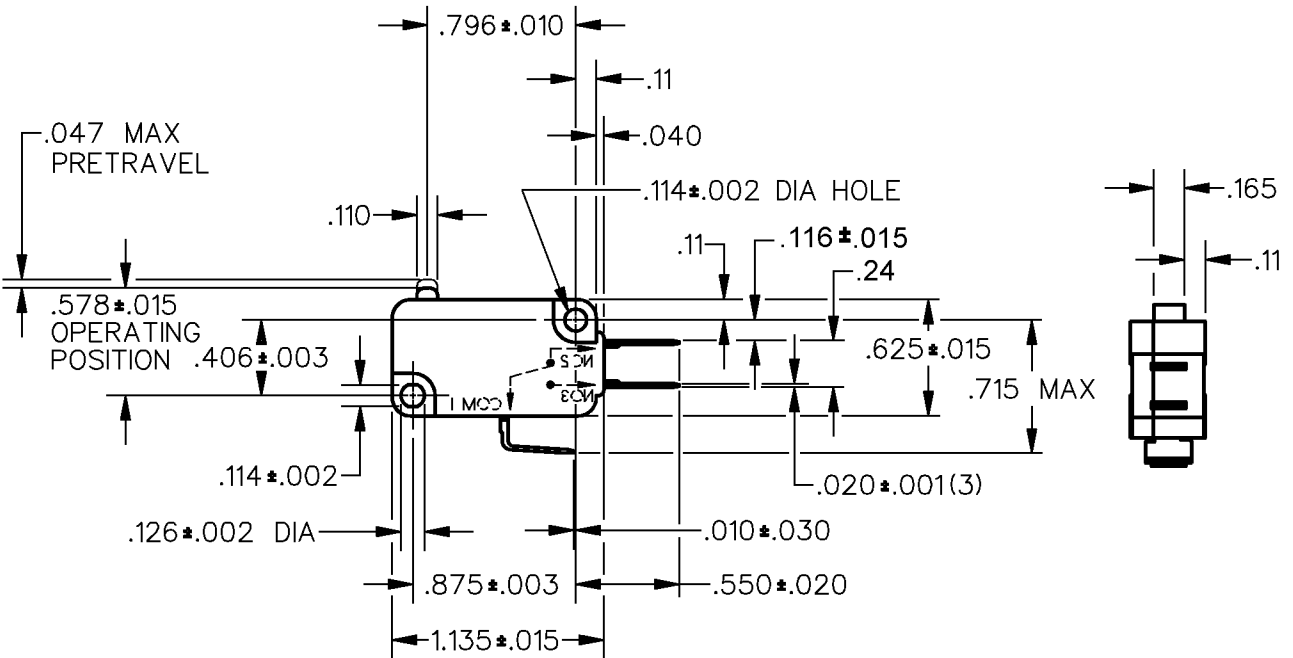
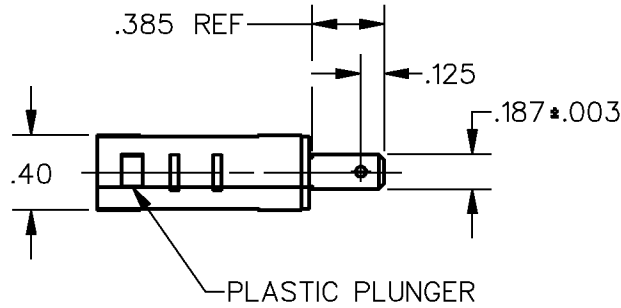

THIS DRAWING COVERS A PROPRIETARY ITEM AND IS THE PROPERTY OF MICRO SWITCH, A DIVISION OF HONEYWELL. THIS DRAWING IS NOT TO BE COPIED OR USED WITHOUT THE APPROVAL OF MICRO SWITCH.

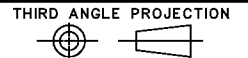

CHARACTERISTICS	ELECTRICAL DATA	SCALE	NONE	DO NOT SCALE PRINT
OPERATING FORCE --- 150 GRAMS MAX	CONTACT ARRANGEMENT S P D T	<b>UNLESS OTHERWISE SPECIFIED TOLERANCES ARE</b>		
RELEASE FORCE --- 25 GRAMS MIN	L162 5A 125, <u>250</u> , 277 VAC 1/10 HP <u>250</u> VAC	ONE PLACE (.0)	±.030	
DIFFERENTIAL TRAVEL --- .002-.010		TWO PLACE (.00)	±.015	
OVERTRAVEL --- .050 MIN		THREE PLACE (.000)	±.005	
FREE POSITION --- .625 MAX		ANGLES	±	
RELEASE TRAVEL --- .010 MIN		WEIGHT		