

**Leiterplatten-Layout Vorschlag / PCB-Layout Proposal**

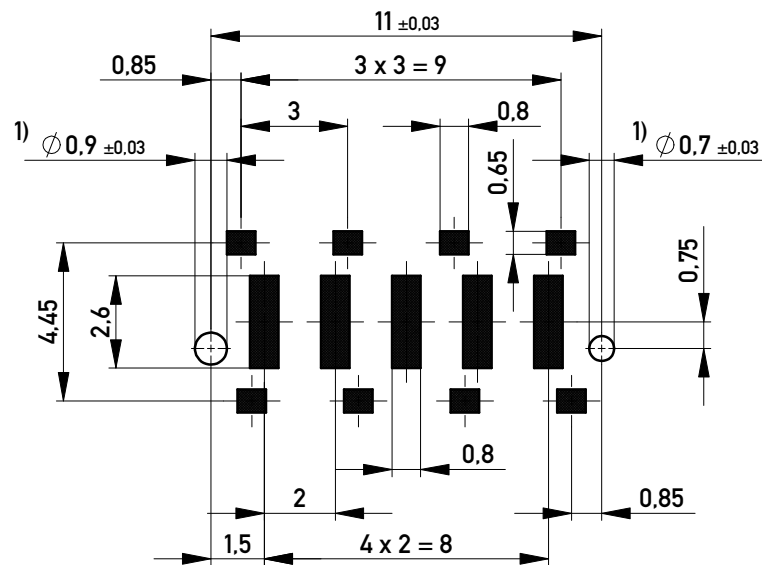

1) Durchmesser des Bohrers / Drill tool

Verpackt im Gurt nach DIN IEC 60286-3  
Tape on Reel Packaging according to DIN IEC 60286-3  
Verpackungseinheit: 220 Stück  
Packaging unit: 220 pcs

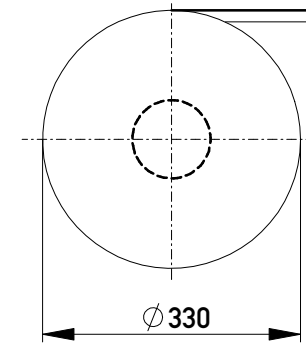

Abspulrichtung - Reel off Direction

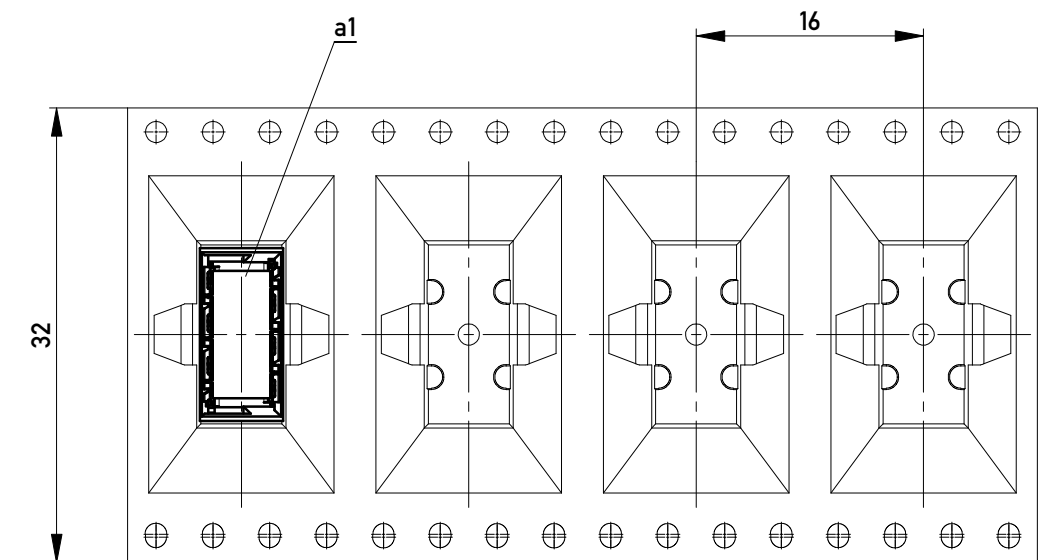

Anforderungsstufe 1  
Performance Level 1

Kontaktbereich vergoldet  
Mating Area gold plating

Anschlussbereich verzinkt 4-6 µm  
Terminal Area 4-6 µm tin plating

Koplanarität der Anschlüsse ≤ 0,1 mm  
Coplanarity Area of Termination ≤ 0,1 mm

Information:  All rights reserved. Only for Information. To ensure that this is the latest version of this drawing, please contact one of the ERNI companies before using.	Tolerances  All Dimensions in mm	Scale	5:1
		Designation	Messerleiste SMD, Powerm. 10mm Male Con. SMD, Powerm. 10mm
Copyright by ERNI GmbH Proprietary notice pursuant to ISO 16016 to be observed.	Subject to modification without prior notice. Drawing will not be updated.	www.ERNI.com	
		100100010002	K A3
l	07.02.2014	Class MSPEED	
Index	Date		