

## Splashproof/Sealed SmartSwitches



Polyurethane overlay can be used to splashproof SmartSwitches. It is possible to achieve IP65 rating by proper installation.

Polyurethane overlay is 0.3 mm thick with transmissivity of 90%. The overlay comes with 5mm wide adhesive on the perimeter. Installing an overlay over the switches' cutout opening is sufficient to render the assembly splashproof. To achieve a higher IP rating a supporting bracket should be used to reinforce the adhesive tape.

NKK can provide custom sizes for the overlay and bracket. Please submit your requirement to: [engineering@nkkswitches.com](mailto:engineering@nkkswitches.com)

Below are some overlay examples for reference.

## Example overlay drawing for 4x4 switches

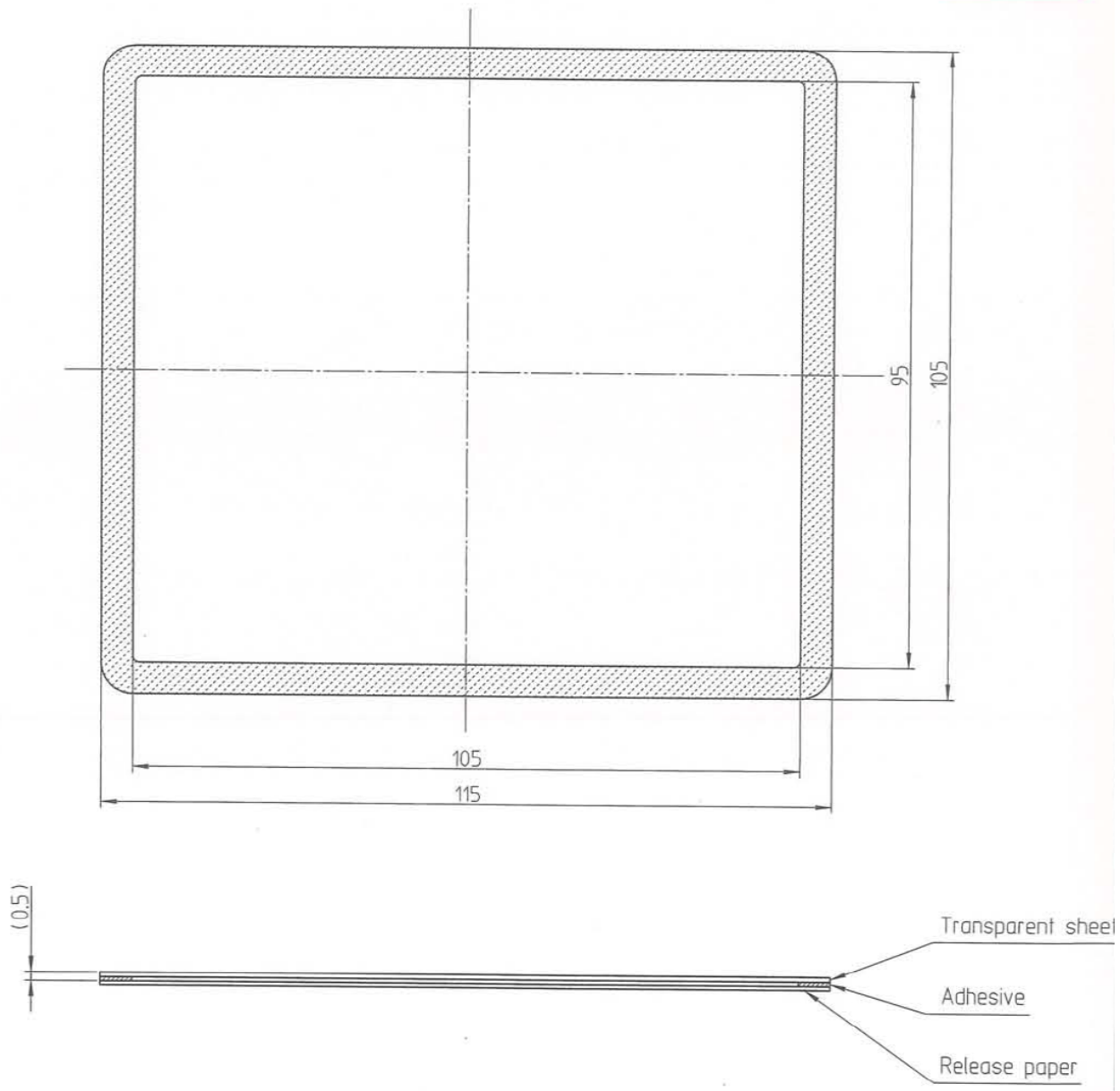

## Installation of overlay only

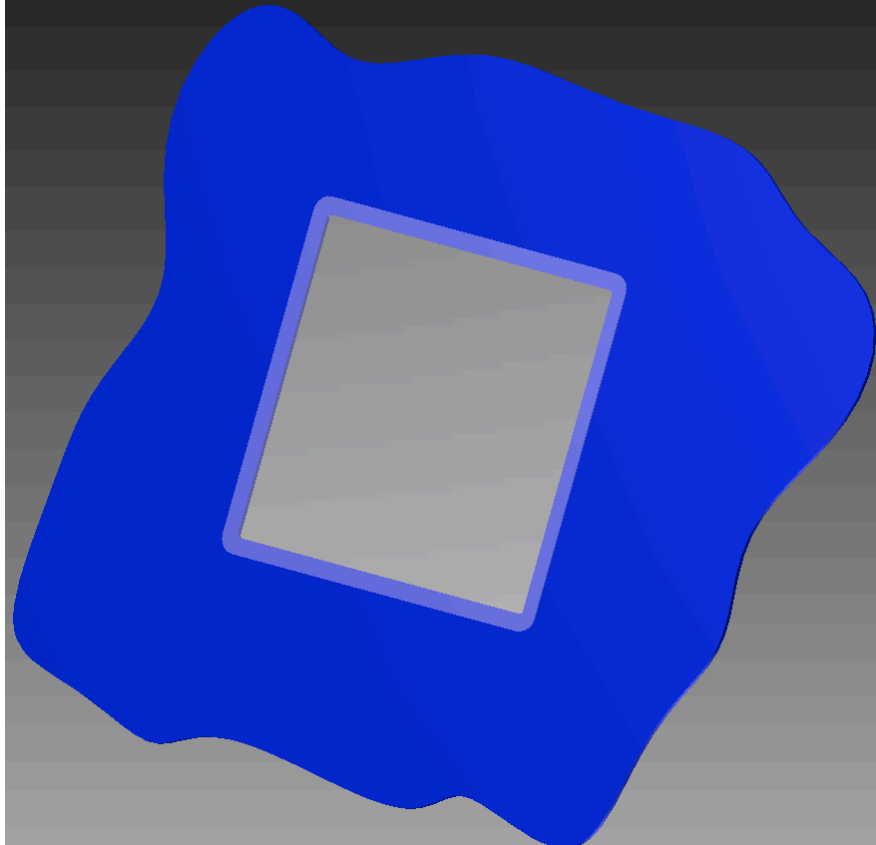
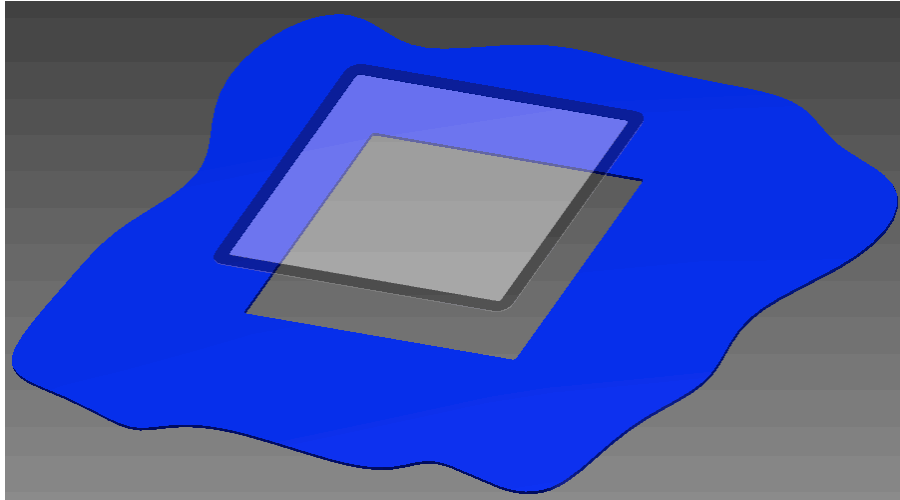

Installing overlay and bracket to back side of the panel.

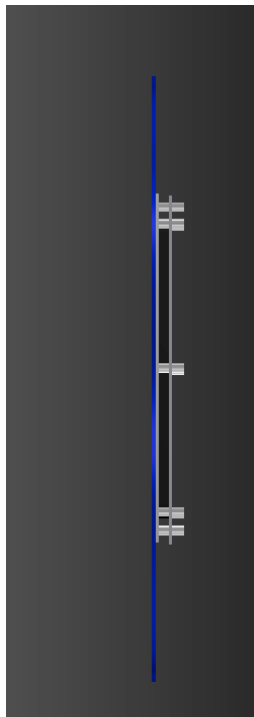
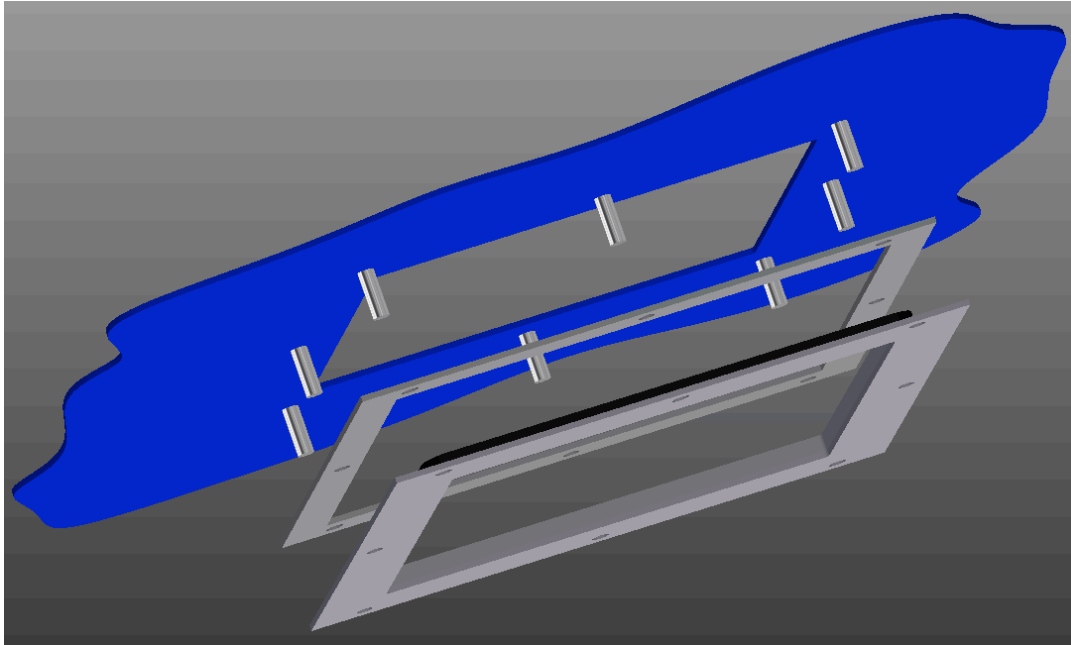

Please note that the panel has to have studs for installation.