

SPF TERMINAL

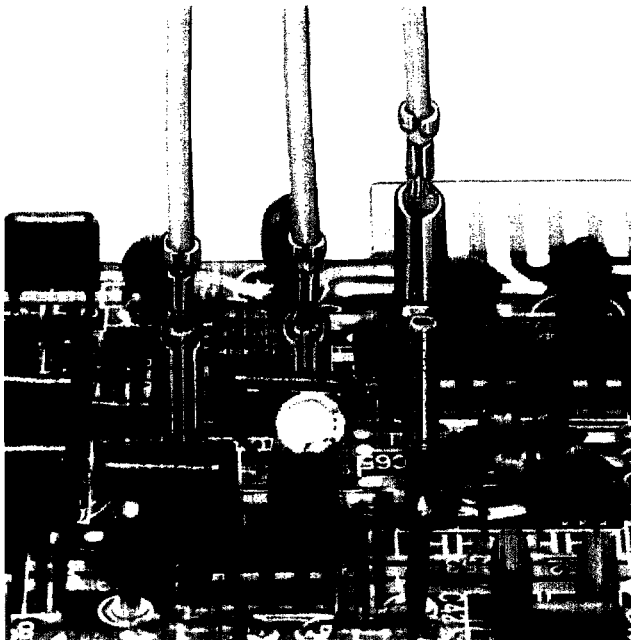

This terminal is used with 2.36mm (.093") diameter GT pins. The SPF terminal has a large contact area, withstands stress caused by repeated insertions and removals, and provides excellent retaining force. It is best suited for circuit connections that require a large current.

Specifications

- Current rating: 5.0A AC, DC
- Temperature range: -25°C to +85°C
(including temperature rise in applying electrical current)
- Contact resistance: Initial value/10mΩ max.
After environmental testing/20mΩ max.
- Applicable wire: AWG #24 to #20
- Applicable PC board thickness: 1.6mm(.063")
- * Contact JST for details.

Terminal

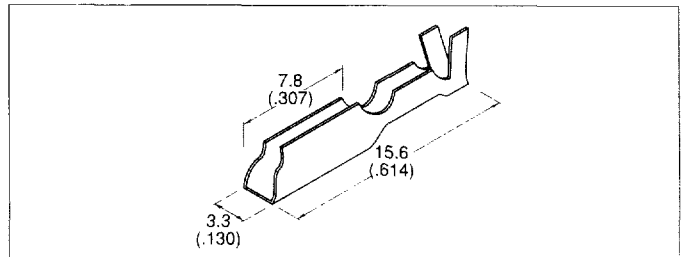

Model No.	Applicable wire		Insulation O.D. mm(in.)	Q'ty / reel
	mm ²	AWG#		
SPF-01T-2.5C	0.2 to 0.5	24 to 20	1.6 to 2.7(.063 to .106)	10,000

Material and Finish

Brass, Tin-plated

Note: Contact JST for details if you require shielded wires or wires other than those listed above, or if two wires must be crimped

Pin

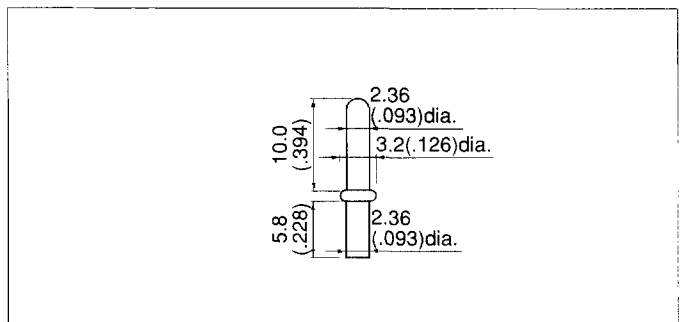

Model No.	Applicable PC board		Q'ty / box
	Thickness mm(in.)	Hole diameter mm(in.)	
RT-01N-2.3A	1.6(.063)	2.36±0.05(.093±.002 dia)	5,000

Material and Finish

Brass, Nickel-plated

Note: Hole dimensions may differ according to the kind of PC board and piercing method.

Assembly layout

