

6

5

4

3

2

1

MATERIAL AND FINISH:

Insulator: Nylon 46, UL-94V-0 Rated
Contacts: Brass, contact area plating (see chart), Tin plated on solder tails

ELECTRICAL SPECIFICATIONS:

Rated current: 1A
Insulation resistance: 5000 Mohm min. at 500 VDC
Dielectric withstanding voltage: 500 VAC for one minute

SOLDERABILITY:

Max. processing temp: 230°C for 30 - 60 sec.
or 260°C for 10 sec.

ENVIRONMENTAL:

Operating temperature: -40°C TO +105°C

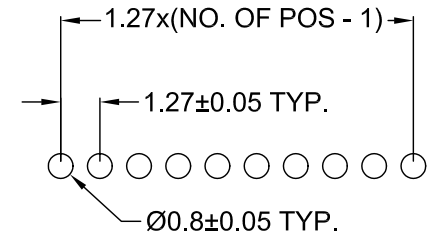
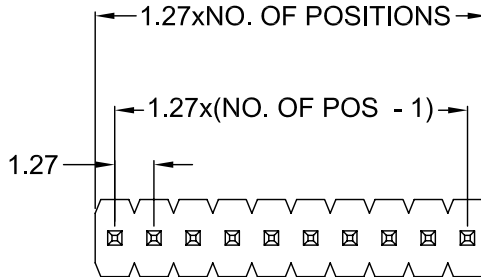

RECOMMENDED PCB LAYOUT

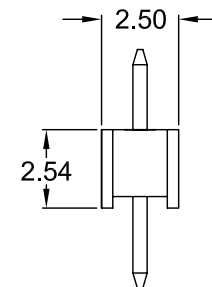
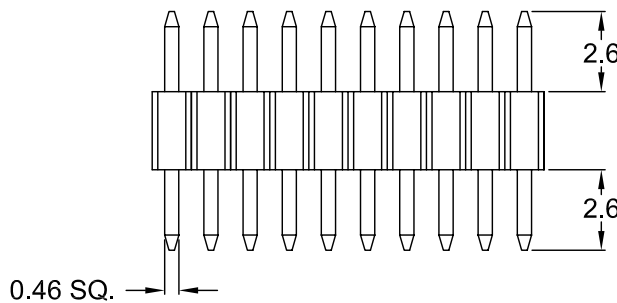

REV	DATE	CHANGE	CHNG	CHK	APPR
			10/25/04	ADD 5µ" GOLD PLATING	PB
			A		TD

P/N	PLATING
TCM-0XX-127	GOLD FLASH
TCM-0XX-T-127	TIN
TCM-0XX-1-127	5µ" OF GOLD
TCM-0XX-2-127	10µ" OF GOLD
TCM-0XX-4-127	30µ" OF GOLD

TOLERANCE UNLESS OTHERWISE SPECIFIED	
X	± 1
X.X	± 0.4
X.XX	± 0.20
DRAWN BY	PB
DATE:	8/14/02
CHECK BY	TD
DATE:	8/14/02
APPR BY	
DATE:	

Power Dynamics, Inc.
Phone: 973 560-0019 Whippany, New Jersey Fax: 973 560-0076

PART: PIN HEADER; 1.27mm PITCH; SINGLE ROW
1 TO 32 POSITIONS; 2.6mm CONTACT LENGTH

TCM-0XX-X-127

PART #: TCM-0XX-X-127

SIZE: A

SCALE: NTS

ALL DIMENSIONS FOR REFERENCE ONLY
DIMENSIONS ARE IN MILLIMETERS

SHEET 1 of 1

REV: A

6

5

4

3

2

1