

DO NOT SCALE FROM THIS PRINT

BTH-XXX-XX-X-D-XX

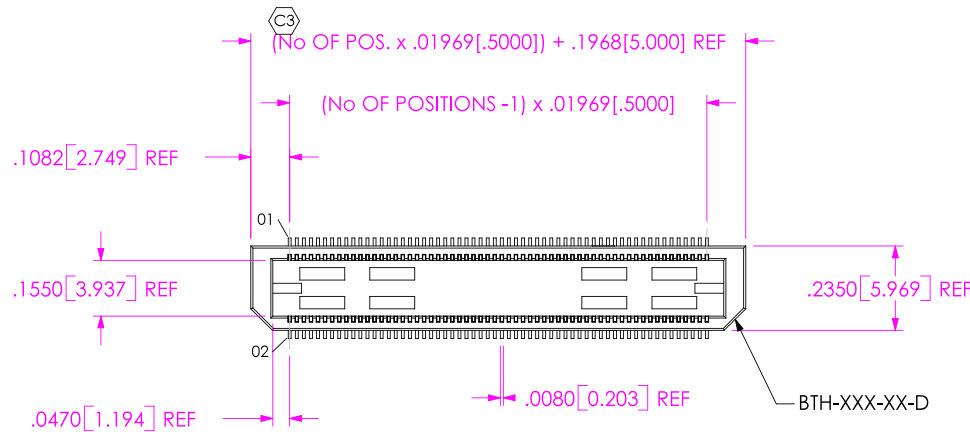

No OF POSITIONS

-030, -050, -060, -090, -120, -150 (PER ROW)

LEAD STYLE

-01: .1680[4.267]
 -02: .2861[7.264]
 -03: .4042[10.267]
 -04: .6000[15.240]
 -05: .7180[18.237]
 -06: .8360[21.234]

OPTION

- A: ALIGNMENT PINS (USE BTH-XXX-XX-D-A FOR STYLES -01 & -02) (FOR STYLES -03 THRU -06, SEE TABLE 4 & FIG. 4, SHEET 3)
- LC: LOCKING CLIPS (USE LC-08-T-01)
- K: POLYAMIDE FILM (USE K-500-300, SEE FIG. 2) (AVAILABLE ON STYLES -01 THRU -04 ONLY)
- TR: TAPE & REEL (120 POS MAX) [N/A ON -05 THRU -06]

*** = 50 POS. ONLY AVAILABLE FOR -01 LEAD STYLE (REF ASP-65267-02)

ROW SPECIFICATION
 -D: DOUBLE (USE BTH-XXX-XX-D & BTHH-XXX-XX-D)

PLATING SPECIFICATION

- F: FLASH SELECTIVE GOLD (USE T-1SXX-XX-F) (SEE NOTE 5)
- L: LIGHT SELECTIVE GOLD (USE T-1SXX-XX-L)
- H: HEAVY GOLD (USE T-1SXX-XX-H)

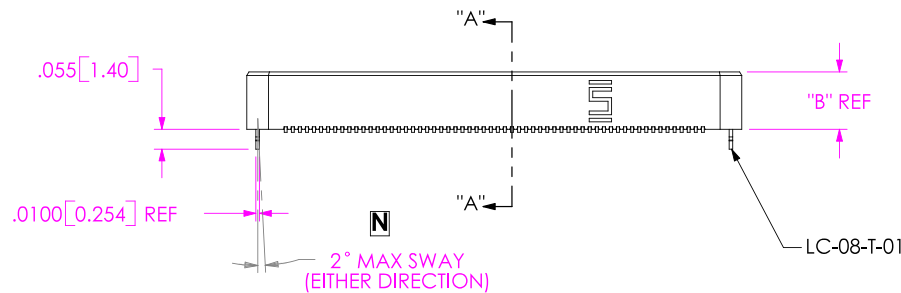

-LC: LOCKING CLIP OPTION SHOWN

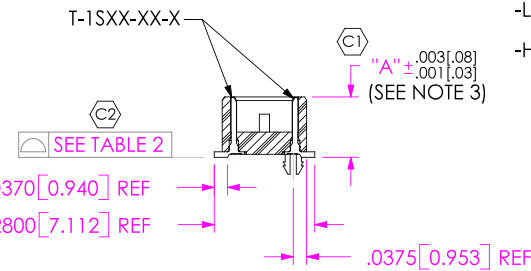

SECTION "A"-A"

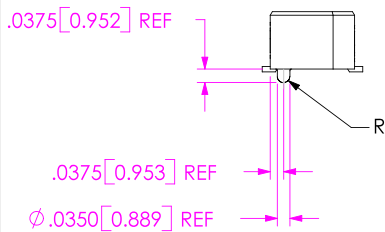

-A: ALIGNMENT PIN OPTION SHOWN

NO. OF POSITIONS	COPLANARITY
-030 THRU -090	.004[.10]
-120 THRU -150	.006[.15]

STYLE	"A"	"B"	BODY	TERMINAL	MATED HEIGHT WITH BSH
-01	.1680[4.267]	.1600[4.064]	BTH-XXX-01-D(-A)	T-1S39-01-X	.1969[5.001] REF
-02	.2861[7.267]	.2781[7.064]	BTH-XXX-02-D(-A)	T-1S59-02-X	.3150[8.001] REF

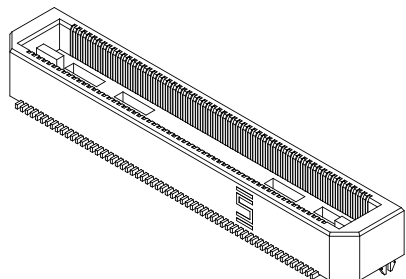

NOTES:

- ③ REPRESENTS A CRITICAL DIMENSION.
- MINIMUM PUSHOUT FORCE: 6 OZ. FOR STYLES -01 & -02
8 OZ. FOR STYLES -03 THRU -06
- MAXIMUM VARIANCE OF .002[.05].
- LEAD STYLES -03 THRU -06: TOP BODY (BTH) CANNOT HAVE -A OPTION.
- L PLATING CAN BE SUBSTITUTED FOR -F PLATING.

UNLESS OTHERWISE SPECIFIED, DIMENSIONS ARE IN INCHES.

TOLERANCES ARE:
 DECIMALS ANGLES
 .XX: $\pm .01[.3]$ 2°
 .XXX: $\pm .005[.13]$
 .XXXX: $\pm .0020[.051]$

PROPRIETARY NOTE

THIS DOCUMENT CONTAINS INFORMATION CONFIDENTIAL AND PROPRIETARY TO SAMTEC, INC. AND SHALL NOT BE REPRODUCED OR TRANSFERRED TO OTHER DOCUMENTS OR DISCLOSED TO OTHERS OR USED FOR ANY PURPOSE OTHER THAN THAT WHICH IT WAS OBTAINED WITHOUT THE EXPRESSED WRITTEN CONSENT OF SAMTEC, INC.

SAMTEC

520 PARK EAST BLVD, NEW ALBANY, IN 47150
 PHONE: 812.944.6733 FAX: 812.948.5047
 e-Mail: INFO@SAMTEC.COM CODE: 55322

MATERIAL: DO NOT SCALE DRAWING SHEET SCALE: 1.875:1 DESCRIPTION: .5mm DOUBLE ROW TERMINAL ASSEMBLY

DWG. NO. **BTH-XXX-XX-X-D-XX**

FIG. 2
 -K: POLYAMIDE FILM PAD OPTION
 [USE K-500-300]

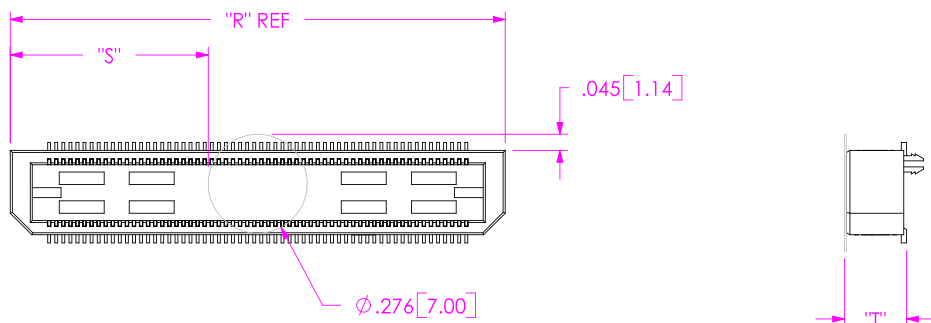

NOTE: "R" = (No OF POSITIONS x .01969 [.5000]) + .1968 [5.000]
 "S" = (("R" - .325 [8.26]) / 2) ±.020 [.51]

STYLE	"T"
-01	.173 [4.39]
-02	.291 [7.39]
-03	.409 [10.39]
-04	.605 [15.37]
-05	.723 [18.36]
-06	.841 [21.36]

N
N
N
N

PACKAGING VIEW

(PARTS TO HAVE POSITIOIN #01 LOADED IN SAME DIRECTION AS ARROW)

[STYLES -01 & -02]	[STYLES -03 & -04]	[STYLE -05]	[STYLE -06]
N			
TUBE: PT-1-24-01-78 PLUG: TP-03	TUBE: PT-1-24-01-98 PLUG: TP-26	TUBE: PT-1-24-02-105 PLUG: TP-26	TUBE: PT-1-24-01-105 PLUG: TP-26

F:\DWG\MISC\MKTG\BTH-XXX-XX-X-D-XX-MKT.SLDDRW

PROPRIETARY NOTE

THIS DOCUMENT CONTAINS INFORMATION CONFIDENTIAL AND PROPRIETARY TO SAMTEC, INC. AND SHALL NOT BE REPRODUCED OR TRANSFERRED TO OTHER DOCUMENTS OR DISCLOSED TO OTHERS OR USED FOR ANY PURPOSE OTHER THAN THAT WHICH IT WAS OBTAINED WITHOUT THE EXPRESSED WRITTEN CONSENT OF SAMTEC, INC.

DO NOT SCALE DRAWING

SHEET SCALE: 1.875:1

SAMTEC

520 PARK EAST BLVD, NEW ALBANY, IN 47150
 PHONE: 812.944.6733 FAX: 812.948.5047
 e-Mail: INFO@SAMTEC.COM CODE: 55322

DESCRIPTION:
 .5mm DOUBLE ROW TERMINAL ASSEMBLY

DWG. NO. **BTH-XXX-XX-X-D-XX**

BY: DEAN P 5/28/1999 SHEET 2 OF 3

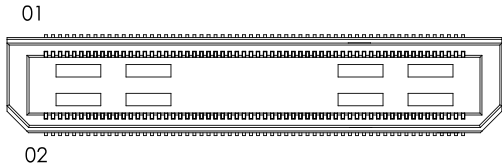

TABLE 4								MATED HEIGHT WITH BSH-01
STYLE	SEE FIGURE	"C" OVERALL HEIGHT	TERMINAL	TOP BODY (SEE NOTE 6)	BOTTOM SPACER BODY (-LC OR NONE)	BOTTOM SPACER BODY (-A)		
-03	3	.4042 [10.267]	T-1S60-03-X	BTH-XXX-02-D	BTHH-XXX-01-D	BTHH-XXX-01-D-A	.433 [11.00]	REF
-04	3	.6000 [15.240]	T-1S60-04-X	BTH-XXX-02-D	BTHH-XXX-01-D	BTHH-XXX-01-D-A	.630 [16.00]	REF
-05	4	.7180 [18.237]	T-1S60-05-X	BTH-XXX-02-D	BTHH-XXX-03-D	BTHH-XXX-03-D-A	.748 [19.00]	REF
-06	4	.8360 [21.234]	T-1S60-06-X	BTH-XXX-02-D	BTHH-XXX-03-D	BTHH-XXX-03-D-A	.866 [22.00]	REF

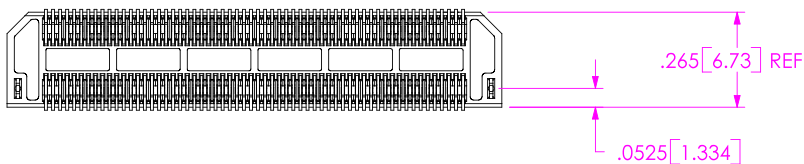
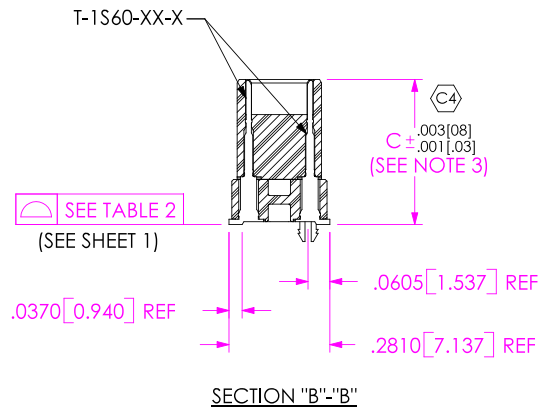
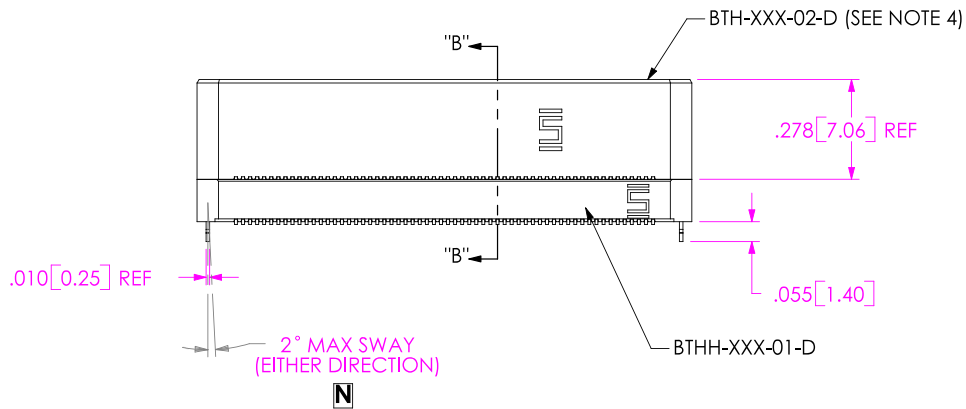

FIG. 3
BTH-060-03-X-D-LC SHOWN (STYLES -03 & -04)
(DIFFERENT AS SHOWN, OTHERWISE SAME AS FIG. 1)

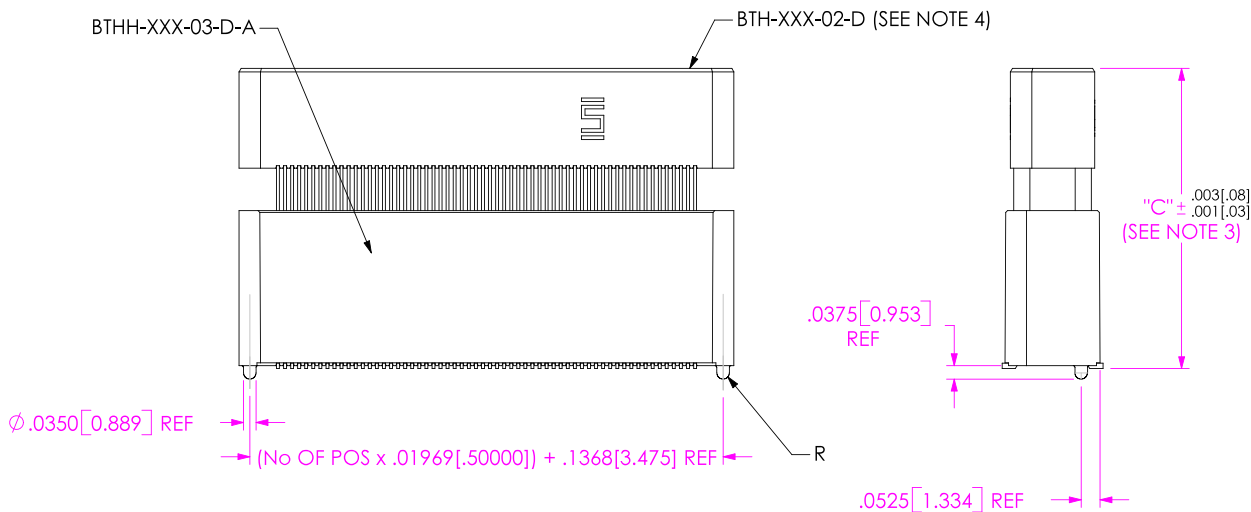

FIG. 4
-A: ALIGNMENT PIN OPTION
BTH-060-06-X-D-A SHOWN (STYLES -05 & -06)
(DIFFERENT AS SHOWN, OTHERWISE SAME AS FIG. 1)

F:\DWG\MISC\MKTG\BTH-XXX-XX-X-D-XX-MKT.SLDDRW

PROPRIETARY NOTE
THIS DOCUMENT CONTAINS INFORMATION CONFIDENTIAL AND PROPRIETARY TO SAMTEC, INC. AND SHALL NOT BE REPRODUCED OR TRANSFERRED TO OTHER DOCUMENTS OR DISCLOSED TO OTHERS OR USED FOR ANY PURPOSE OTHER THAN THAT WHICH IT WAS OBTAINED WITHOUT THE EXPRESSED WRITTEN CONSENT OF SAMTEC, INC.

DO NOT SCALE DRAWING

SHEET SCALE: 1.875:1

SAMTEC

520 PARK EAST BLVD, NEW ALBANY, IN 47150
PHONE: 812.944.6733 FAX: 812.948.5047
e-Mail: INFO@SAMTEC.COM CODE: 55322

DESCRIPTION:
.5mm DOUBLE ROW TERMINAL ASSEMBLY

DWG. NO. **BTH-XXX-XX-X-D-XX**

BY: DEAN P 5/28/1999 SHEET 3 OF 3