

4 Male Connectors with CAGE CLAMP®, 100% Protected against Mismatching, Pin Spacing 7.5 mm / 0.295 in, Light Grey

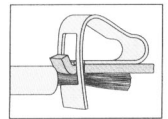

<p>Pin spacing 7.5 mm/0.295 in, light grey 0.08 – 2.5 mm² AWG 28 – 12 400 V/6 kV/3 300 V, 15 A 12 A 300 V, 15 A </p> <p> 8 – 9 mm / 0.33 in</p> <p>* </p>	<p>Pin spacing 7.5 mm/0.295 in, light grey 0.08 – 2.5 mm² AWG 28 – 12 400 V/6 kV/3 300 V, 15 A 12 A 300 V, 15 A </p> <p> 8 – 9 mm / 0.33 in</p> <p>* </p>	<p>Pin spacing 7.5 mm/0.295 in, light grey 0.08 – 2.5 mm² AWG 28 – 12 400 V/6 kV/3 300 V, 15 A 12 A 300 V, 15 A </p> <p> 8 – 9 mm / 0.33 in</p> <p>* </p>
--	--	--

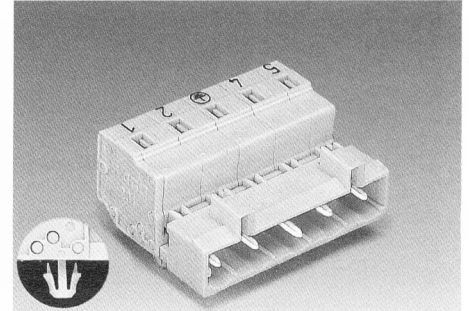
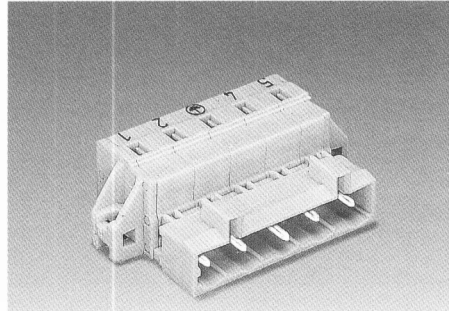
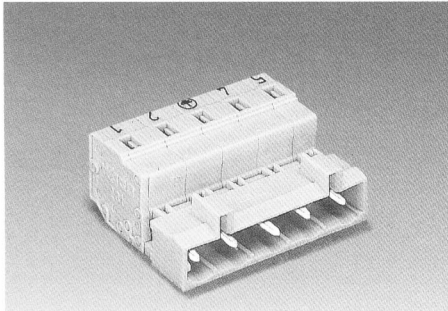

No. of poles	Item-No.	Item-No.	No. of poles	Item-No.	Item-No.	No. of poles	Item-No.	Item-No.
Male connectors with CAGE CLAMP®, 100% protected against mismatching, light grey			Male connectors with CAGE CLAMP® and fixing flanges, 100% protected against mismatching, light grey, for screw fixing or similar methods, for vertical and horizontal fixing			Male connectors with CAGE CLAMP® and snap-in mounting feet, 100% protected against mismatching, light grey, for plate thickness 0.6 mm – 1.2 mm, fixing hole Ø 3.5 mm, w. mount. adapter 209-137 for DIN 35 rail		
	without	with		without	with		without	with
	preceding ground (earth) contact			preceding ground (earth) contact			preceding ground (earth) contact	
2	723-602		2	723-602/019-000		2	723-602/018-000	
3	723-603	723-603/000-042	3	723-603/019-000	723-603/019-042	3	723-603/018-000	723-603/018-042
4	723-604	723-604/000-042	4	723-604/019-000	723-604/019-042	4	723-604/018-000	723-604/018-042
5	723-605	723-605/000-042	5	723-605/019-000	723-605/019-042	5	723-605/018-000	723-605/018-042
6	723-606		6	723-606/019-000		6	723-606/018-000	
:	:		:	:		:	:	
11	723-611		11	723-611/019-000		11	723-611/018-000	
12	723-612		12	723-612/019-000		12	723-612/018-000	
<p> 3- to 5-pole male connectors with preceding ground (earth) contact are marked with a special printing, for ex. marking 5-pole: 5 - 4 - - 2 - 1</p>			<p> 3- to 5-pole male connectors with preceding ground (earth) contact are marked with a special printing, for ex. marking 5-pole: 5 - 4 - - 2 - 1</p>			<p> 3- to 5-pole male connectors with preceding ground (earth) contact are marked with a special printing, for ex. marking 5-pole: 5 - 4 - - 2 - 1</p>		

Accessories (please refer to remarks concerning coding on page 4.83)

	Coding key , snap-on type, light grey 231-130		Coding key , snap-on type, light grey 231-130		Coding key , snap-on type, light grey 231-130
	Insulation stop , 5 pcs/strip 0.08 - 0.2 mm ² (white) 231-673 0.25 - 0.5 mm ² (light gr.) 231-674 0.75 - 1 mm ² (dark grey) 231-675		Insulation stop , 5 pcs/strip 0.08 - 0.2 mm ² (white) 231-673 0.25 - 0.5 mm ² (light gr.) 231-674 0.75 - 1 mm ² (dark grey) 231-675		Insulation stop , 5 pcs/strip 0.08 - 0.2 mm ² (white) 231-673 0.25 - 0.5 mm ² (light gr.) 231-674 0.75 - 1 mm ² (dark grey) 231-675
	0.2 mm ² solid / 0.14 mm ² f-st Marker strips , self-adhesive 1-16 (20x) 249-150/210-222	0.2 mm ² solid / 0.14 mm ² f-st Marker strips , self-adhesive 1-16 (20x) 249-150/210-222	0.2 mm ² solid / 0.14 mm ² f-st Marker strips , self-adhesive 1-16 (20x) 249-150/210-222		Tapping screw , B 2.2 x 9.5 209-147 fixing hole Ø 1.8 mm
					Mounting adapter , for DIN 35 rail, grey 209-137
					Marker strips , self-adhesive 1-16 (20x) 249-150/210-222

Dimensions (in mm) **A** = (No. of poles - 1) x pin sp. + 5 mm + 3.2 mm **B** = A - 1.7 mm **C** = A - 1.2 mm **D** = A - 0.2 mm **E** = D + 5.8 mm **F** = D + 11.8 mm

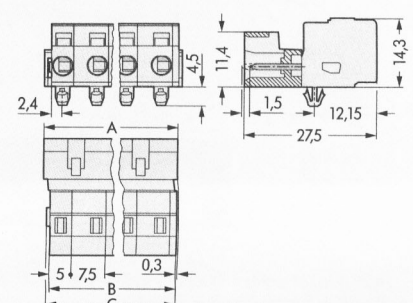
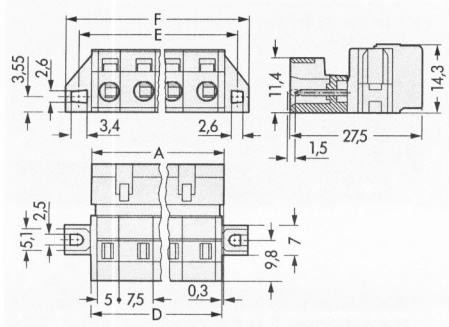
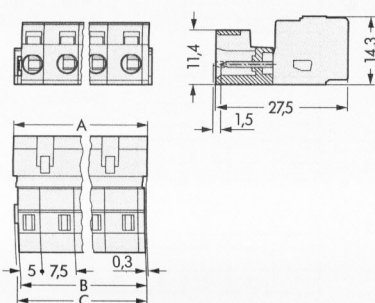

* For further approvals with corresponding ratings see pages 10.3 ff.