



Features:

- Approved to IEC/EN60950, UL60950 Safety Standards
- Wide Input Voltage: 36VDC - 75VDC
- Dual Outputs: ± 5 VDC, ± 12 VDC, ± 15 VDC
- Remote Control
- No Minimum Load Requirement



Model	QPDD10-48D05	QPDD10-48D12	QPDD10-48D15
Output Characteristics			
DC Output	± 5 V	± 12 V	± 15 V
Rated Current	1A	0.42A	0.33A
Current Range	0~1A	0~0.42A	0~0.33A
Efficiency (Typical)	81%	83%	84%
Ripple and Noise (max)	50mVpp		
Voltage Accuracy	$\pm 1.0\%$		
Line Regulation (max)	0.2%		
Load Regulation (max)	0.5%		
Temperature Coefficient	$\pm 0.02\%/^{\circ}\text{C}$		
Input Characteristics			
Voltage Range	36VDC~75VDC		
Normal Voltage	48VDC		
Remote Control			
Control	Positive Logic	HIGH=ON (3.5VDC to 10VDC); LOW=OFF (-0.7VDC to 0.8VDC)	
Voltage	Negative Logic	LOW=ON (-0.7VDC to 0.8VDC); HIGH=OFF (3.5VDC to 10VDC)	
Control	Positive Logic	2mA max.	
Current	Negative Logic	4mA max.	
Protection			
Over Current	Continuous, auto recovery (± 5 V)		
Environmental Characteristics			
Operating Amb. Temp.	$-40^{\circ}\text{C} \sim 55^{\circ}\text{C}$		
Operating Case Temp.	$-40^{\circ}\text{C} \sim 100^{\circ}\text{C}$		
Storage Temp.	$-55^{\circ}\text{C} \sim 125^{\circ}\text{C}$		
Safety Standards	IEC/EN60950, UL60950		
Isolation Voltage (one minute)	Input-Output: 1500VDC. Input-Case: 1500VDC. Output-Case: 1500VDC		
General Characteristics			
MTBF	More than 2,000,000Hrs		
Dimension (LxWxH)	50.8x25.4x10.16mm (2"x1"x0.4")		

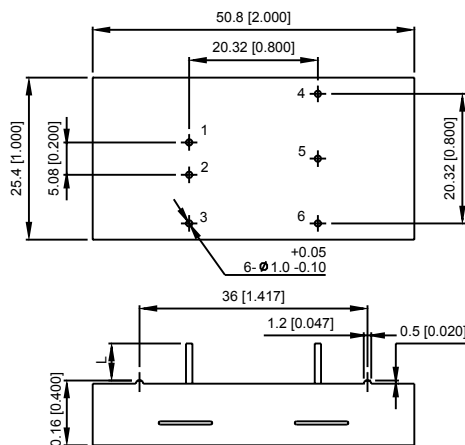

Unit: mm[inch]

Pin Assignment

Pin No.	Output
1	+Vin
2	-Vin
3	CNT
4	+Vout
5	COM
6	-Vout

Pin Length: 3.8mm

TOLERANCES: X.Xmm = ± 0.5 mm

X.XXmm = ± 0.25 mm