

(1.3) ± .05 CENTERLINE OF PIN IN AREA SHOWN NOT TO VARY FROM CENTERLINE OF PIN AT DATUM -D- BY MORE THAN .008 IN ANY DIRECTION

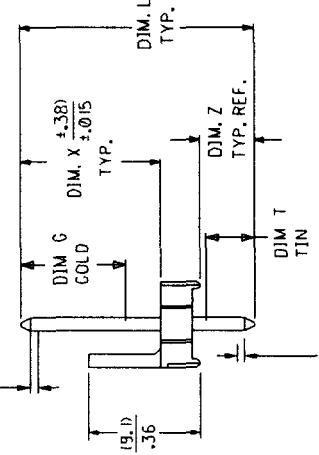

(1.3) ± .05 CENTERLINE OF PIN IN AREA SHOWN NOT TO VARY FROM CENTERLINE OF PIN AT DATUM -D- BY MORE THAN .005 IN ANY DIRECTION

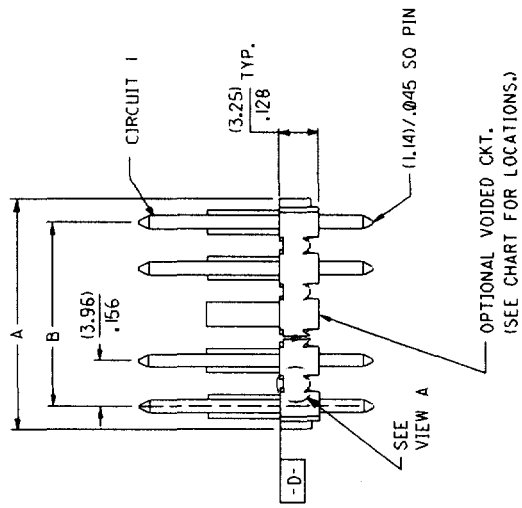

OPTIONAL VOIDED CKT. (SEE CHART FOR LOCATIONS.)

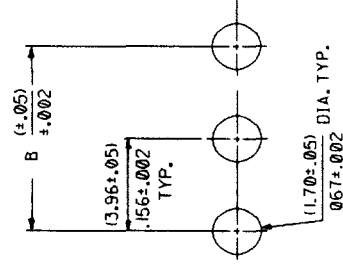

PCB LAYOUT: COMPONENT SIDE
RECOMMENDED PCB THICKNESS:
(1.57 ± .18) / .062 ± .007

NOTES:

2. SOLDERABILITY: WHEN PARTS ARE SOLDERED AT A TEMPERATURE OF (230°C) OR 446°F FOR 5 SECONDS EACH SOLDERED SURFACE SHALL BE A MINIMUM OF 95% COVERED WITH A SMOOTH CONTINUOUS ADHERENT COATING. FOR OTHER INFORMATION SEE SMES-152
 3. PIN PUSH OUT FORCE: PRIOR TO SOLDERING, A 3 LB MINIMUM FORCE (IN EITHER DIRECTION) SHALL BE REQUIRED TO PUSH THE PIN OUT OF THE HEADER.
 4. MATERIAL: HEADER GLASS FILLED POLYESTER, 94V-0, MOLDED BLACK
 5. THIS PART CONFORMS TO PRODUCT SPEC PS-08-50
 6. PARTS ARE STACKABLE END TO END ON .156 CENTERS. (SPACING TABS MUST BE REMOVED ON CIRCUIT SIZES 1 THROUGH 23 BEFORE PARTS ARE STACKABLE.)
- PLATINGS: PIN MATERIAL: BRASS FOR ADDITIONAL INFORMATION SEE SDES-88.

- (102) TIN .000200 MIN. OVER COPPER.
- (567) SELECT GOLD 15 M.I. MIN
- SELECT TIN/LEAD 100 M.I. MIN
- NICKEL OVERALL
- (569) SELECT GOLD 30 M.I. MIN
- SELECT TIN/LEAD 100 M.I. MIN
- NICKEL OVERALL

A - 41681 - * N * - *
PACKAGING AND OPTIONS
NO. OF CKTS
PIN DIMENSIONS
VOID LOCATIONS
BLANK=NO VOIDS
NO.-CKT. NO. VOIDED
MULT. VOIDS START WITH 51
PLATING

B	A	CIRCUIT
(3.96)	(6.78 / 7.87)	2
.156	(-267 / -310)	
(7.92)	(10.74 / 11.84)	3
.312	.423 / .466	
(11.89)	(14.71 / 15.80)	4
.468	.579 / .622	
(15.85)	(18.67 / 19.76)	5
.624	.735 / .778	
(19.81)	(22.63 / 23.72)	6
.780	.891 / .934	
(23.77)	(26.59 / 27.69)	7
.936	1.047 / 1.090	
(27.74)	(30.56 / 31.65)	8
1.092	1.203 / 1.246	
(31.70)	(34.52 / 35.61)	9
1.248	1.359 / 1.402	
(35.66)	(38.48 / 39.57)	10
1.404	1.515 / 1.558	
(39.62)	(42.44 / 43.54)	11
1.560	1.671 / 1.714	
(43.59)	(46.41 / 47.50)	12
1.716	1.827 / 1.870	
(47.55)	(50.37 / 51.46)	13
1.872	1.983 / 2.026	
(51.51)	(54.33 / 55.42)	14
2.028	2.139 / 2.182	
(55.47)	(58.29 / 59.39)	15
2.184	2.295 / 2.338	
(59.44)	(62.26 / 63.35)	16
2.340	2.451 / 2.494	
(63.40)	(66.22 / 67.31)	17
2.496	2.607 / 2.650	
(67.36)	(70.18 / 71.27)	18
2.652	2.763 / 2.806	
(71.32)	(74.14 / 75.23)	19
2.808	2.919 / 2.962	
(75.29)	(78.11 / 79.20)	20
2.964	3.075 / 3.118	
(79.25)	(82.07 / 83.16)	21
3.120	3.231 / 3.274	
(83.21)	(86.03 / 87.12)	22
3.276	3.387 / 3.430	
(87.17)	(89.94 / 91.03)	23
3.432	3.541 / 3.586	
(91.14)	(93.85 / 95.00)	24
3.588	3.695 / 3.740	

DATE	BY	REVISIONS
10/20/00	JKK	1
		2
		3
		4
		5
		6
		7
		8
		9
		10
		11
		12
		13
		14
		15
		16
		17
		18
		19
		20
		21
		22
		23
		24

MOLLEX 1937

ENG. NUMBERS	PIN NUMBER	PLT	DIM L	DIM X	DIM G GOLD	DIM Z	DIM T T/JN	PACKAGING	COLUMN NO. 6			COLUMN NO. 6			COLUMN NO. 6		
									EDP NO.	ENG. NO.	VOIDS	EDP NO.	ENG. NO.	VOIDS	EDP NO.	ENG. NO.	VOIDS
A-41681-ANC102**	2161-561(02)	102	(17.86) .703	(11.43) .450	N/A	(3.18) .125	OVERALL	41679-A1	26-48-7028	-A2C503		41681-0047	-A2B102				
A-41681-ANC503**	2161-561(503)	503	(17.86) .703	(11.43) .450	OVERALL	(3.18) .125	N/A	41679-A1	26-48-7038	-A3C503		41681-0048	-A3B102				
A-41681-ANA501**	2161-11501	501	(19.05) .750	(11.43) .450	OVERALL	(4.37) .172	N/A	41679-A1	26-48-7048	-A4C503		41681-0049	-A4B102				
A-41681-ANB102**	2161-11(02)	102	(19.05) .750	(12.62) .497	N/A	(3.18) .125	OVERALL	41679-A1	26-48-7058	-A5C503		41681-0050	-A5B102				
									26-48-7068	-A6C503		41681-0051	-A6B102				
									26-48-7078	-A7C503		41681-0052	-A7B102				
									26-48-7088	-A8C503		41681-0053	-A8B102				
									26-48-7098	-A9C503		41681-0054	-A9B102				
									26-48-7108	-A10C503		41681-0055	-A10B102				
									26-48-7118	-A11C503		41681-0056	-A11B102				
									26-48-7128	-A12C503		41681-0057	-A12B102				
									26-48-7138	-A13C503		41681-0058	-A13B102				
									26-48-7148	-A14C503		41681-0059	-A14B102				
									26-48-7158	-A15C503		41681-0060	-A15B102				
									26-48-7168	-A16C503		41681-0061	-A16B102				
									26-48-7178	-A17C503		41681-0062	-A17B102				
									26-48-7188	-A18C503		41681-0063	-A18B102				
									26-48-7198	-A19C503		41681-0064	-A19B102				
									26-48-7208	-A20C503		41681-0065	-A20B102				
									26-48-7218	-A21C503		41681-0066	-A21B102				
									26-48-7228	-A22C503		41681-0067	-A22B102				
									26-48-7238	-A23C503		41681-0068	-A23B102				
									26-48-7248	-A24C503		26-48-6248	-A24B102				

REVISIONS

NO.	DESCRIPTION	DATE	BY
M2	SEE SHEET I		
M1	SEE SHEET I		
K3	SEE SHEET I		
K2	SEE SHEET I		
K1	SEE SHEET I		
K	SEE SHEET I		
G	SEE SHEET I		
LTR	REVISIONS		

SEE CHART

DATE: 10/20/00

BY: SDA-41681

REVISIONS

NO.	DESCRIPTION	DATE	BY
M2	SEE SHEET I		
M1	SEE SHEET I		
K3	SEE SHEET I		
K2	SEE SHEET I		
K1	SEE SHEET I		
K	SEE SHEET I		
G	SEE SHEET I		
LTR	REVISIONS		

SEE CHART

DATE: 10/20/00

BY: SDA-41681

REVISIONS

NO.	DESCRIPTION	DATE	BY
M2	SEE SHEET I		
M1	SEE SHEET I		
K3	SEE SHEET I		
K2	SEE SHEET I		
K1	SEE SHEET I		
K	SEE SHEET I		
G	SEE SHEET I		
LTR	REVISIONS		

SEE CHART

DATE: 10/20/00

BY: SDA-41681

REVISIONS

NO.	DESCRIPTION	DATE	BY
M2	SEE SHEET I		
M1	SEE SHEET I		
K3	SEE SHEET I		
K2	SEE SHEET I		
K1	SEE SHEET I		
K	SEE SHEET I		
G	SEE SHEET I		
LTR	REVISIONS		

SEE CHART

DATE: 10/20/00

BY: SDA-41681

REVISIONS

NO.	DESCRIPTION	DATE	BY
M2	SEE SHEET I		
M1	SEE SHEET I		
K3	SEE SHEET I		
K2	SEE SHEET I		
K1	SEE SHEET I		
K	SEE SHEET I		
G	SEE SHEET I		
LTR	REVISIONS		

SEE CHART

DATE: 10/20/00

BY: SDA-41681

REVISIONS

NO.	DESCRIPTION	DATE	BY
M2	SEE SHEET I		
M1	SEE SHEET I		
K3	SEE SHEET I		
K2	SEE SHEET I		
K1	SEE SHEET I		
K	SEE SHEET I		
G	SEE SHEET I		
LTR	REVISIONS		

SEE CHART

DATE: 10/20/00

BY: SDA-41681