

## VRLA Rechargeable Battery

# BP4-12 (BP4-12FR)



### FEATURES

- Maintenance free(no water topping-up required).
- No free acid(Non-spillable battery).
- Low self-discharge rate, lower than 3% capacity loss per month.
- Can be used in any orientation(excluding used inverted).

### APPLICATION

- UPS
- Toy-Cars
- Fans
- Electronic Doorbells



### SPECIFICATIONS

Nominal Voltage	12 V
Nominal Capacity	4.0Ah @ 20 hour rate F.V.(1.75V/cell)
Approx. Weight	1670g(3.68lbs.)
Terminals	T1 (Faston Tab 187) T2 is optional
Internal Resistance	≤45m Ω (Fully Charged )
Max. Discharge Current	60 A (5 sec.)
Max. Charge Current	1.2 A
Operating Temperature Range	Charge : 0°C~40°C(32°F~104°F) Discharge : -20°C~50°C(-4°F~122°F) Storage. : -20°C~40°C(-4°F~104°F)
Container Material	ABS(UL94-HB, UL94-V0 is optional)

ISO 9001	
ISO14001	
UL	 MH19884
CE	 C4M20310-2474-E-16
<ul style="list-style-type: none"> <li>● IEC61056</li> <li>● JIS C 8702</li> <li>● GB/T 19639</li> </ul>	

### DIMENSION(mm/inch)

### OUTER DIMENSIONS

### TERMINAL TYPE

#### Length

90±1.5 (3.54±0.06)

#### Width

70±1.5 (2.76±0.06)

#### Container Height

102±1.5 (4.02±0.06)

#### Total Height

106±2.0 (4.17±0.08)

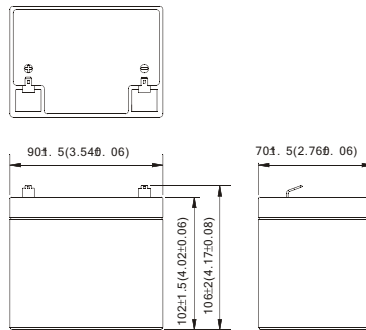

#### Terminal T1

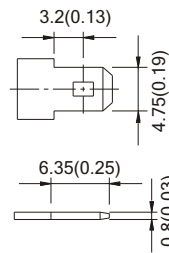

#### Terminal T2

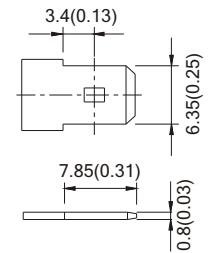

### Constant power discharge characteristics at 25 °C/77 °F

Unit: W

Discharge Time F.V. (V/cell)	5 Min	10 Min	15 Min	30 Min	1 Hr	3 Hr	5 Hr	10 Hr	20 Hr
1.80V	144.6	106.5	85.3	50.76	29.11	11.66	8.039	4.493	2.364
1.75V	167.4	115.3	89.2	52.69	29.99	11.89	8.160	4.560	2.400
1.70V	177.9	119.5	92.0	53.90	30.52	12.00	8.205	4.583	2.412
1.65V	185.8	122.4	94.1	54.65	30.89	12.08	8.233	4.596	2.424
1.60V	192.0	124.8	96.0	55.20	31.20	12.16	8.258	4.596	2.424

### Constant current discharge characteristics at 25 °C/77 °F

Unit: A

Discharge Time F.V. (V/cell)	5 Min	10 Min	15 Min	30 Min	1 Hr	3 Hr	5 Hr	10 Hr	20 Hr
1.80V	13.03	9.37	7.42	4.30	2.446	0.972	0.670	0.374	0.197
1.75V	15.36	10.15	7.76	4.47	2.520	0.991	0.680	0.380	0.200
1.70V	16.32	10.52	8.00	4.57	2.565	1.000	0.684	0.382	0.201
1.65V	17.05	10.77	8.18	4.63	2.596	1.007	0.686	0.383	0.202
1.60V	17.61	10.99	8.35	4.68	2.622	1.013	0.688	0.383	0.202

All data shall be changed without prior notice, BB reserves the right to explain and update the information contained hereinto.