

MATERIAL NUMBER	ENGINEERING NUMBER	FITS MALE TAB SIZE	"A" MAX.	"C" MAX.	"E" MAX.	CARRIER CONFIGURATION
190030126	AA-2202V	.187X.020	.78/19.8	.316/8.03	.160/4.06	LOOSE PIECE
190030127	AA-2202VT	.187X.020	.78/19.8	.316/8.03	.160/4.06	TAPE MOUNT
190030128	AA-2202VC	.187X.020	.78/19.8	.316/8.03	.160/4.06	PLASTIC STRIP
190030129	AA-2203V	.187X.032	.78/19.8	.316/8.03	.160/4.06	LOOSE PIECE
190030130	AA-2203VT	.187X.032	.78/19.8	.316/8.03	.160/4.06	TAPE MOUNT
190030131	AA-2203VC	.187X.032	.78/19.8	.316/8.03	.160/4.06	PLASTIC STRIP
190030005	AA-220IVN	.250X.032	.86/21.8	.380/9.65	.180/4.57	LOOSE PIECE
190030007	AA-220IVNT	.250X.032	.86/21.8	.380/9.65	.180/4.57	TAPE MOUNT
190030111	AA-220IVNC	.250X.032	.86/21.8	.380/9.65	.180/4.57	PLASTIC STRIP

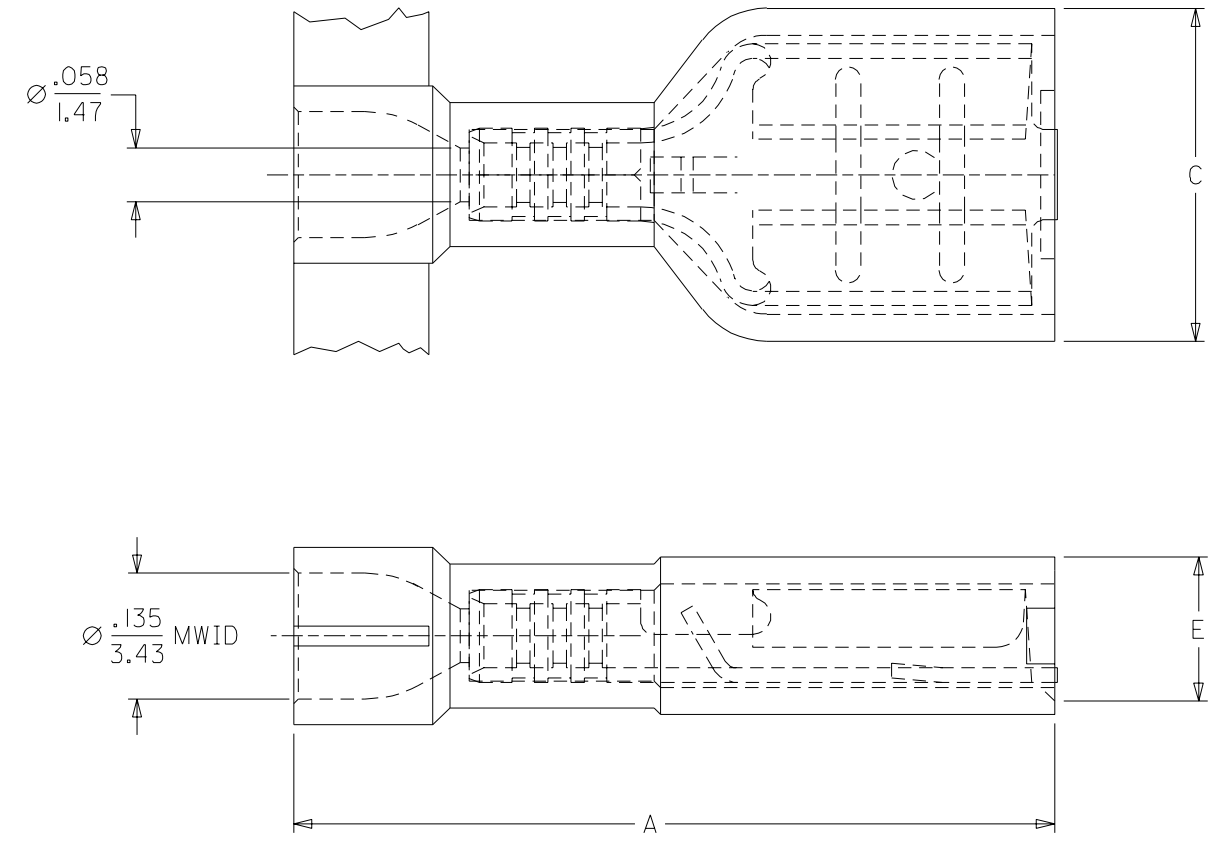

- NOTES:
- ① MATERIAL: TERMINAL: BRASS .016/0.41.  
PLATING: ELECTRO-TIN  
INSULATION: NYLON 6/6 94V-0 RATING  
COLOR: RED
  - MWID = MAXIMUM WIRE INSULATION DIAMETER.
  - ALL DIMENSIONS = INCHES/MM

SALES DRAWING

REV'D NYLON COLOR EC NO. ETC2004-0101 DRWN: BRE 03/11/21 CHK: HEB 03/11/21 APPR: RWD 03/11/21	QUALITY SYMBOLS MAJOR $\blacktriangledown = 0$ CRITICAL $\blacktriangle = 0$	GENERAL TOLERANCES: (UNLESS SPECIFIED)		SCALE NO: NE	DESIGN UNITS <input type="checkbox"/> mm <input checked="" type="checkbox"/> INCH	THIRD ANGLE PROJECTION	DIMENSIONS: <input type="checkbox"/> mm <input checked="" type="checkbox"/> INCH <input type="checkbox"/> mm ONLY	SHT REV
		4 PLACES $\pm 0.---$ $\pm .---$	DRAWN BY & DATE HEB 01/06/07	TITLE: FIQD FEMALE, INSULKRIMP 94V-0 MATERIAL 22-18 AWG				
		3 PLACES $\pm 0.---$ $\pm .005$	CHECKED BY & DATE RWD 01/06/07	MOLEX INCORPORATED				
		2 PLACES $\pm 0.13$ $\pm .01$	APPROVED BY & DATE RWD 01/06/07	CAD FILENAME S19003001.DGN	MATERIAL NO. SEE TABLE	DRAWING NO. SD-19003-001	SHEET NO. 1 OF 1	
1 PLACE $\pm 0.25$ $\pm .---$	ANGULAR: $\pm 1/2^\circ$	THIS DRAWING CONTAINS INFORMATION THAT IS PROPRIETARY TO MOLEX INCORPORATED AND SHOULD NOT BE USED WITHOUT WRITTEN PERMISSION.						
DRAFT WHERE APPLICABLE MUST REMAIN WITHIN DIMENSIONS	REV	SIZE B						