

# LSF856C1

# Infrared Emitting Diode

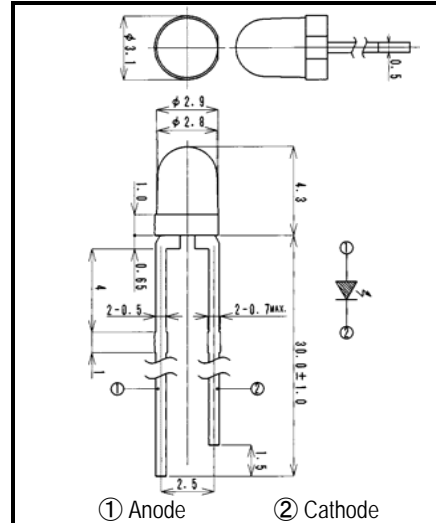
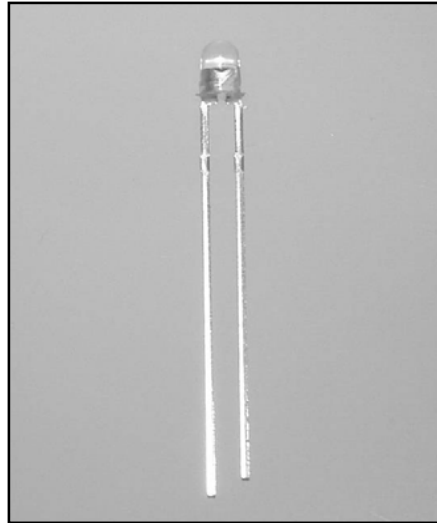

- FEATURES**
- High-output Power
  - Compact
  - High Reliability
- APPLICATIONS**
- Optical Switches
  - Optical Sensors

## 2.ELECTRICAL & OPTICAL CHARACTERISTICS (Ta=25°C)

| ITEM                      | SYMBOL | CONDITIONS | MIN | TYP  | MAX | UNIT |
|---------------------------|--------|------------|-----|------|-----|------|
| Power Output              | PO     | IF=20mA    | 7.0 | 10.0 |     | mW   |
| Forward Voltage           | VF     | IF=20mA    |     | 1.4  | 1.7 | V    |
| Reverse Current           | IR     | VR=5V      |     |      | 100 | μA   |
| Peak Wavelength           | λp     | IF=20mA    |     | 850  |     | nm   |
| Spectral Line Half Width  | Δλ     | IF=20mA    |     | 45   |     | nm   |
| Half Intensity Beam Angle | θ      | IF=20mA    |     | ±25  |     | deg. |

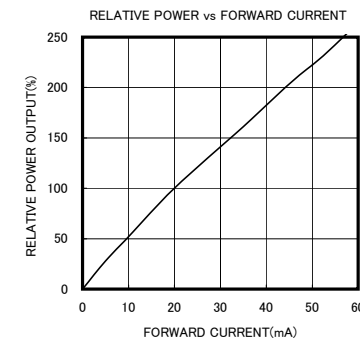
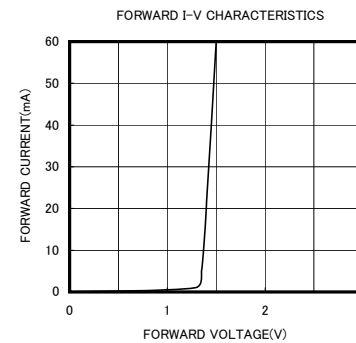

## 1. ABSOLUTE MAXIMUM RATINGS (Ta=25°C)

| ITEM                      | SYMBOL | RATINGS    | UNIT |
|---------------------------|--------|------------|------|
| Forward Current (DC)      | IF     | 60         | mA   |
| Forward Current (Pulse)*1 | IFP    | 0.5        | A    |
| Reverse Voltage           | VR     | 5          | V    |
| Power Dissipation         | PD     | 100        | mW   |
| Operating Temp.           | ToPr   | -20 TO 85  | °C   |
| Storage Temp.             | Tstg   | -30 TO 100 | °C   |
| Junction Temp.            | Tj     | 100        | °C   |
| Lead Soldering Temp.*2    | Tls    | 260        | °C   |

\*1:Tw=10uS,T=10mS

\*2:Time 5 Sec max,Position:Up to 3mm from the body

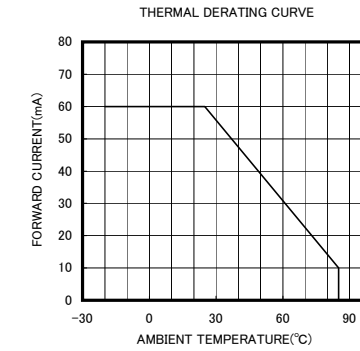
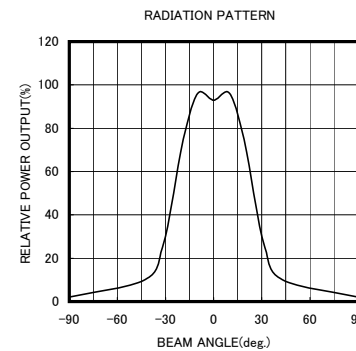
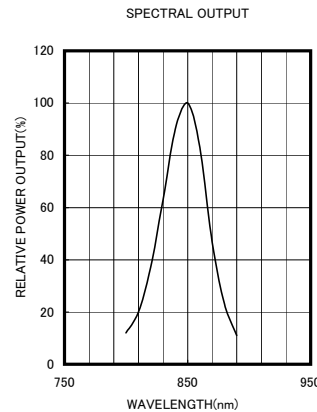

To purchase this part contact  
Marktech Optoelectronics at

**800.984.5337**

**Marktech**  
Optoelectronics  
www.marktechopto.com

