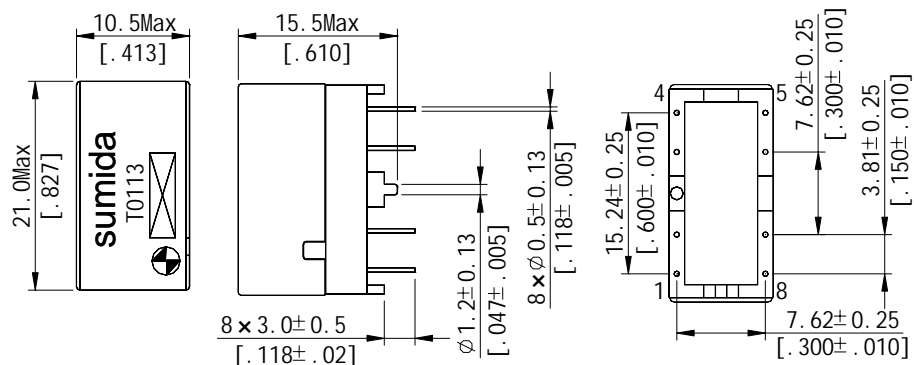
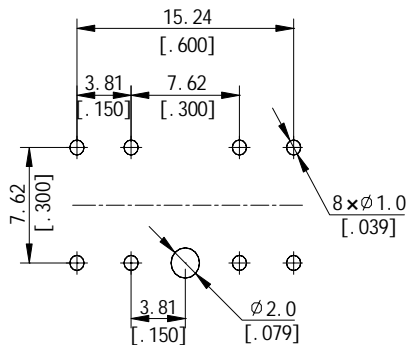
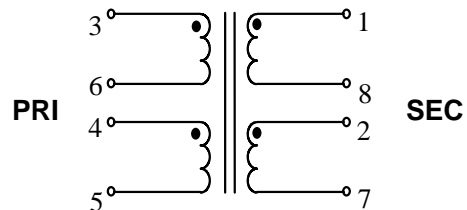

Type: BM2015
Product Description

- 21.0 × 10.5mm Max.(L × W), 15.5mm Max. Height.
- Operating frequency: 4 ~ 21MHz.

Feature

- HomePlug shielded line isolation transformer with a metal cap glued on the top.
- Ideally for powerline networking applications in set-top box and other CPE data networking devices.
- RoHS Compliance.

Dimensions(mm)

Land Pattern (mm)

Schematics(Bottom)

Specification(Part Number:T0113)

Characteristics	Specifications	Measuring conditions
Inductance (Ls) (1-8)	160 μ H Min	100kHz, 0.1V,
Inductance (Ls) (4-5)	2.8 μ H Min	100kHz, 0.1V,
Turns ratio (T/R) (1-8): (2-7)	6 : 1 (\pm 5%)	10kHz, 0.1V
Turns ratio (T/R) (1-8): (3-6)	6 : 1 (\pm 5%)	10kHz, 0.1V
Turns ratio (T/R) (1-8): (4-5)	6 : 1 (\pm 5%)	10kHz, 0.1V
D.C.R. (1-8)	70m Max	at 25
D.C.R. (2-7)	19m Max	at 25
D.C.R. (3-6)	19m Max	at 25
D.C.R. (4-5)	19m Max	at 25