

FW series Miniature Sized, For Audio Equipment



Specifications

Item	Performance Characteristics																												
Category Temperature Range	—40~+85°C																												
Rated Voltage Range	6.3~100V																												
Rated Capacitance Range	0.1~33000μF																												
Capacitance Tolerance	±20% at 120Hz, 20°C																												
Leakage Current	After 1 minute's application of rated voltage, leakage current is not more than 0.03 CV or 4 (μA) ,whichever is greater. After 2 minutes' application of rated voltage, leakage current is not more than 0.01 CV or 3 (μA) ,whichever is greater.																												
tan δ	For capacitance of more than 1000μF, add 0.02 for every increase of 1000μF. Measurement frequency : 120Hz, Temperature : 20°C																												
	<table border="1"> <tr> <td>Rated voltage(V)</td> <td>6.3</td> <td>10</td> <td>16</td> <td>25</td> <td>35</td> <td>50</td> <td>63</td> <td>100</td> </tr> <tr> <td>tan δ(MAX.)</td> <td>0.28</td> <td>0.24</td> <td>0.20</td> <td>0.16</td> <td>0.14</td> <td>0.12</td> <td>0.10</td> <td>0.08</td> </tr> </table>	Rated voltage(V)	6.3	10	16	25	35	50	63	100	tan δ(MAX.)	0.28	0.24	0.20	0.16	0.14	0.12	0.10	0.08										
Rated voltage(V)	6.3	10	16	25	35	50	63	100																					
tan δ(MAX.)	0.28	0.24	0.20	0.16	0.14	0.12	0.10	0.08																					
Stability at Low Temperature	Measurement frequency : 120Hz																												
	<table border="1"> <tr> <td colspan="2">Rated voltage(V)</td> <td>6.3</td> <td>10</td> <td>16</td> <td>25</td> <td>35</td> <td>50</td> <td>63</td> <td>100</td> </tr> <tr> <td rowspan="2">Impedance ratio ZT/Z20(MAX.)</td> <td>Z—25°C/Z+20°C</td> <td>5</td> <td>4</td> <td>3</td> <td>2</td> <td>2</td> <td>2</td> <td>2</td> <td>2</td> </tr> <tr> <td>Z—40°C/Z+20°C</td> <td>12</td> <td>10</td> <td>8</td> <td>5</td> <td>4</td> <td>3</td> <td>3</td> <td>3</td> </tr> </table>	Rated voltage(V)		6.3	10	16	25	35	50	63	100	Impedance ratio ZT/Z20(MAX.)	Z—25°C/Z+20°C	5	4	3	2	2	2	2	2	Z—40°C/Z+20°C	12	10	8	5	4	3	3
Rated voltage(V)		6.3	10	16	25	35	50	63	100																				
Impedance ratio ZT/Z20(MAX.)	Z—25°C/Z+20°C	5	4	3	2	2	2	2	2																				
	Z—40°C/Z+20°C	12	10	8	5	4	3	3	3																				
Endurance	After 2000 hours' application of voltage at 85°C, capacitors meet the characteristic requirements listed below.																												
	<table border="1"> <tr> <td>Capacitance change</td> <td>Within ±20% of initial value</td> </tr> <tr> <td>tan δ</td> <td>200% or less of initial specified value</td> </tr> <tr> <td>Leakage current</td> <td>Initial specified value or less</td> </tr> </table>	Capacitance change	Within ±20% of initial value	tan δ	200% or less of initial specified value	Leakage current	Initial specified value or less																						
Capacitance change	Within ±20% of initial value																												
tan δ	200% or less of initial specified value																												
Leakage current	Initial specified value or less																												
Shelf Life	After leaving capacitors under no load at 85°C for 1000 hours, they meet the specified value for endurance characteristics listed above.																												
Marking	Printed with black color letter on Gold sleeve according to JIS C 5141.																												

Radial Lead Type

Type numbering system (Example : 10V 1000μF)

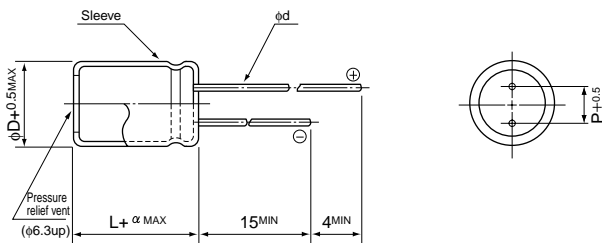

α	(φD<20) 1.5
	(φD≥20) 2.0

φD	5	6.3	8	10	12.5	16	18	20	22	25
P	2.0	2.5	3.5	5.0	5.0	7.5	7.5	10	10	12.5
φd	0.5	0.5	0.6	0.6	0.6	0.8	0.8	1.0	1.0	1.0
β	0.5	0.5	0.5	0.5	0.5	0.5	0.5	0.5	1.0	1.0

1 2 3 4 5 6 7 8 9 10 11
U F W 1 A 1 0 2 M P A

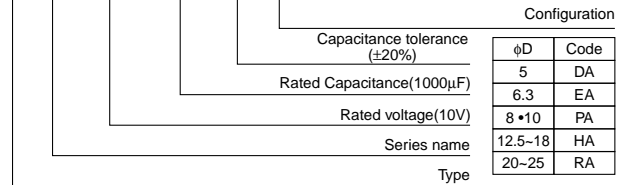

Please refer to page 18, 19, 20 about the formed or taped product spec.
Please refer to page 3 for the minimum order quantity.

Dimension table in next page.

■ Dimensions

D×L (mm)

Cap.(μF)	Code	V		6.3		10		16		25		35		50		63		100	
		OJ	1A	1C	1E	1V	1H	1J	2A										
0.1	0R1													5×11	1.1			5×11	2.1
0.22	R22													5×11	2.4			5×11	4.7
0.33	R33													5×11	3.5			5×11	7.0
0.47	R47													5×11	5.0			5×11	10
1	010													5×11	10			5×11	21
2.2	2R2													5×11	23			5×11	30
3.3	3R3													5×11	35			5×11	40
4.7	4R7													5×11	40			5×11	45
10	100													5×11	65	5×11	70	6.3×11	75
22	220													5×11	95	5×11	100	6.3×11	120
33	330									5×11	105	5×11	120	6.3×11	140	8×11.5	160		
47	470							5×11	115	5×11	120	6.3×11	150	6.3×11	165	10×12.5	210		
100	101			5×11	145	5×11	155	6.3×11	185	6.3×11	200	8×11.5	250	10×12.5	300	10×20	350		
220	221			6.3×11	230	6.3×11	250	8×11.5	320	10×12.5	370	10×12.5	410	10×16	470	12.5×25	600		
330	331	6.3×11	265	6.3×11	270	8×11.5	360	10×12.5	420	10×12.5	470	10×16	570	10×20	650	12.5×25	750		
470	471	6.3×11	310	6.3×11	330	8×11.5	420	10×12.5	530	10×16	630	12.5×20	760	12.5×20	880	16×25	1000		
1000	102	8×11.5	530	10×12.5	630	10×16	770	10×20	950	12.5×20	1100	12.5×25	1300	16×25	1300	18×40	1370		
2200	222	10×20	980	10×20	1050	12.5×20	1250	12.5×25	1550	16×25	1800	16×35.5	2090	18×35.5	2200	22×50	2400		
3300	332	10×20	1170	12.5×20	1420	12.5×25	1700	16×25	1950	16×35.5	2220	18×35.5	2360	20×40	2700	25×50	2900		
4700	472	12.5×20	1350	12.5×25	1800	16×25	2100	16×31.5	2360	18×35.5	2490	20×40	2900	22×50	3400				
6800	682	12.5×25	1600	16×25	2150	16×35.5	2500	18×35.5	2590	20×40	3000	22×50	3500	25×50	3500				
10000	103	16×25	2000	16×35.5	2500	18×35.5	2640	20×40	3000	22×50	3700	25×50	4000						
15000	153	16×35.5	2550	18×35.5	2720	20×40	3400	22×50	3800	25×50	4300								
22000	223	18×40	3200	20×40	3700	22×50	4200	25×50	4500										
33000	333	22×50	3900	22×50	4500	25×50	4800											Case size	Rated ripple

Rated Ripple (mA rms) at 85°C 120Hz

■ Frequency coefficient of rated ripple current

Cap.(μF)	Frequency	50Hz	120Hz	300Hz	1kHz	10kHz~
~ 47		0.75	1.00	1.35	1.57	2.00
100 ~ 470		0.80	1.00	1.23	1.34	1.50
1000 ~ 33000		0.85	1.00	1.10	1.13	1.15