

2.0x1.2mm SMD CHIP LED LAMP

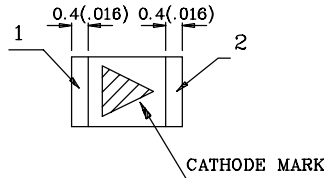

SUN LED

ZSG54W-01

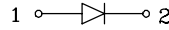
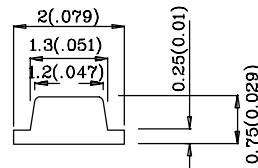
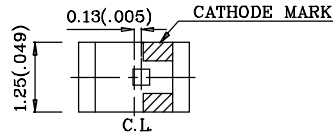

Notes:

1. All dimensions are in millimeters (inches).
2. Tolerance is $\pm 0.1(0.004)$ unless otherwise noted.

Absolute maximum ratings ($T_A=25^\circ\text{C}$)		SG (InGaAlP)	Unit
Reverse Voltage	V_R	5	V
Forward Current	I_F	25	mA
Forward Current (Peak) 1/10Duty cycle 0.1ms pulse width	i_{FS}	200	mA
Power dissipation	P_T	105	mW
Operation Temperature	T_A	-40 ~ +85	$^\circ\text{C}$
Storage Temperature	T_{stg}		

Operating Characteristics ($T_A=25^\circ\text{C}$)		SG (InGaAlP)	Unit
Forward voltage (typ.) ($I_F=20\text{mA}$)	V_F	2.25	V
Forward voltage (max.) ($I_F=20\text{mA}$)	V_F	2.5	V
Reverse current ($V_R=5\text{V}$)	I_R	10	μA
Wavelength at peak emission ($I_F=20\text{mA}$)	λ_{peak}	565	nm
Spectral Line half-width ($I_F=20\text{mA}$)	$\Delta\lambda$	25	nm
Capacitance ($V_F=0$, $f=1\text{MHz}$)	C	20	pF

Part Number	Emitting Color	Emitting Material	Lens-color	Luminous Intensity ($I_F=20\text{mA}$) mcd		Wavelength nm	Viewing Angle
				min.	typ.		
ZSG54W-01	green	InGaAlP	water clear	20	50	565	120°

ZSG54W-01

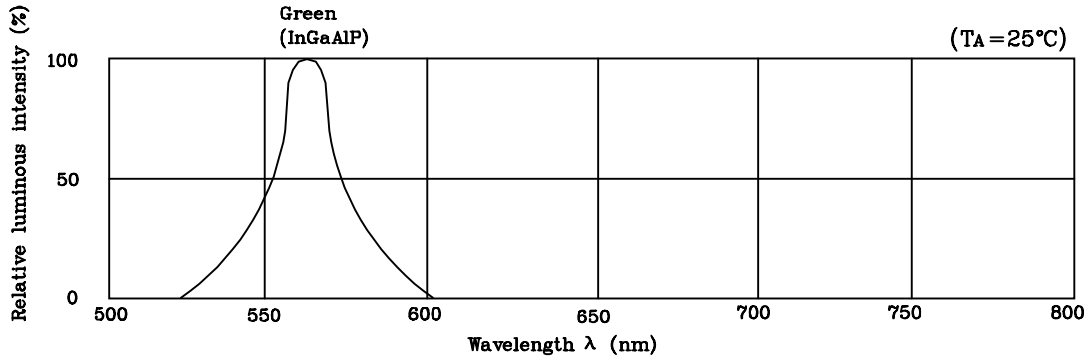

◆SG

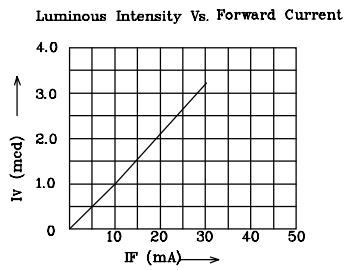
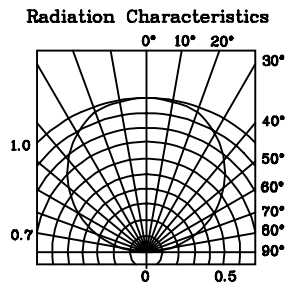
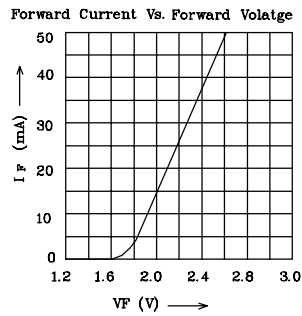
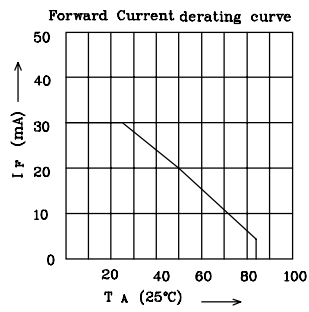

ZSG54W-01
❖SMT Reflow Soldering Instructions

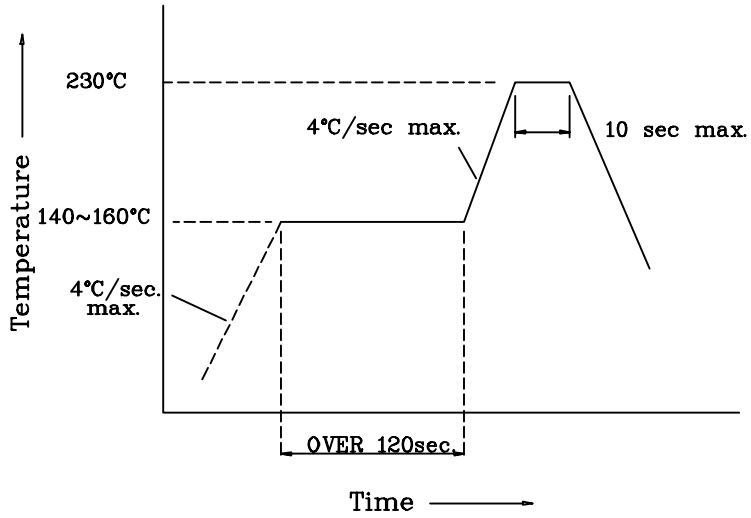

❖Recommended Soldering Pattern (Units : mm)

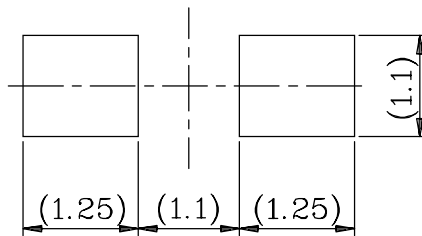

ZSG54W-01

❖ Tape Specification (Units : mm)

