

SK [For General]

85 °C Single-Ended Lead Aluminum Electrolytic Capacitors



DESCRIPTION

Lower-cost capacitors expressly intended for high density printed circuit board.

Very high volumetric efficiency.

Ideally suited for general-purpose applications, decoupling, by pass, and filtering circuit in entertainment electronics.

Feature high CV product with moderate cost.

ELECTRICAL CHARACTERISTICS

Working Voltage : 6.3 ~ 100V / 160 ~ 450V

Operating Temperature : -40° ~ +85°C / -25° ~ +85°C

Rate Capacitance Range : 0.1 ~ 22000 μ F / 0.47 ~ 330 μ F

Capacitance Tolerance : -20 ~ +20% / -20 ~ +20%

DC Leakage Current (μ A) : 0.01 CV or 3 μ A / 0.03 CV + 10 whichever is greater.
(After 2 Minutes Application of DC Working Voltage at 25°C)

Dissipation Factor : at 120Hz, 25°C

WV (V) :	6.3	10	16	25	35	50	63	100	160~250	350~450
DF (%) :	22	19	16	14	12	10	9	8	15	20

For capacitor whose capacitance exceeds 1000 μ F. The value of DF(%) is increased by 2% for every addition of 1000 μ F.

Load Life : 2000 Hours at 85°C Assured with Full Rated Maximum Ripple Current Applied

(a) Capacitance Change : Within 20% of Initial Value

(b) Dissipation Factor : Not Exceed 200% of Initial Requirement

(c) Leakage Current : Not Exceed the Initial Requirement

Shelf Life : 1000 Hours, No Voltage Applied

(a) Capacitance Change : Within 20% of Initial Value

(b) Dissipation Factor : Not Exceed 200% of Initial Requirement

(c) Leakage Current : Not Exceed 200% of Initial Requirement

DIAGRAM OF DIMENSIONS

Dimensions : mm

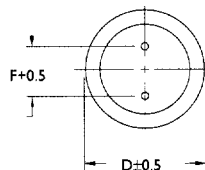
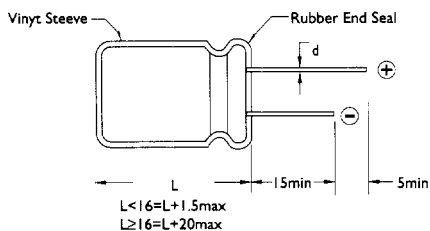

D	F	d ϕ
5.0	2.0	0.5
6.0	2.5	
8.0	3.5	
10.0	5.0	0.6
13.0		
16.0	7.5	0.8
18.0		

CASE SIZE OF STANDARD PRODUCTS ($D\varnothing \geq 6\text{mm}$ with Safety Vent at Can Bottom)

CAP. (μP)	RATED VOLTAGE WV (SV)														
	6.3 (8)	10 (13)	16 (20)	25 (32)	35 (44)	50 (63)	63 (79)	100 (125)	160 (200)	200 (250)	250 (300)	350 (400)	400 (450)	450 (500)	
0.1						5 x 11									
0.22						5 x 11									
0.33						5 x 11									
0.47						5 x 11	5 x 11	5 x 11	5 x 11	5 x 11	5 x 11	5 x 11	6 x 11	6 x 11	
1.0						5 x 11	5 x 11	5 x 11	5 x 11	5 x 11	6 x 11	6 x 11	6 x 11 8 x 11	8 x 11	
2.2						5 x 11	5 x 11	5 x 11	6 x 11	6 x 11	6 x 11 8 x 11	8 x 11	8 x 11 10 x 12	10 x 12	
3.3						5 x 11	5 x 11	5 x 11	8 x 11	8 x 11	10 x 12 8 x 11	10 x 12	10 x 12	10 x 15	
4.7					5 x 11	5 x 11	5 x 11	5 x 11	8 x 11	8 x 11	8 x 11 10 x 12	10 x 15	10 x 12 10 x 15	10 x 15	10 x 15
10			5 x 11	5 x 11	5 x 11	5 x 11	5 x 11	6 x 11	10 x 12	10 x 12	10 x 12 10 x 15	10 x 19	10 x 15	10 x 19 13 x 20	13 x 20 13 x 25
22	5 x 11	5 x 11	5 x 11	5 x 11	5 x 11	5 x 11	6 x 11	8 x 11	10 x 15	10 x 15	10 x 15 13 x 25	13 x 20	13 x 20	13 x 25 16 x 25	16 x 32
33	5 x 11	5 x 11	5 x 11	5 x 11	5 x 11	6 x 11	6 x 11 8 x 11	10 x 12	10 x 19	10 x 19	13 x 25	13 x 25	16 x 25	16 x 25	16 x 36
47	5 x 11	5 x 11	5 x 11	5 x 11	5 x 11 6 x 11	6 x 11 8 x 11	8 x 11	10 x 12 10 x 15	13 x 20	13 x 20	13 x 20 13 x 25	16 x 32	16 x 25	16 x 32	18 x 40
100	5 x 11	5 x 11	5 x 11 6 x 11	6 x 11	8 x 11	8 x 11 10 x 12	10 x 12	10 x 19	16 x 25	16 x 25	18 x 40	18 x 36	22 x 40	22 x 40	22 x 40
220	5 x 11 6 x 11	6 x 11	6 x 11 8 x 11	8 x 11 10 x 12	10 x 12	10 x 15	10 x 15 10 x 19	13 x 25	16 x 32 16 x 36	18 x 36 18 x 40	22 x 40	22 x 40			
330	6 x 11 8 x 11	8 x 11	8 x 11	10 x 12	10 x 12 10 x 15	10 x 15 10 x 19	13 x 20	13 x 25 16 x 25	18 x 36 18 x 40	22 x 40					
470	8 x 11	8 x 11	8 x 11 10 x 12	10 x 12 10 x 15	10 x 19 13 x 20	13 x 20	13 x 25	16 x 25	22 x 40						
1000	8 x 11 10 x 12	10 x 12 10 x 15	10 x 15 10 x 19	10 x 19 13 x 20	13 x 20 13 x 25	13 x 25 16 x 25	16 x 25 16 x 32	16 x 32 18 x 40							
2200	10 x 19 13 x 20	10 x 19 13 x 20	13 x 20 13 x 25	13 x 25 16 x 25	16 x 25 16 x 32	16 x 36 18 x 36	18 x 40	22 x 40							
3300	10 x 19 13 x 20	13 x 20 13 x 25	13 x 25 16 x 25	16 x 25 16 x 32	16 x 36 18 x 36	18 x 40	22 x 40								
4700	13 x 20 16 x 25	13 x 25 16 x 25	16 x 25 16 x 32	16 x 32 18 x 36	18 x 36	22 x 40									
6800	16 x 25	16 x 25 16 x 32	16 x 36 18 x 36	18 x 36	22 x 40										
10000	16 x 25 16 x 32	16 x 36 18 x 36	18 x 36	22 x 40											
15000	16 x 36 18 x 36	18 x 36	22 x 40	22 x 40											
22000	18 x 40	22 x 40	22 x 40												

LOAD LIFE

Capacitance Change Ratio

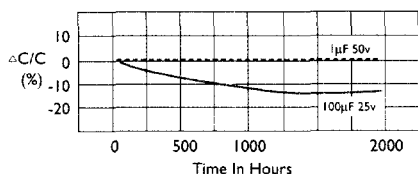

Dissipation Factor Change

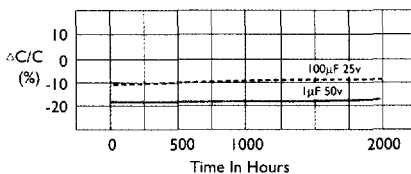

Leakage Current Change

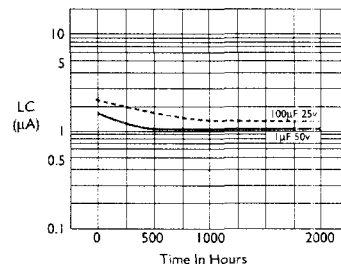

PERMISSIBLE RIPPLE CURRENT (mA, rms) at 85°C, 120Hz

CAP. (μP)	RATED VOLATAGE WV (SV)														
	6.3 (8)	10 (13)	16 (20)	25 (32)	35 (44)	50 (63)	63 (79)	100 (125)	160 (200)	200 (250)	250 (300)	350 (400)	400 (450)	450 (500)	
0.1						1									
0.22						2									
0.33						3									
0.47						5	10	10	12	14	14	14	14	14	
1.0						10	21	21	17	19	19	19	19	19	
2.2						23	29	30	26	27	30	33	33	33	
3.3						35	35	40	45	35	37	38	39	40	42
4.7				30	35	40	45	50	40	45	45	45	45	45	50
10			40	50	60	65	70	75	65	70	70	70	70	70	75
22	35	55	75	90	95	100	115	130	110	120	130	130	130	130	130
33	55	80	110	115	120	125	140	170	150	160	160	170	170	170	180
47	75	95	130	135	140	150	190	230	180	190	210	220	220	220	230
100	130	180	185	200	230	250	300	400	300	330	310	360	360	360	370
220	240	250	320	340	370	440	490	710	510	520	600 800	700			
330	300	330	360	420	490	580	680	860	600	700					
470	380	400	470	540	640	760	880	1100	900						
1000	580	630	790	950	1100	1350	1550	1680							
2200	1050	1100	1350	1550	1800	2090	2200	2300							
3300	1250	1400	1700	1950	2220	2400	2500								
4700	1700	1800	2100	2360	2400	2500									
6800	1900	2150	2500	2550	2600										
10000	2250	2500	2700	2800											
15000	2880	2950	3150	3200											
20000	3650	3700	3800												

TEMPERATURE CHARACTERISTICS

Capacitance Change Ratio

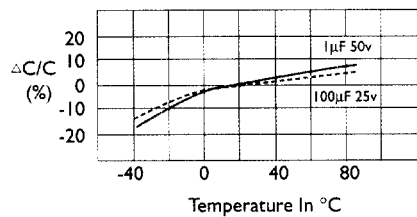

Dissipation Factor Change

