

Agilent IR Remote Control Software Product Brief

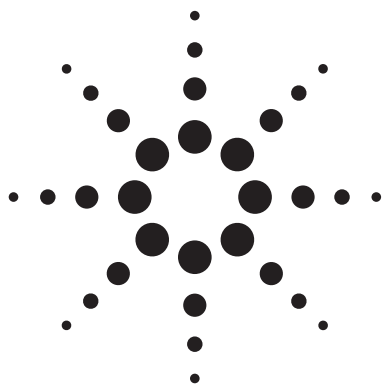

Introduction

Agilent Technologies' Universal IR Remote Control Software is a Pocket PC and Pocket PC 2002 application that uses your PDA as a universal remote control for TV, VCR, DVD and other equipment.

This application currently runs on devices with Intel StrongARM CPU, 206MHz or Intel XScale to enable a wireless link between the handheld device and the consumer-electronics appliance.

The wireless link is achieved using either an IRDA Transceiver or a Discrete LED solution and has been optimized to work with Agilent's combined IRDA+RC Transceiver (HSDL-3002).

The software is a Universal Remote Control Program with a pre-defined RC database and self-teach/learn mode; it consists of 8 profiles. The 8 profiles are as follows: TV, DVD, VCR, AIRCON, CD, AUDIO, LD/VCD and OTHERS.

Each profile can have up to 10 controls, thus 80 devices can be stored (8 profiles x 10 devices) and each device can have up to 32 buttons/functions which can either be controlled via the touch-screen or using the PDA hardware buttons to navigate and control the software features.

Remote Control Software Functionalities

- **Add device**
 - adds a device to a profile
- **Delete device**
 - deletes a device from a profile
- **Add button**
 - adds a button to a device
- **Delete button**
 - deletes a button from a device
- **Edit button**
 - edits image/label/signal of a button
- **Move button**
 - moves a button to a certain area within the device
- **Reset all**
 - resets all devices
- **Show label**
 - shows or hides label

Ordering Information

Part Number	Description
HSDL-S300	Universal Remote Control Software for Pocket PC
HSDL-S300-001	Universal Remote Control Software for Pocket PC: Maintenance support
HSDL-S300-002	Universal Remote Control Software for Pocket PC: Training
HSDL-S300-003	Universal Remote Control Software for Pocket PC: Integration services (Porting)

Features

- **Easy to use**
 - on-screen instructions and help file are provided
- **Code learning**
 - easy to learn with on-screen instructions
- **Device runs on Intel StrongArm CPU, 206MHz or Intel XScale**
 - portable to other processors upon request
- **Pre-defined GUI**
 - TV, VCR, DVD, AIRCON, CD, AUDIO, LD/VCD and OTHERS
- **Customizable GUIs**
 - move button
- **Customizable button text**
- **Customizable button image**

System Requirements

- **Pocket PC or Pocket PC 2002 device(s) running on Intel StrongArm CPU, 206MHz or Intel XScale** (Portable to other processors upon request)
- **750 KB of available storage space**



Agilent Technologies

Some GUIs

• TV control page



1st page of TV control



2nd page of TV control

• On-screen instruction



• One-stop option



• Self-learn and edit button text

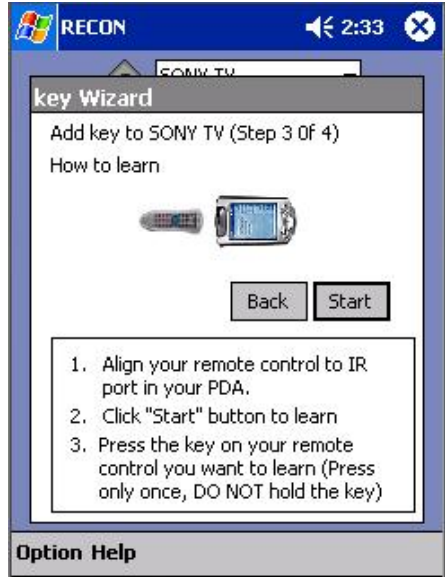

For product information and a complete list of Agilent contacts and distributors, please go to our web site.

www.agilent.com/semiconductors

E-mail: SemiconductorSupport@agilent.com

Data subject to change.

Copyright © 2003 Agilent Technologies, Inc.

April 23, 2003

5988-9422EN



Agilent Technologies