

1. Mechanical Dimensions:

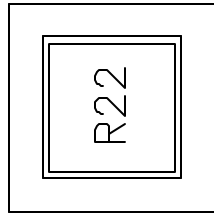

Top view

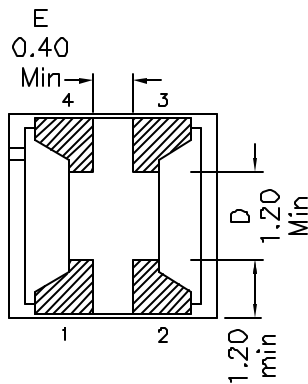
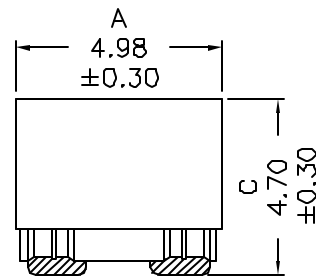
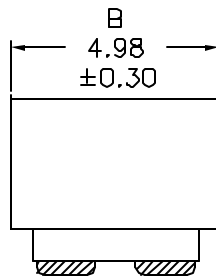

Bottom view

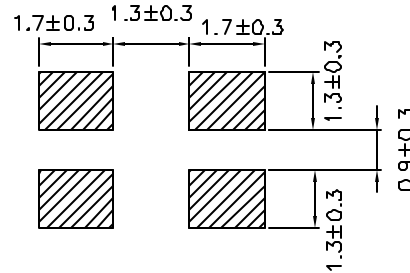

Suggested Pad Layout

2. Schematic:

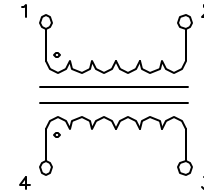

3. Electrical Specification: @25°C

OCL: 0.22uH Min @100KHz, 0.1V Each Wdg.

Q: 5 Min @100KHz, 0.1V Each Wdg.

Rated Current: 1.5A

DCR: 0.105 Ohms Max Each Wdg.

Insertion Loss (dB) common mode/differential mode:

100MHz	200MHz	400MHz	500MHz
9.04/0.19	13.66/0.94	17.75/1.79	17.11/2.09

Notes:

1. Solderability: Leads shall meet MIL-STD-202G, Method 208H for solderability.
2. Flammability: UL94V-0
3. ASTM oxygen index: > 28%
4. Insulation System: Class F 155°C, UL file E151556
5. Operating Temperature Range: All listed parameters are to be within tolerance from -40°C to +85°C
6. Storage Temperature Range: -55°C to +125°C
7. Aqueous wash compatible
8. SMD Lead Coplanarity: $\pm 0.004^\circ$ (0.102mm)
9. Electrical and mechanical specifications 100% tested
10. RoHS Compliant Component

XFMRs Inc. www.XFMRs.com	Title: EMI filter		
UNLESS OTHERWISE SPECIFIED TOLERANCES: .xx ±0.25 Dimensions in MM	P/N: XFWCMC636347-R22	Rev. A	
	DWN.	Feng	Nov-18-11
	CHK.	YK Liao	Nov-18-11
SHT 1 OF 2	APP.	Joe Huff	Nov-18-11

DOC. REV: A/5

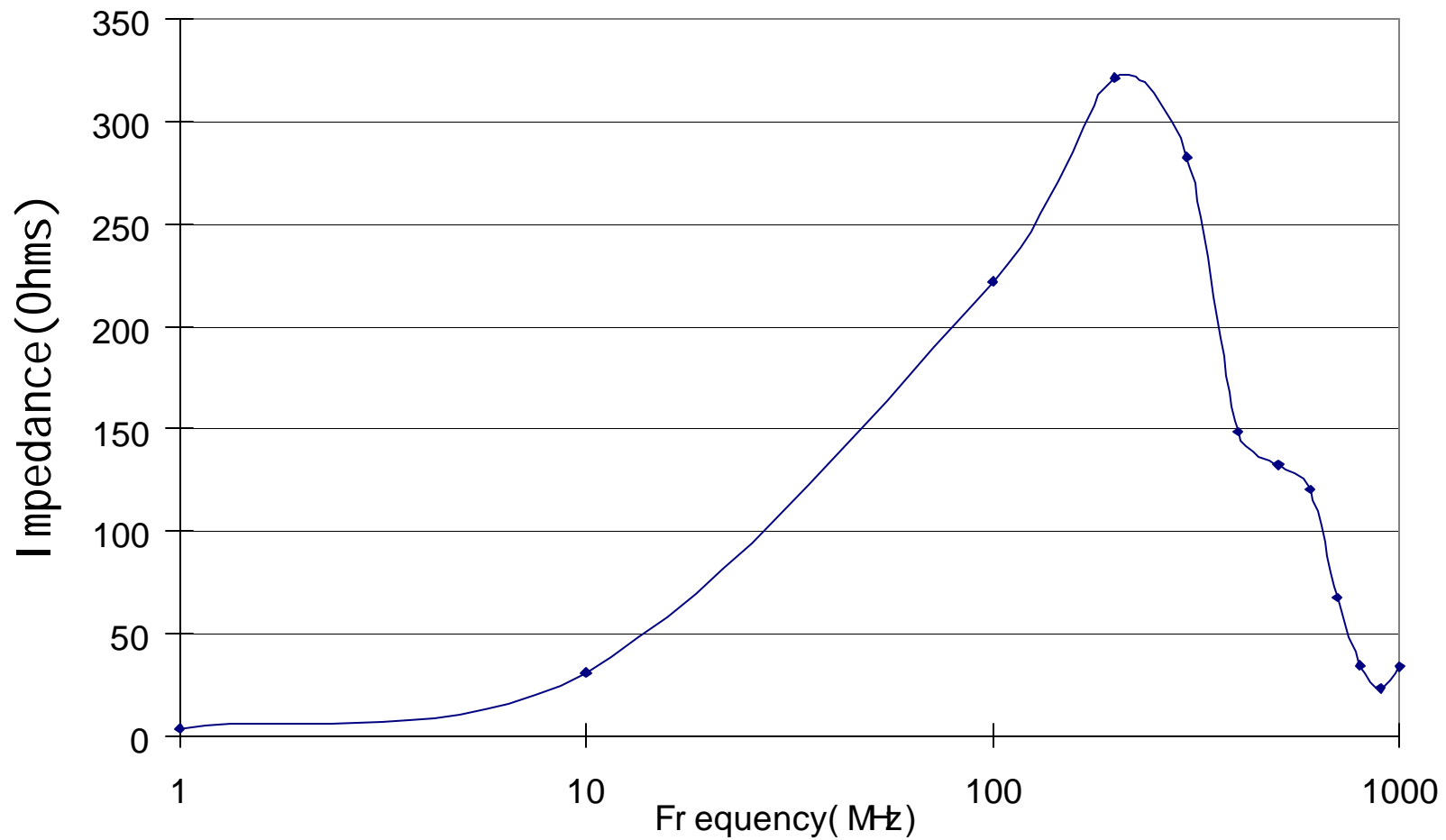

DOC. REV: A/5

XFMRs Inc. www.XFMRS.com	Title: EMI filter			
	UNLESS OTHERWISE SPECIFIED TOLERANCES: .xx ±0.25 Dimensions in MM	P/N: XFWCMC636347-R22	Rev. A	
	DWN.	Feng	Nov-18-11	
	CHK.	YK Liao	Nov-18-11	
SHT 2 OF 2	APP.	Joe Huff	Nov-18-11	

PROPRIETARY Document is the property of XFMRs Group & is not allowed to be duplicated without authorization.