

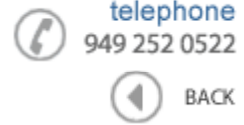

Data Sheet



Product Category: RF SAW Filter

Part Number	Package	Application	Last Modified
862-RF1220.0M-A	3.0 x 3.0 SMD	Wireless	Jan. 01, 2007

TYPE :

Wireless, Balanced RF SAW Filter



PART NUMBER :

862-RF1220.0M-A

OPERATING CONDITIONS / ELECTRICAL CHARACTERISTICS

PARAMETERS	Condition	Minimum	Typical	Maximum	Units
Center Frequency (Fo)	-	-	1220.0	-	MHz
Maximum Insertion Loss	1216.0~ 1224.0 MHz	-	3.5	4.8	dB
Stop Band Attenuation:	Fo-200.0~ Fo-68.0 MHz	46	51	-	dB
	Fo-88.0 MHz	48	53	-	
	Fo-72.0MHz	50	58	-	
	Fo-44.0 MHz	48	56	-	
	Fo-36.0 MHz	46	59	-	
	Fo+70.0~ 2000.0 MHz	50	61	-	
Amplitude Ripple	1216.0~ 1224.0 MHz	-	0.4	1.0	dBp-p
Source Impedance (balanced ended)*	-	-	200	-	ohm
Load Impedance (balanced ended)*	-	-	200	-	ohm
Group Delay Ripple	1216.0~ 1224.0 MHz	-	40	-	nsp-p
Maximum DC Voltage	-	-	-	3	V
Maximum Input Power	-	-	-	0	dBm
Operating Temperature	-	-30	-	+80	°C

* With Matching Network ns

PACKAGE OUTLINE (mm)

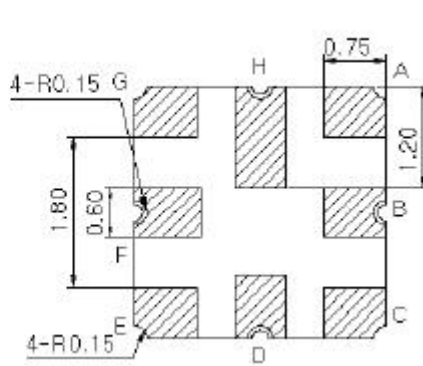
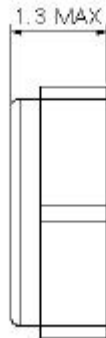
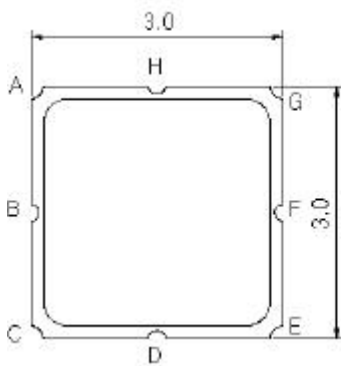

PIN LAYOUT	
A	In
B	In
C	Ground
D	Ground
E	Out
F	Out
G	Ground
H	Ground

TEST FIXTURE

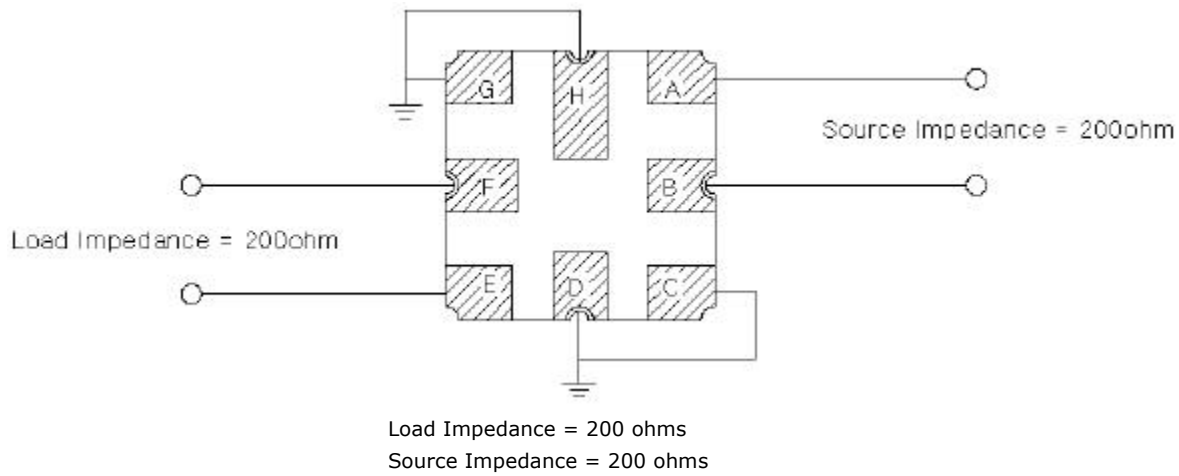

FREQUENCY RESPONSE

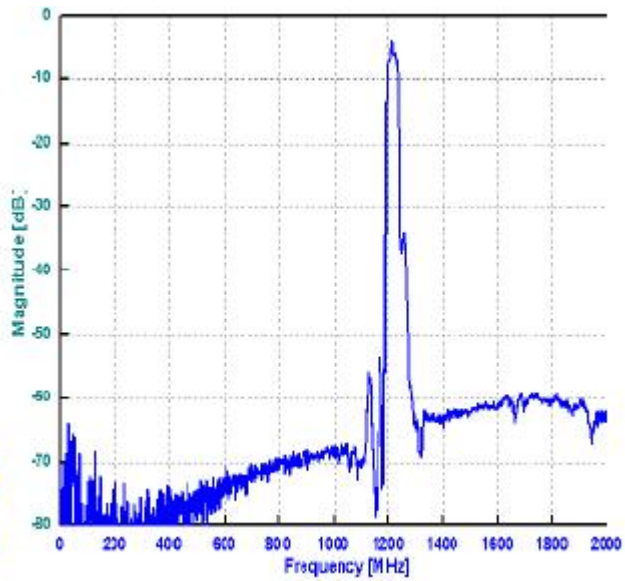
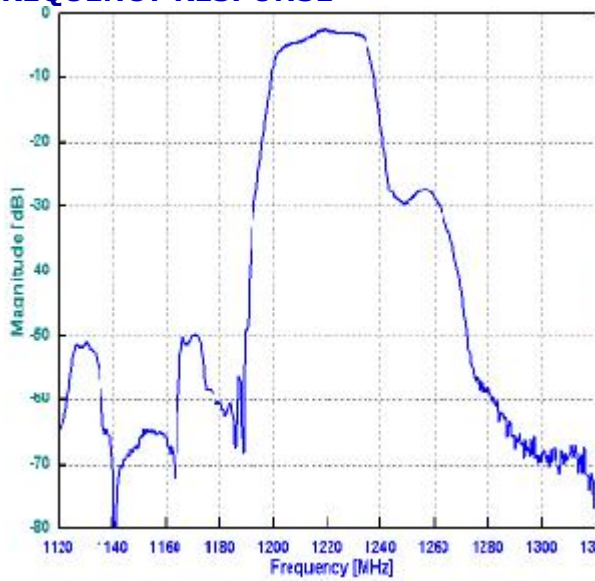

VSWR

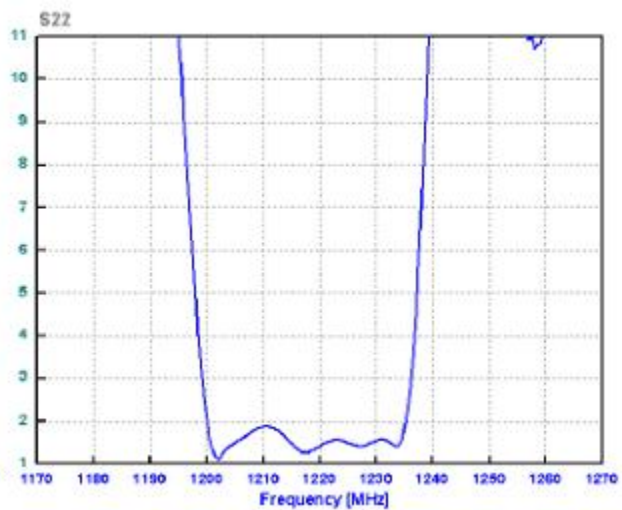
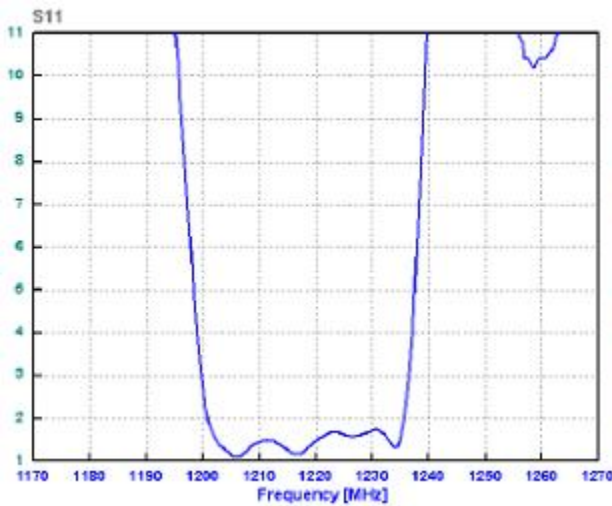

SMITH CHART

S11

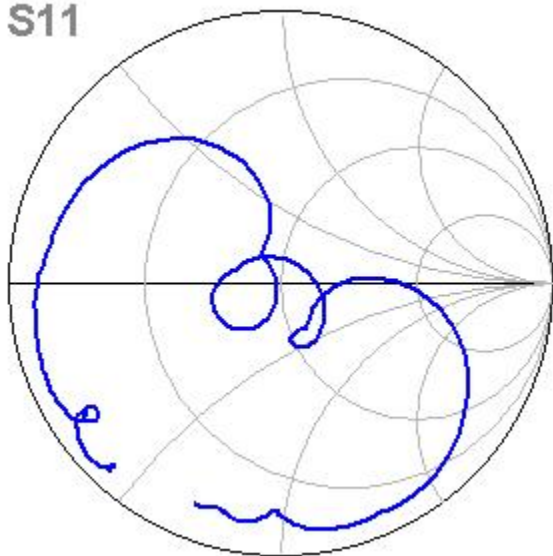

S22

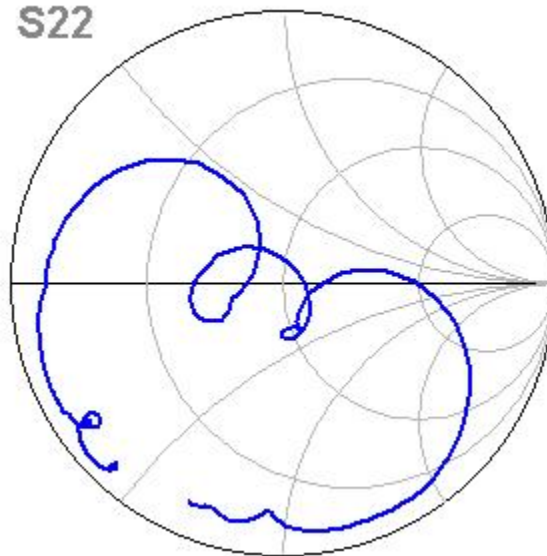

Oscilent Corporation - CALL **949.252.0522**

18195 East McDermott Street . Building D . Irvine . CA 92614 . USA
Fax: 949.252.0599 . E-Mail: Sales@Oscilent.com

Part No.: 862-RF1220.0M-A