

# 200 V - 1,000 V Three Phase Bridge

2.0 A Forward Current

70 ns - 3000 ns Recovery Time

**3102 - 3110**  
**3102F - 3110F**  
**3102UF - 3110UF**

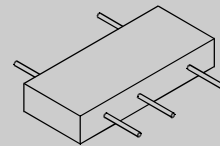

## ELECTRICAL CHARACTERISTICS AND MAXIMUM RATINGS

Part Number	Working Reverse Voltage (Vrwm) Volts	Average Rectified Current @TC (Io)		Reverse Current @ Vrwm (Ir)		Forward Voltage (Vf)		1 Cycle Surge Current tp=8.3ms (Ifsm)	Repetitive Surge Current (Ifrm)	Reverse Recovery Time (1) (Trr)	Thermal Impd. $\theta_{J-c}$
		55°C	100°C	25°C	100°C	25°C	Amps	25°C	25°C	25°C	°C/W
		Amps	Amps	µA	µA	Volts		Amps	Amps	ns	
3102 3106 3110	200 600 1000	2.0 2.0 2.0	1.2 1.2 1.2	1.0 1.0 1.0	25 25 25	1.1 1.1 1.1	1.0 1.0 1.0	30 30 30	10 10 10	3000 3000 3000	22.0 22.0 22.0
3102F 3106F 3110F	200 600 1000	2.0 2.0 2.0	1.2 1.2 1.2	1.0 1.0 1.0	25 25 25	1.3 1.3 1.3	1.0 1.0 1.0	25 25 25	6 6 6	150 150 150	22.0 22.0 22.0
3102UF 3106UF 3110UF	200 600 1000	2.0 2.0 2.0	1.2 1.2 1.2	1.0 1.0 1.0	25 25 25	1.7 1.7 1.7	1.0 1.0 1.0	25 25 25	5 5 5	70 70 70	22.0 22.0 22.0

(1)Trr Testing: If=0.5A, Ir=1.0A, Irr=0.25A \*Op. Temp.= -55°C to +150°C Stg. Temp.= -55°C to +150°C

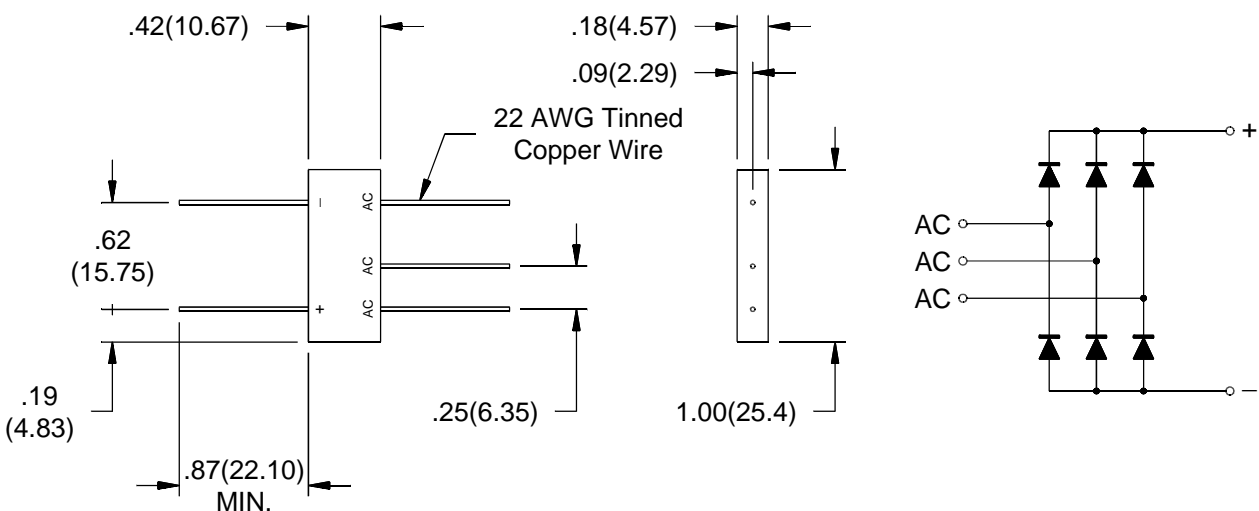

Dimensions: In. (mm) • All temperatures are ambient unless otherwise noted. • Data subject to change without notice.



**VOLTAGE MULTIPLIERS INC.**  
 8711 W. Roosevelt Ave.  
 Visalia, CA 93291

TEL 559-651-1402  
 FAX 559-651-0740  
[www.voltagemultipliers.com](http://www.voltagemultipliers.com)

# 3102 - 3110 • 3102F - 3110F • 3102UF - 3110UF

