

PNP Silicon Epitaxial Power Transistor

(Pb) Lead(Pb)-Free

Features:

- * DC Current Gain $h_{FE} = 60-200$ @ $I_C = 0.5A$
- * Low $V_{CE(sat)} \leq 1.0V(MAX)$ @ $I_C = 3.0A, I_B = 0.3A$
- * Complementary to NPN 2SD880

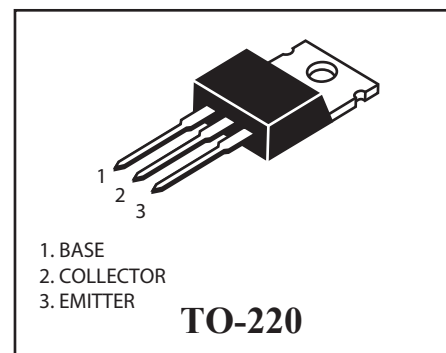
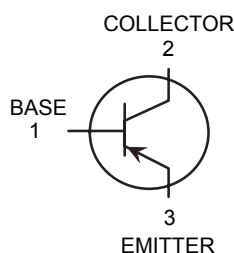

ABSOLUTE MAXIMUM RATINGS ($T_A=25^\circ C$)

Rating	Symbol	Value	Unit
Collector to Base Voltage	V_{CBO}	-60	V
Collector to Emitter Voltage	V_{CEO}	-60	V
Collector to Base Voltage	V_{EBO}	-7.0	V
Collector Current	I_C	-3.0	A
Total Device Dissipation $T_A=25^\circ C$ $T_C=25^\circ C$ Derate above $25^\circ C$	P_D	1.5 30 0.24	W W/ $^\circ C$
Junction Temperature	T_J	+150	$^\circ C$
Storage Temperature	T_{stg}	-55 to +150	$^\circ C$

ELECTRICAL CHARACTERISTICS

Characteristics	Symbol	Min	Max	Max	Unit
Collector-Base Breakdown Voltage $I_C=-100\mu A, I_E=0$	BV_{CBO}	-60	-	-	V
Collector-Emitter Breakdown Voltage $I_C=-50mA, I_B=0$	BV_{CEO}	-60	-	-	V
Emitter-Base Breakdown Voltage $I_E=-100\mu A, I_C=0$	BV_{EBO}	-7.0	-	-	V
Collector Cut-Off Current $V_{CB}=-60V, I_E=0$	I_{CBO}	-	-	-100	μA
Emitter-Cut-Off Current $V_{EB}=-7V, I_C=0$	I_{EBO}	-	-	-100	μA

2SB834



ELECTRICAL CHARACTERISTICS ($T_A=25^{\circ}\text{C}$ Unless otherwise noted)

Characteristic	Symbol	Min	Typ	Max	Unit
----------------	--------	-----	-----	-----	------

ON CHARACTERISTICS

DC Current Gain $V_{CE} = -5\text{V}, I_C = -500\text{mA}$ $V_{CE} = -5\text{V}, I_C = -3\text{A}$	h_{FE1} h_{FE2}	60 20	- -	200 -	-
Collector-Emitter Saturation Voltage $I_C = -3\text{A}, I_B = -0.3\text{A}$	$V_{CE(sat)}$	-	-	-1.0	V
Base-Emitter On Voltage $V_{CE} = -5\text{V}, I_C = -500\text{mA}$	V_{BE}	-	-	-1.0	V
Transition Frequency $V_{CE} = -5\text{V}, I_C = -500\text{mA}$	f_T	-	9	-	MHz
Transition Frequency $V_{CB} = -10\text{V}, I_E = 0, f = 1\text{MHz}$	C_{ob}	-	150	-	pF
Turn-on Time $V_{CC} = -30\text{V}, I_C = -2\text{A}, I_{B1} = I_{B2} = -0.2\text{A}$	t_{on}	-	0.4	-	μs
Storage Time $V_{CC} = -30\text{V}, I_C = -2\text{A}, I_{B1} = I_{B2} = -0.2\text{A}$	t_{stg}	-	1.7	-	
Turn-off Time $V_{CC} = -30\text{V}, I_C = -2\text{A}, I_{B1} = I_{B2} = -0.2\text{A}$	t_{off}	-	0.5	-	

ON CHARACTERISTICS

Rank	O	Y
Range	60-120	100-200

TO-220 Outline Dimensions

unit:mm

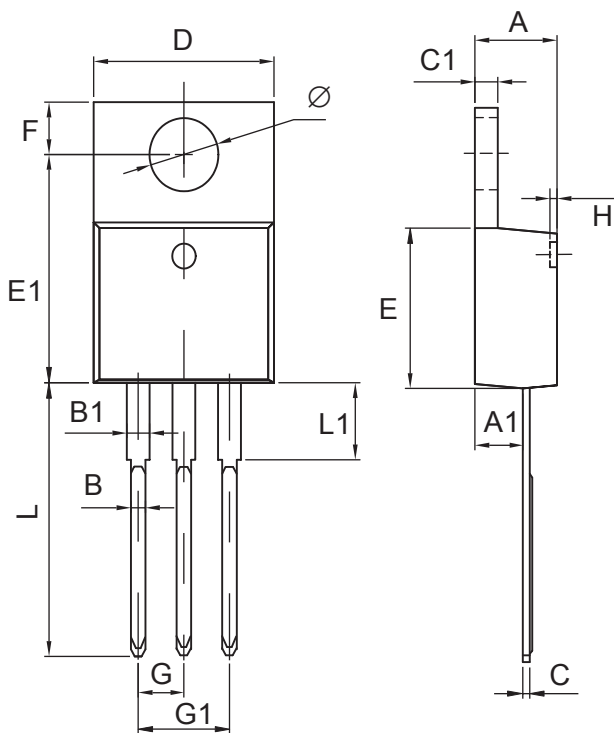

TO-220		
Dim	Min	Max
A	4.47	4.67
A1	2.52	2.82
B	0.71	0.91
B1	1.17	1.37
C	0.31	0.53
C1	1.17	1.37
D	10.01	10.31
E	8.50	8.90
E1	12.06	12.446
G	2.54 TYP	
G1	4.98	5.18
F	2.59	2.89
H	0.00	0.30
L	13.4	13.8
L1	3.56	3.96
Φ	3.73	3.93