

PLEASE CHECK WWW.MOLEX.COM FOR LATEST PART INFORMATION

Part Number: [0475710001](#)
Status: **Active**
Description: 1.10mm (.043") Pitch microSD Card Header with Detect Switch, Height 2.30mm (.091"), Lead Free

Documents:

[3D Model](#) [Product Specification PS-47309-001 \(PDF\)](#)
[Drawing \(PDF\)](#) [RoHS Certificate of Compliance \(PDF\)](#)

General

Product Family	Memory Card Sockets
Series	47571
Button Type	Push-Pull
Comments	Push-Pull Type
Component Type	I/O Header (Card)
Product Name	microSD Card, TransFlash
Type	N/A

Physical

Card Detection Switch	Yes
Circuits (Loaded)	8
Circuits (maximum)	8
Color - Resin	Black
Durability (mating cycles max)	10,000
Ejector Button Side	No Ejector Button Present
Entry Angle	90° Angle
Keying to Mating Part	Yes
Material - Metal	Phosphor Bronze
Material - Plating Mating	Gold
Material - Plating Termination	Nickel
Material - Resin	High Temperature Thermoplastic
PCB Locator	No
PCB Mounting Side	Reverse
PCB Retention	Yes
Packaging Type	Embossed Tape on Reel
Pitch - Mating Interface (in)	0.043 In
Pitch - Mating Interface (mm)	1.10 mm
Pitch - Term. Interface (in)	0.043 In
Pitch - Term. Interface (mm)	1.10 mm
Plating min: Mating (µin)	29.5
Plating min: Mating (µm)	0.75
Plating min: Termination (µin)	49.2
Plating min: Termination (µm)	1.25
Ports	1
Temperature Range - Operating	-40°C to +85°C
Termination Interface: Style	Surface Mount

Electrical

Current - Maximum per Contact	0.5A
Shielded	Yes
Voltage - Maximum	5V

Solder Process Data

Duration at Max. Process Temperature (seconds)	20
Lead-free Process Capability	Reflow Capable (SMT only)
Max. Cycles at Max. Process Temperature	2

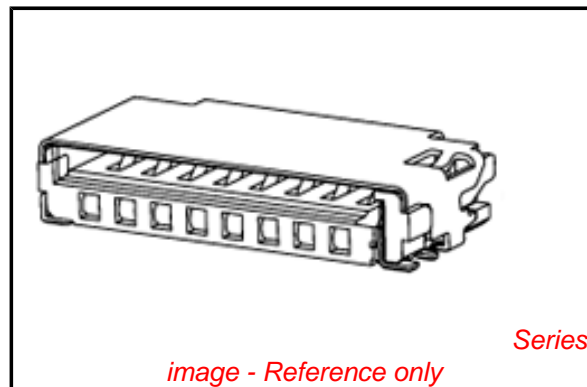

EU RoHS

**ELV and RoHS
Compliant**
**REACH SVHC
Contains SVHC: No**
**Halogen-Free
Status**

China RoHS



**Need more information on product
environmental compliance?**

Email productcompliance@molex.com
For a multiple part number RoHS Certificate of Compliance, [click here](#)

Please visit the [Contact Us](#) section for any non-product compliance questions.

Search Parts in this Series

[47571Series](#)

Mates With

Standard SIM Card

Use With

microSD Card

Process Temperature max. C 255

Material Info

Reference - Drawing Numbers

Product Specification PS-47309-001
Sales Drawing SD-47571-001

This document was generated on 03/31/2010

PLEASE CHECK WWW.MOLEX.COM FOR LATEST PART INFORMATION

10 9 8 7 6 5 4 3 2 1

F

E

D

C

B

A

F

E

D

C

B

A

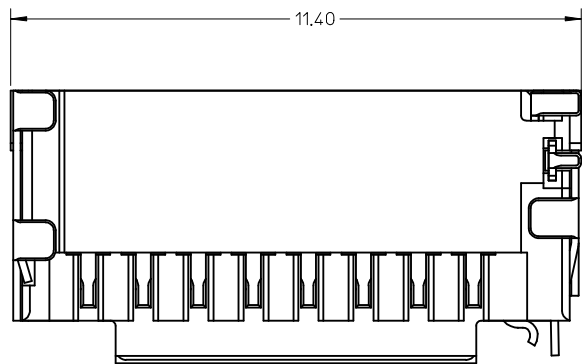
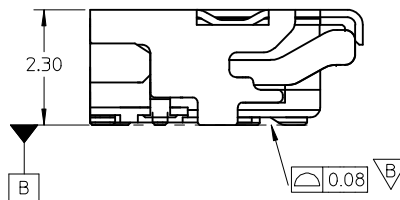
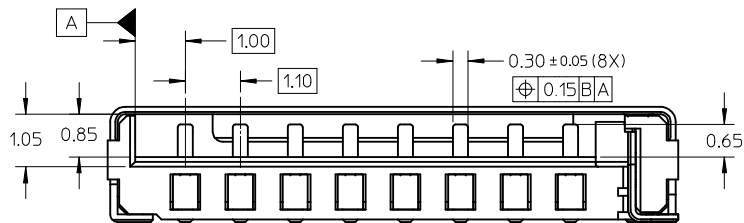
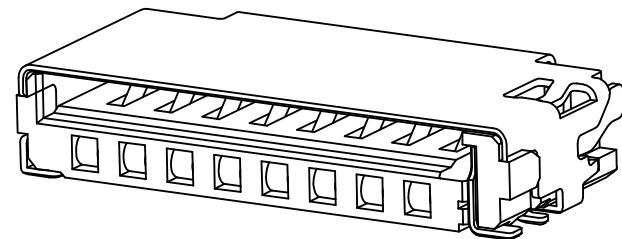
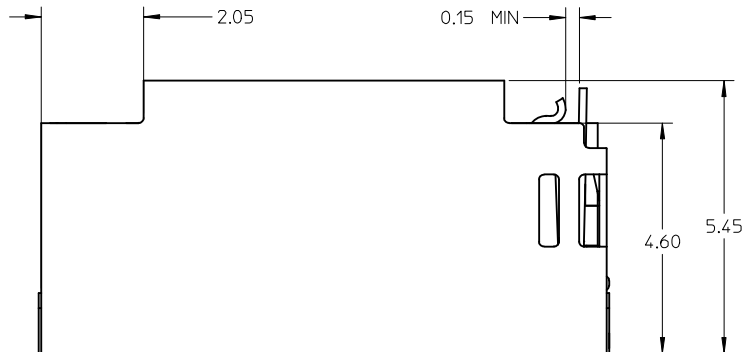

NOTE:

1 MATERIAL:

- 1-1 HOUSING : LCP, 30% G/F, UL 94V-0, BLACK
- 1-2 SIGNAL TERMINAL AND DETECT TERMINAL : PHOSPHOR BRONZE
- 1-3 METAL SHELL : STAINLESS STEEL

2 FINISH:

- 2-1 SIGNAL TERMINAL : 1.25-6.25 MICRON NICKEL MIN UNDER-PLATED, 0.75-1.25 MICRON GOLD MIN ON CONTACT AREA, GOLD FLASH PLATED ON SOLDER AREA
- 2-2 METAL SHELL : GOLD FLASH PLATED OVER NICKEL ON SOLDER AREA
- 2-3 DETECT PIN : 1.25-6.25 MICRON NICKEL MIN UNDER-PLATED GOLD FLASH PLATED ON CONTACT AREA, TIN PLATED ON SOLDER AREA

3 PRODUCT SPECIFICATION: PS-47309-001.

CHANGE CO-PLANARITY T00.08 EC NO: SH2009-0232 2008/11/26 DR: MALL LU10 2008/11/27 CHKD: YLZHU 2008/11/27 APPR: HWANG 2008/12/03	QUALITY SYMBOLS ▽=0 ▽=0	GENERAL TOLERANCES (UNLESS SPECIFIED)		DIMENSION STYLE MM ONLY		SCALE 15:1	DESIGN UNITS METRIC	THIRD ANGLE PROJECTION		
			mm	INCH	DRAWN BY IVAN HE	DATE 2007/06/12	TITLE TFR HEADER W/DETECT PIN			
		4 PLACES	± ---	± ---	CHECKED BY XIXU	DATE 2007/06/12				
		3 PLACES	± ---	± ---	APPROVED BY JNCHEN	DATE 2007/06/12	MOLEX INCORPORATED			
2 PLACES	± 0.15	± ---	MATERIAL NO. 475710001		DOCUMENT NO. SD-47571-001					
1 PLACE	± 0.25	± ---	ANGULAR ± 1 °		THIS DRAWING CONTAINS INFORMATION THAT IS PROPRIETARY TO MOLEX INCORPORATED AND SHOULD NOT BE USED WITHOUT WRITTEN PERMISSION					
DRAFT WHERE APPLICABLE MUST REMAIN WITHIN DIMENSIONS										

9 8 7 6 5 4 3 2 1

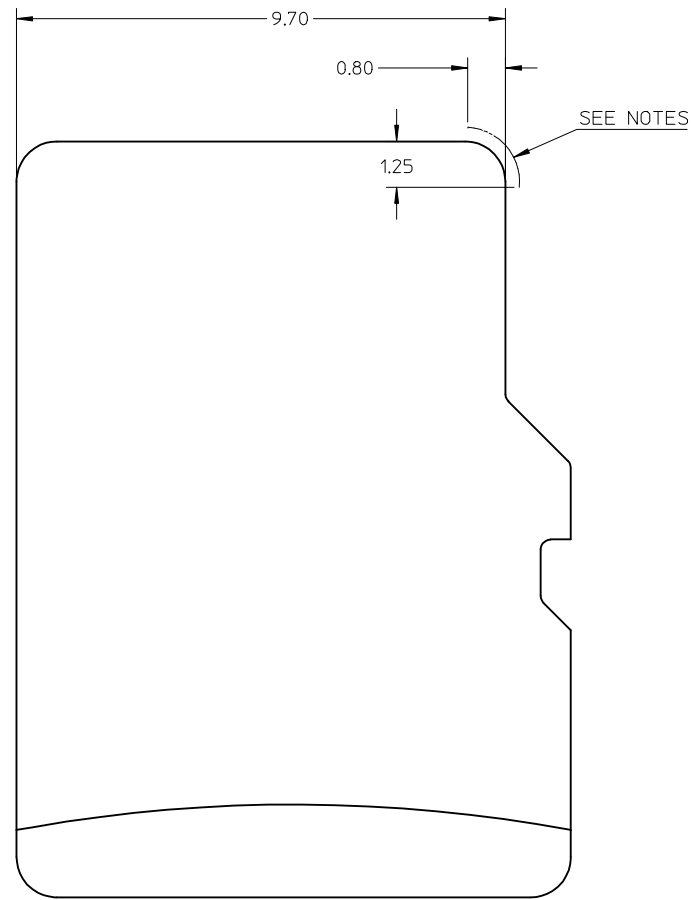
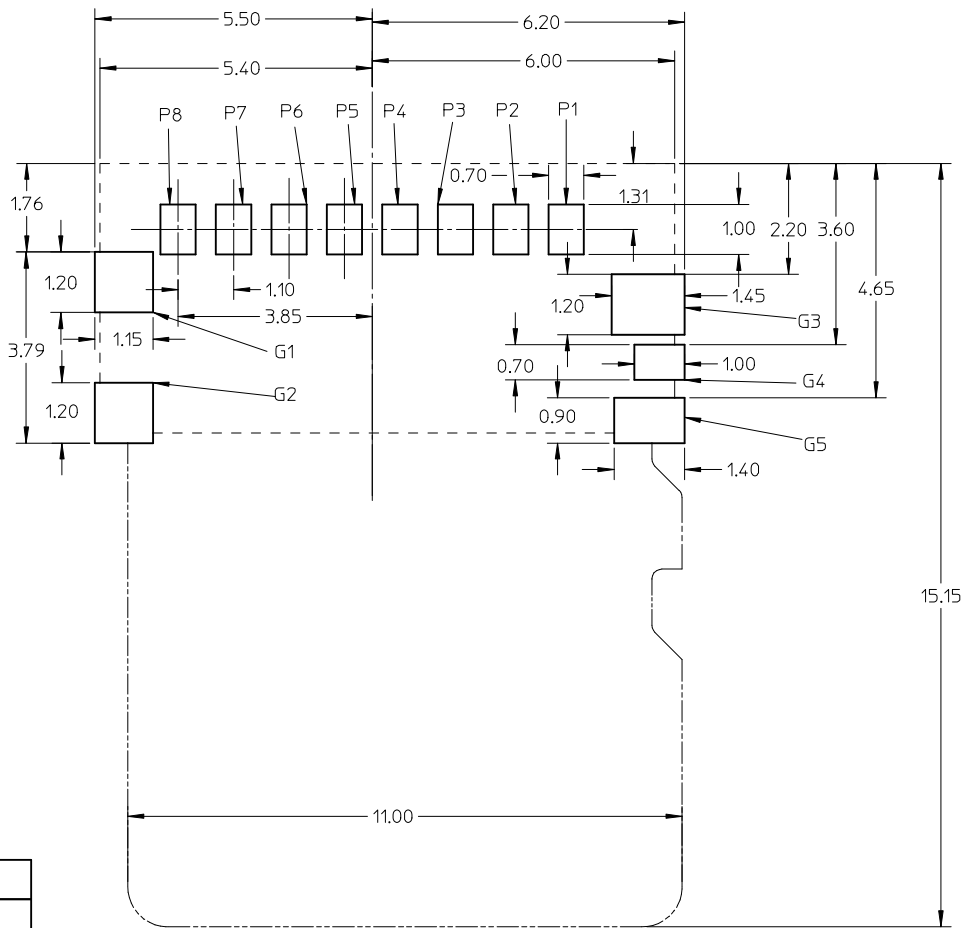

NOTES:

NO CONDUCTIVE EXPOSURE TRACE IS ALLOWED ON THE SIDE FACE OF THE CARD AT THIS AREA.

----- CONNECTOR PROFILE
 _____ CARD PROFILE

G5	DET
G4	POL
G3	GND
G2	GND
G1	GND
P8	DAT1
P7	DAT0
P6	VSS
P5	CLK
P4	VDD
P3	CMD
P2	CD/DAT3
P1	DAT2
PIN NUMBER	PIN NUMBER

SEE SHEET1 EC NO: SHZ009-0232 DRW:LLIU10 2008/11/26 CHKD:YLZHU 2008/11/27 APPR:HWANG 2008/12/03	QUALITY SYMBOLS
	▽=0
	∇=0
	DESCRIPTION
REV	

GENERAL TOLERANCES (UNLESS SPECIFIED)	mm	INCH
	4 PLACES	± --- ± ---
	3 PLACES	± --- ± ---
	2 PLACES	± 0.15 ± ---
1 PLACE	± 0.25 ± ---	
ANGULAR ± 1 °		
DRAFT WHERE APPLICABLE MUST REMAIN WITHIN DIMENSIONS		

DIMENSION STYLE		SCALE	DESIGN UNITS
MM ONLY		10:1	METRIC
DRAWN BY	DATE	TITLE	
IVAN HE	2007/06/12	TFR HEADER W/DETECT PIN	
CHECKED BY	DATE	MOLEX INCORPORATED	
XIXU	2007/06/12	DOCUMENT NO.	
APPROVED BY	DATE	SHEET NO.	
JNCHEN	2007/06/12	2 OF 2	
MATERIAL NO.		475710001	
SD-47571-001		THIS DRAWING CONTAINS INFORMATION THAT IS PROPRIETARY TO MOLEX INCORPORATED AND SHOULD NOT BE USED WITHOUT WRITTEN PERMISSION	