

1.27X1.27mm DUAL ROW BOX HEADER S.M.D.TYPE

(PLASTIC H:8.45mm)



127157MA Series

Mates with SUYIN 12750, 12751 Series

Specifications:

- 10-100 Circuits
- Insulator material : Black High Temp . Plastic
- Operating Temp. Range : -40°C to +105°C
- Terminal Material : Brass
- Plating : Contact-Gold Plated
- Max. Current Rating : 1.0A
- Voltage Rating : 150V AC
- Dielectric Strength : 500V (Min. 60 seconds)

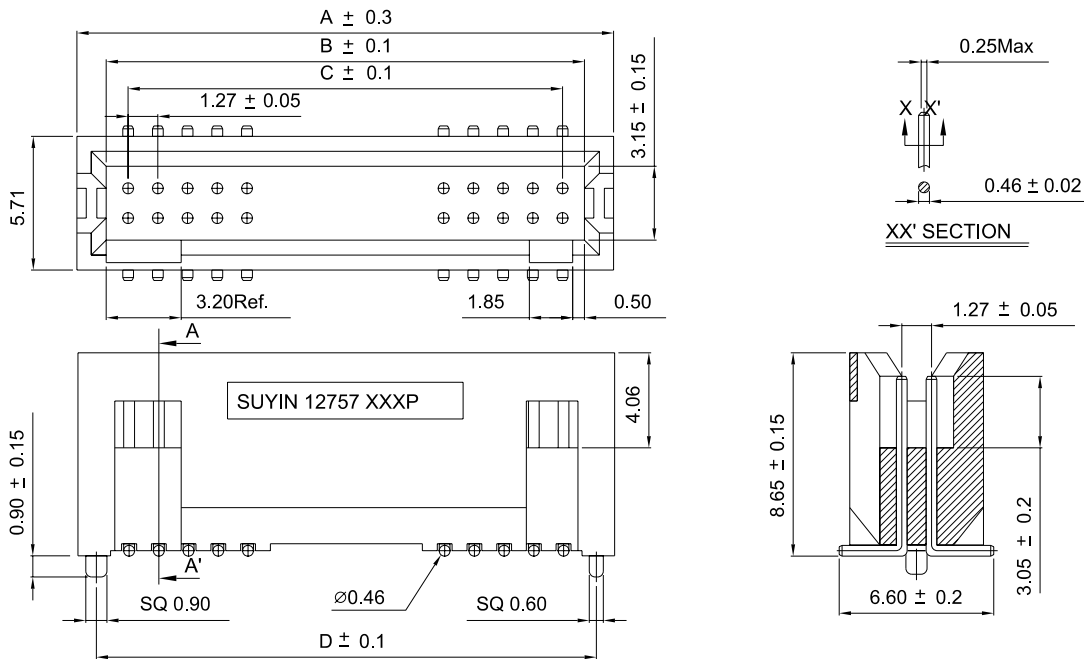

Order Information

127157MA□□□□03Z□
1 2 3 4 5

1. 'A' : Straight SMT Type
2. No. of Pins
3. Plating
4. Color 'Z' : Black
5. Package
 - 'U' : Tube Package Without CAP
 - 'R' : Reel Package With CAP
 - 'T' : Tube Package With CAP

Reference Page 11

Recommended P.C.B. Layout

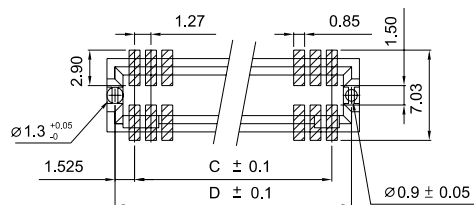

Dimensional Information I

SUYIN P/NO.	NO. PINS	DIM.A	DIM.B	DIM.C	DIM.D
127157MA010□□03Z□	10	9.45	6.95	5.08	8.13
127157MA020□□03Z□	20	15.80	13.30	11.43	14.48
127157MA030□□03Z□	30	22.15	19.65	17.78	20.83
127157MA040□□03Z□	40	28.50	26.00	24.13	27.18
127157MA050□□03Z□	50	34.85	32.35	30.48	33.53
127157MA060□□03Z□	60	41.20	38.70	36.83	39.88
127157MA070□□03Z□	70	47.55	45.05	43.18	46.23
127157MA080□□03Z□	80	53.90	51.40	49.53	52.58
127157MA090□□03Z□	90	60.25	57.75	55.88	58.93
127157MA100□□03Z□	100	66.60	64.10	62.23	65.28