

PLEASE CHECK WWW.MOLEX.COM FOR LATEST PART INFORMATION

Part Number: [0752341469](#)
Status: **Active**
Overview: [gbx_backplane_connector_system](#)
Description: Backplane Free Standing Guide Pin Use with 1.6mm-5.0mm PC Board Thickness

Documents:

[Drawing \(PDF\)](#) [RoHS Certificate of Compliance \(PDF\)](#)

General

Product Family	Backplane Connectors
Series	75234
Application	Backplane
Application Tooling Documents	Tooling Manual
Component Type	Guide
More Detailed Tech Information	I-Trac@molex.com
Overview	gbx_backplane_connector_system
Product Name	GbX®
Style	N/A

Physical

Circuits (Loaded)	N/A
Circuits (maximum)	0
Durability (mating cycles max)	200
First Mate / Last Break	No
Guide to Mating Part	Yes
Keying to Mating Part	None
Material - Metal	Stainless Steel
Number of Columns	N/A
Number of Pairs	N/A
Number of Rows	0
Orientation	Vertical
PCB Locator	No
PCB Retention	Yes
Packaging Type	Bag
Pitch - Mating Interface (in)	0.000 In
Pitch - Mating Interface (mm)	0.00 mm
Polarized to PCB	N/A
Surface Mount Compatible (SMC)	N/A
Temperature Range - Operating	105°C

Electrical

Current - Maximum per Contact	N/A
Data Rate	N/A
Shield Type	N/A
Voltage - Maximum	N/A

Material Info

Reference - Drawing Numbers

Sales Drawing	SD-75234-100
---------------	--------------

GbX is a registered trademark of Amphenol Corporation.

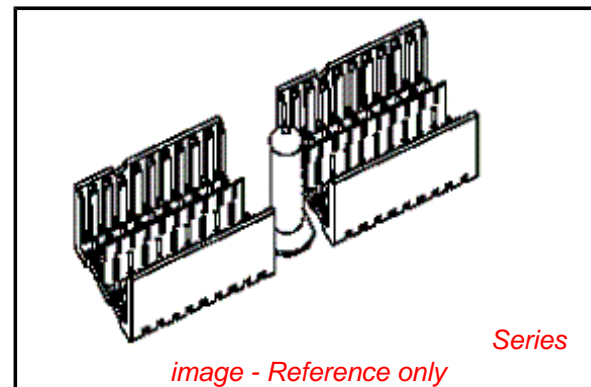

image - Reference only

EU RoHS

**ELV and RoHS
Compliant**

REACH SVHC

Contains SVHC: No

Halogen-Free

Status

Not Reviewed

**Need more information on product
environmental compliance?**

Email productcompliance@molex.com
For a multiple part number RoHS Certificate of
Compliance, [click here](#)

Please visit the [Contact Us](#) section for any
non-product compliance questions.

China RoHS



Search Parts in this Series

75234Series

- NOTES:
 1. REFER TO BACKPLANE SALES DRAWINGS FOR ROW AND COLUMN ASSIGNMENTS.
 2. INSTALLATION TORQUE SPECIFICATIONS = 2.5 - 3.0 IN-LBS.
 3. PLATED THRU HOLE TO CONNECT TO CHASSIS FOR GROUNDED GUIDE MODULE OPTION.
 4. REFER TO PS-75221-999 FOR GBX PRODUCT SPECIFICATION.
 5. 4-PAIR CONNECTORS SHOWN FOR ILLUSTRATION ONLY.

TABLE #1 - HOLE SPECIFICATIONS

FINISHED HOLE SIZE	GROUNDING	UNGROUNDING
	Ø3.48-3.63	Ø3.48-3.63
PAD	Ø 6.5	N/A
PLATED	YES	NO
DRILL (mm)	3.66mm	----
DRILL (IN)	0.144"	----

TABLE #2 - SCREW SPECIFICATIONS

SCREW P/N	DESCRIPTION	BOARD THICKNESS
73774-1000	#2-56 x 0.375" LONG SQUARE CONICAL MACHINE SCREW	1.6-5.0 mm
73774-1005	#2-56 x 0.500" LONG SQUARE CONICAL MACHINE SCREW	5.0-8.0 mm
73774-1010	#2-56 x 0.625" LONG SQUARE CONICAL MACHINE SCREW	8.0-10.0 mm

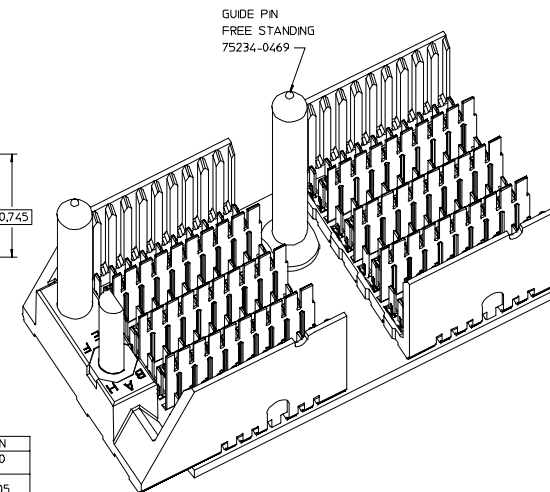
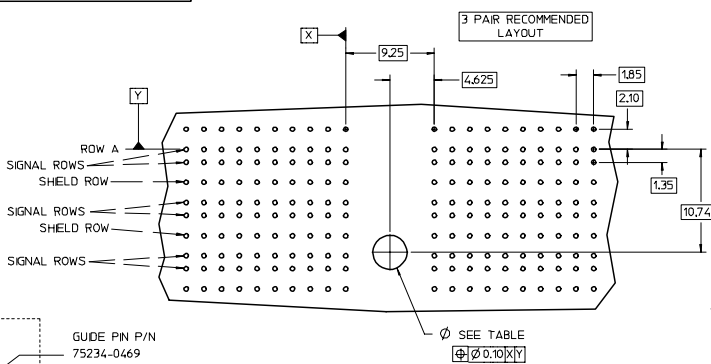
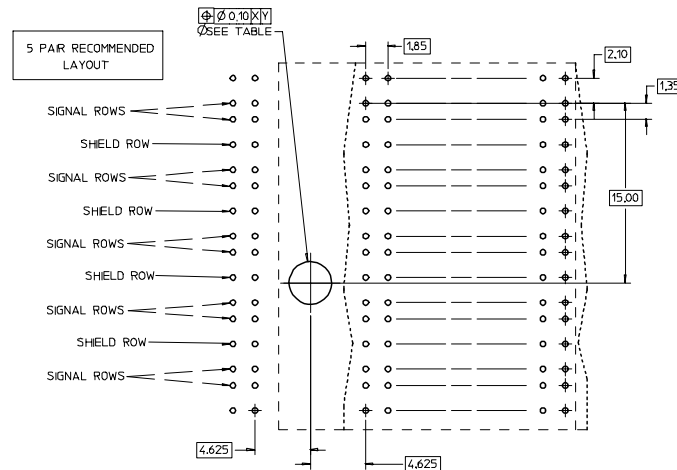
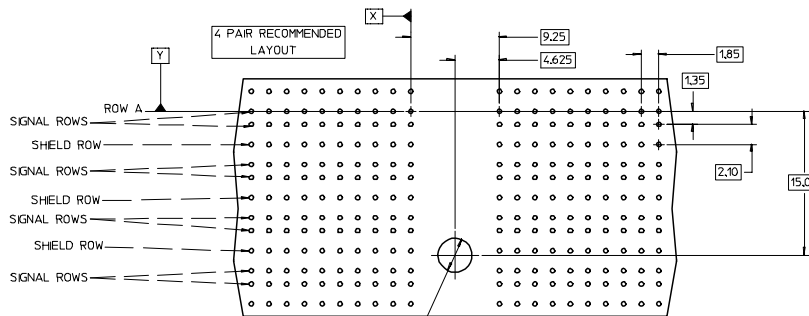

KIT P/N	BOARD THICKNESS	GUIDE PIN P/N	SCREW P/N
75234-1469	1.6 - 5.0mm	75234-0469	73774-1000
75234-2469	5.0-8.0 mm	75234-0469	73774-1005
75234-3469	8.0-10.0 mm	75234-0469	73774-1010

PRE-RELEASED
 PENDING CUSTOMER APPROVAL
 2007/10/17

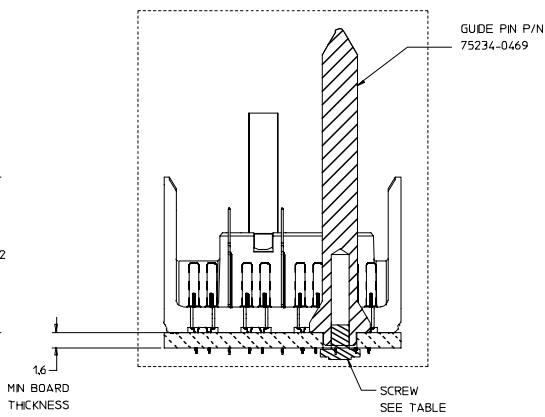
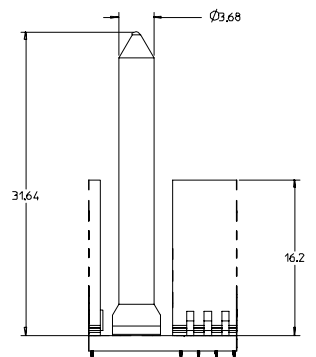
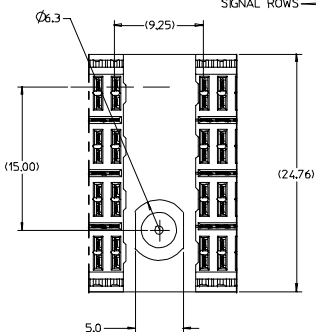

REVISED (INORD) EC NO: UCP2008-0890 DRWN: BINGHAM 2007/11/15 CHKD: 2007/11/16 APPR: JLAURX 2007/11/16 B1	QUALITY SYMBOLS	GENERAL TOLERANCES (UNLESS SPECIFIED)	SCALE 4:1	DESIGN UNITS METRIC	THIRD ANGLE PROJECTION	REVISE ON CAD ONLY
	0.0 0.0 DRAFT WHERE APPLICABLE MUST REMAIN WITHIN DIMENSIONS	mm INCH 4 PLACES ± --- ± --- 3 PLACES ± --- ± --- 2 PLACES ± 0.13 ± --- 1 PLACE ± 0.25 ± --- ANGULAR ± --- °	DIMENSION STYLE MM ONLY DRAWN BY NMARTIN DATE 2004/01/15 CHECKED BY JLAURX DATE 2004/01/15 APPROVED BY SREED DATE 2004/01/15	TITLE	MATERIAL NO.	DOCUMENT NO.
			GBX BACKPLANE FREE STANDING GUIDE PIN BOARD LAYOUT DRAWING		Molex INCORPORATED SEE CHART SD-75234-100	1 OF 1
THIS DRAWING CONTAINS INFORMATION THAT IS PROPRIETARY TO MOLEX INCORPORATED AND SHOULD NOT BE USED WITHOUT WRITTEN PERMISSION						