

PDM-21(M) Series 0° POWER DIVIDERS / COMBINERS

0.5 to 18 GHz / 2-Way / Uniform Phase & Ampli. Bal. / High Isolation & Low Insertion Loss / SMA

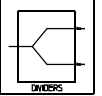

PRINCIPAL SPECIFICATIONS

Model Number	Freq. Range, GHz	Isolation, dB, Min.	Insertion Loss, dB, Max.	Phase Balance, Max.	Amplitude Bal., dB, Max.	VSWR, Max.		CW Input, W, Load VSWR out			Outline Drawing Ref.
						In	Out	1.2:1	2.0:1	∞	
PDM-21M-.75G	0.5 - 1.0	22	0.20	2°	0.2	1.20:1	1.10:1	10	1	0.1	4
PDM-21M-1.5G	1.0 - 2.0	22	0.25	3°	0.2	1.25:1	1.20:1	10	1	0.1	2
PDM-21M-3G	2.0 - 4.0	20	0.30	4°	0.2	1.30:1	1.25:1	10	1	0.1	2
PDM-21M-4G	3.0 - 5.0	20	0.35	4°	0.2	1.30:1	1.30:1	10	1	0.1	2
PDM-21M-6G	4.0 - 8.0	20	0.30	4°	0.2	1.30:1	1.25:1	10	1	0.1	1
PDM-21M-10G	8.0 - 12.4	20	0.50	4°	0.2	1.30:1	1.35:1	10	1	0.1	1
PDM-21M-15G	12 - 18	20	0.60	5°	0.2	1.35:1	1.40:1	10	1	0.1	1

Package Outline

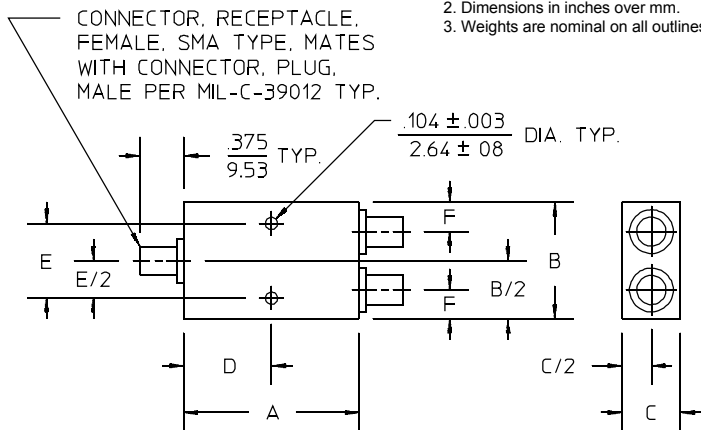

OUTLINE	A	B	C	D	E	F	WT. OZ. (G)
1	$\frac{1.000}{25.40}$	$\frac{1.000}{25.40}$	$\frac{.500}{12.70}$	$\frac{.500}{12.70}$	$\frac{.640}{16.26}$	$\frac{.250}{6.35}$.99 (28)
2	$\frac{1.500}{38.10}$	$\frac{1.500}{38.10}$	$\frac{.500}{12.70}$	$\frac{.750}{19.05}$	$\frac{1.310}{33.27}$	$\frac{.250}{6.35}$	1.94 (55)
4	$\frac{1.500}{38.10}$	$\frac{2.500}{63.50}$	$\frac{.500}{12.70}$	$\frac{.530}{13.46}$	$\frac{2.310}{58.67}$	$\frac{.750}{19.05}$	3.00 (85)

GENERAL SPECIFICATIONS

Impedance: 50 Ω nom.
 Operating Temperature: -55° to +85°C

General Notes:

- The PDM-21(M) series of 2-way In-Phase Power Dividers/Combiners covers 500 MHz to 18 GHz in octave bands. Each uses a conventional Wilkinson design which provides high isolation and low VSWR.
- Etched PTFE fiberglass stripline circuits are encased in a miniature machined housing that minimizes moding and provides an effective RF shield.
- These units are generally available from catalog stock for fast delivery.

10/22/08