

SPECIFICATION FOR APPROVAL

REF :

PAGE: 1

| | | | |
|------------|--------------------|----------------|------------------|
| PROD. NAME | SMD POWER INDUCTOR | ABC'S DWG NO. | SB2206□□□□L□-□□□ |
| | | ABC'S ITEM NO. | |

CONFIGURATION & DIMENSIONS :

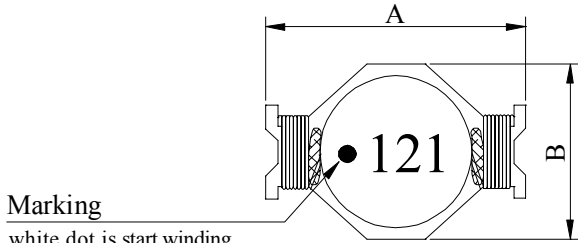

| | | | |
|---|---|-------------|-----|
| A | : | 22.0 ±0.3 | m/m |
| B | : | 15.0 ±0.3 | m/m |
| C | : | 6.8 ±0.5 | m/m |
| D | : | 15.0 (typ.) | m/m |
| E | : | 2.3 (typ.) | m/m |
| F | : | 8.0 (typ.) | m/m |

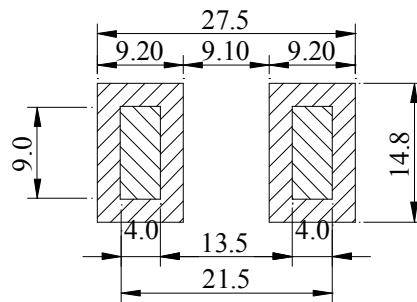
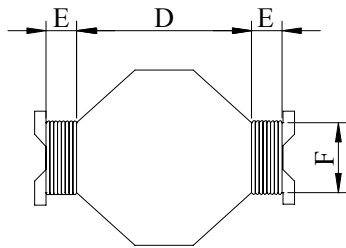

(PCB Pattern)

SCHEMATIC DIAGRAM :

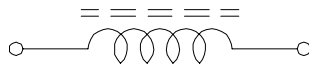

MATERIALS :

- a . Core : Ferrite DR core
- b . Wire : Enamelled copper wire (class F)
- c . Base : Hitachi phenolic CP-J-8700
- d . Adhesive : Epoxy resin
- e . Terminal : Cu/Sn
- f . Remark : Products comply with RoHS' requirements

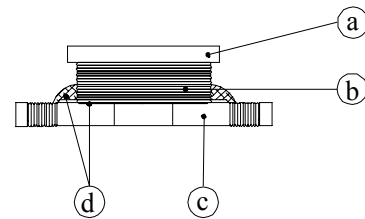

Peak Temp : 260 max.
Max time above 230 : 50sec max.
Max time above 200 : 70sec max.

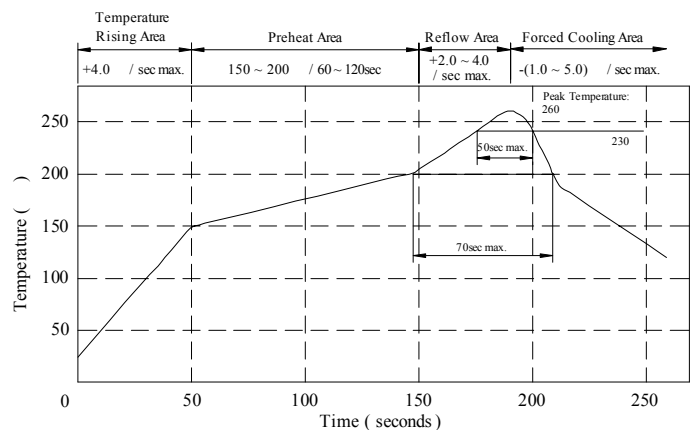

GENERAL SPECIFICATION :

- a . Temp. rise : 40 max.
- b . Storage temp. : -40 ~ +125
- c . Operating temp. : -40 ~ +105
- d . Resistance to solder heat : 260 . 10 secs.

AE-001A

SPECIFICATION FOR APPROVAL

REF :

PAGE: 2

| | | | |
|------------|--------------------|----------------|------------------|
| PROD. NAME | SMD POWER INDUCTOR | ABC'S DWG NO. | SB2206□□□□L□-□□□ |
| | | ABC'S ITEM NO. | |

. ELECTRICAL CHARACTERISTICS :

| DWG NO. | Inductance (μ H) 0.1V/100KHz | Q ref. | SRF (MHz) nom. | RDC (m Ω) max. | Irms (A) max. T = 40 | Ipk (A) typ. L / L0A = 10% |
|------------------|---|-----------|----------------------|------------------------------|-------------------------|-------------------------------|
| SB2206121KL□-□□□ | 120 \pm 10% | 20 | 5.00 | 230 | 1.60 | 3.0 |
| SB2206151KL□-□□□ | 150 \pm 10% | 19 | 4.87 | 250 | 1.50 | 2.6 |
| SB2206181KL□-□□□ | 180 \pm 10% | 17 | 4.65 | 300 | 1.30 | 2.5 |
| SB2206221KL□-□□□ | 220 \pm 10% | 19 | 3.97 | 380 | 1.20 | 2.4 |
| SB2206271KL□-□□□ | 270 \pm 10% | 22 | 3.37 | 470 | 1.10 | 2.2 |
| SB2206331KL□-□□□ | 330 \pm 10% | 20 | 3.15 | 560 | 1.00 | 1.9 |
| SB2206391KL□-□□□ | 390 \pm 10% | 21 | 3.00 | 680 | 0.90 | 1.7 |
| SB2206471KL□-□□□ | 470 \pm 10% | 25 | 2.55 | 850 | 0.82 | 1.4 |
| SB2206561KL□-□□□ | 560 \pm 10% | 23 | 2.40 | 1000 | 0.78 | 1.3 |
| SB2206681KL□-□□□ | 680 \pm 10% | 25 | 2.50 | 1100 | 0.72 | 1.2 |
| SB2206821KL□-□□□ | 820 \pm 10% | 25 | 1.97 | 1400 | 0.64 | 1.1 |
| SB2206102KL□-□□□ | 1000 \pm 10% | 25 | 1.60 | 1800 | 0.56 | 1.0 |

- 1). □ : Packaging information... A Bulk B Taping Reel
- 2). "- □□□":Reference code
- 3). Irms base on Temp. rise 40 max.
- 4). Ipk base on L/L0A=10% typ.
- 5). L,Q Test Frequency : 100KHz / 0.1V

@ Inductance VS. DC Current Curve

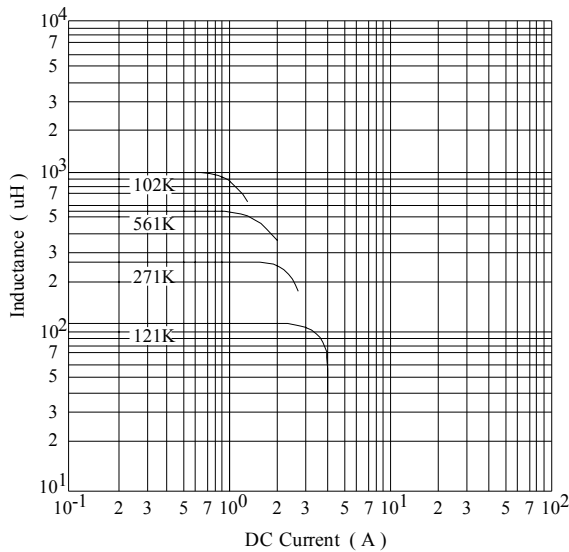

@ DC Current VS. Temp. Rise Curve

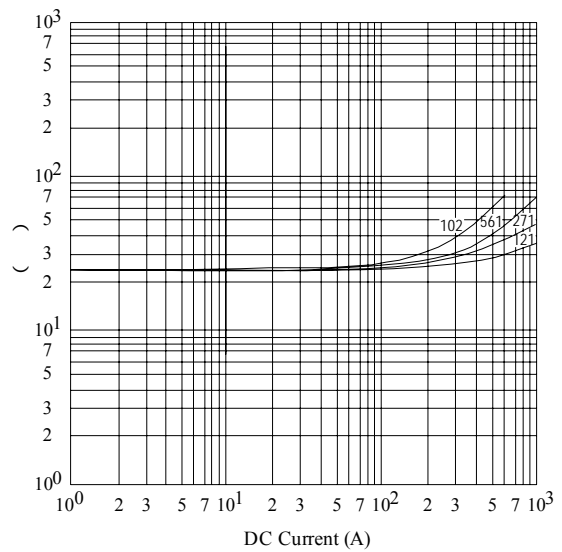

AE-001A

SPECIFICATION FOR APPROVAL

REF :

PAGE: 3

| | | | |
|------------|--------------------|----------------|------------------|
| PROD. NAME | SMD POWER INDUCTOR | ABC'S DWG NO. | SB2206□□□□L□-□□□ |
| | | ABC'S ITEM NO. | |

PACKAGING INFORMATION :

1. Configuration :

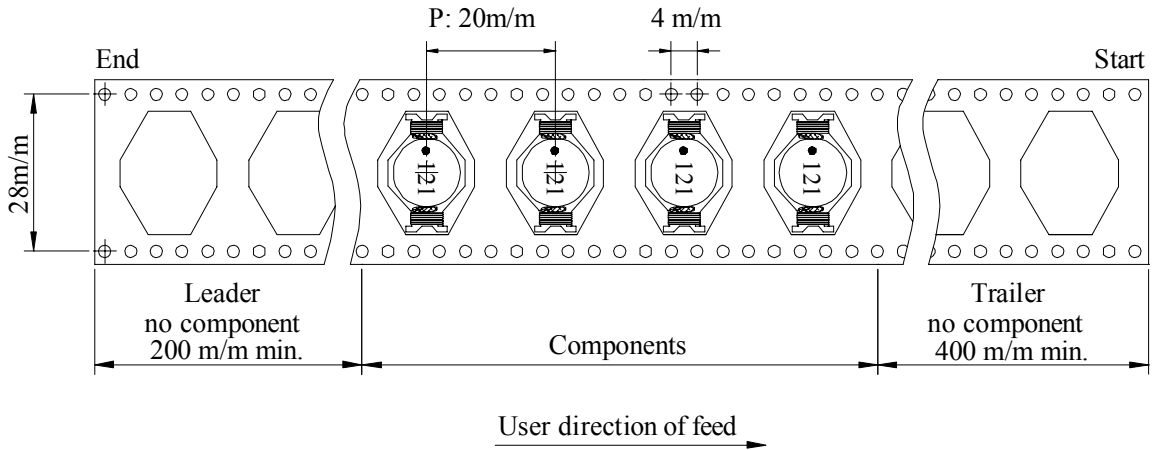
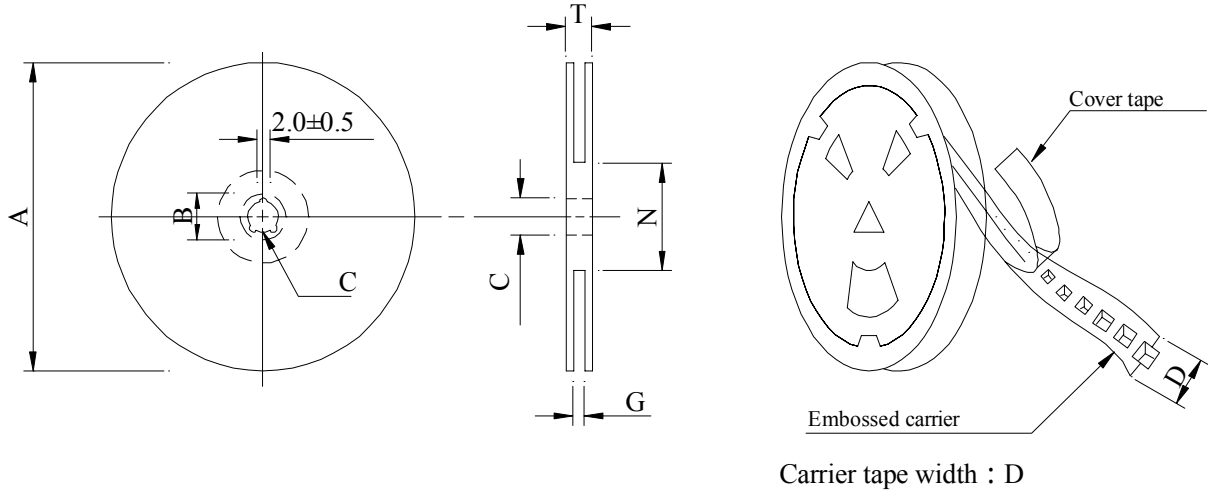

2. Dimensions : (m/m)

| Style | A | B | C | D | G | N | T |
|---------|-----|--------|--------|----|------------------|-------------------|------|
| 13 - 32 | 330 | 21±0.8 | 13±0.5 | 32 | 34 ⁺⁰ | 100 ⁻⁰ | 38.4 |

3. Q'TY & G.W. Per package :

| Series | Inner : Reel | | | Outer : Carton | | |
|--------|--------------|-----------|---------|----------------|-----------|--------------|
| | Q'TY (pcs) | G.W. (gw) | Style | Q'TY (pcs) | G.W. (kg) | Size (cm) |
| SB2206 | 250 | 1,250 | 13 - 32 | 1,000 | 6.8 | 40 x 40 x 24 |

AE-001A

SPECIFICATION FOR APPROVAL

REF :

PAGE: 5

| | | | |
|---------------|--------------------|----------------|------------------|
| PROD. NAME | SMD POWER INDUCTOR | ABC'S DWG NO. | SB2206□□□□L□-□□□ |
| | | ABC'S ITEM NO. | |

. RELIABILITY TEST :

| Test item | Specification | Test condition | | | | | | | | | | | | | | | |
|---------------------------------------|---|---|------------|--------|-------|------------|--|------------|--|--|--|------------|--------|------|------------|--|------------|
| Solderability | More than 90% of the terminal electrode shall be covered with fresh solder. | Preheat : 150±25 for 60 seconds Solder : Sn96.5 / Ag3 / Cu0.5 or equivalent Solder temp. : 235±5 Flux : Rosin Dip time : 4±1 seconds | | | | | | | | | | | | | | | |
| Thermal shock test (Temp. cycle) | Inductance shall not change more than ±20% | <table style="width: 100%; border: none;"> <tr> <td style="border: none;">Room temp.</td> <td style="border: none; text-align: center;">—————></td> <td style="border: none; text-align: center;">-25±2</td> </tr> <tr> <td style="border: none;">15 minutes</td> <td style="border: none;"></td> <td style="border: none; text-align: center;">30 minutes</td> </tr> <tr> <td colspan="3" style="border: none;"> </td> </tr> <tr> <td style="border: none;">Room temp.</td> <td style="border: none; text-align: center;">—————></td> <td style="border: none; text-align: center;">85±2</td> </tr> <tr> <td style="border: none;">15 minutes</td> <td style="border: none;"></td> <td style="border: none; text-align: center;">30 minutes</td> </tr> </table> <p>Total : 50 cycles</p> | Room temp. | —————> | -25±2 | 15 minutes | | 30 minutes | | | | Room temp. | —————> | 85±2 | 15 minutes | | 30 minutes |
| Room temp. | —————> | -25±2 | | | | | | | | | | | | | | | |
| 15 minutes | | 30 minutes | | | | | | | | | | | | | | | |
| | | | | | | | | | | | | | | | | | |
| Room temp. | —————> | 85±2 | | | | | | | | | | | | | | | |
| 15 minutes | | 30 minutes | | | | | | | | | | | | | | | |
| Humidity Resistance test | | Temperature : 40±2 Humidity : 90 ~ 95% Applied current : Per spec. Time : 500 hours | | | | | | | | | | | | | | | |
| High temp. Resistance test | | Temperature : 105±2 Applied current : Per spec. Time : 500 hours | | | | | | | | | | | | | | | |

AE-001A



