

# DVS-640

## Industrial grade 4U, Core™ 2 Duo DVR Platform with Optional Video Capture Card



### Features

- 4U industrial grade DVR Platform
- Advanced cooling design for capture card and hard drive
- Performance Core™2 Duo DVR platform
- Compatibility and certification test for various video capture cards
- Dual Gigabit Ethernet delivers excellent network performance
- Visible LED indicators and audible alarm notification improves system availability and is easy to maintain with air filter
- Shock-resistant disk drive bay holds three 5.25" and one 3.5" front-accessible disk drives
- 8/16/24/32 channels video input
- H.264 , MPEG4 Hardware Compression / MPEG-4 Software Compression

### Introduction

The DVS-640 is a high performance video surveillance platform with 4U industrial chassis. It includes an optimized cooling system to improve the thermal performance when installing multiple video capture cards and hard drives. Combined with industrial main boards with longevity support, the DVS-640 offers a wide range performance requirement from Celeron D to Core 2 Duo processors. Advantech's quality assurance integration tests and certifications for different video capture cards ensures best reliability for 24/7 operation.

### Specifications

Computing System	Chipset	Intel® 945G + ICH7R
	Processor (configurable)	Core 2 Duo/ Pentium 4/ Celeron D Processor
	Front Side Bus	533/800/1066 MHz
	L2 Cache	4MB (Core 2 Duo), 2MB/1MB (P-4), 512KB/256KB(Celeron-D)
	Memory (configurable)	Supports up to 4GB DDR2 667 Dual Channel
Graphics	Controller	Intel® 945G Integrated
	VRAM	Chipset integrated VGA controller sharing 224 MB system memory
Expansion Slots	PCI	32-bit/33MHz, 5 slot
	PCI Express x1	1.0 GB/s per direction, 1 slot
	PCI Express x16	4.0 GB/s per direction, 1 slot
Storage	Optical Drive (configurable)	1 x 5.25" SATA DVD+/-RW
	Hard Disk Drive (configurable)	3 x SATA HDD
Drive Bays	5.25" (front -accessible)	3 (reserved for Optical Drive and HDD mobile rack)
	3.5" (front-accessible)	1 (reserved for FDD)
Ethernet	Interface	10/100/1000Base-T Gigabit Ethernet
	Controller	G-LAN1: Intel 82573, G-LAN2: Intel 82573
I/O Ports	Front I/O Ports	2 x USB, 1 x PS/2
	Rear I/O Ports	4 x USB, 2 x PS/2, 2 x COM, 1 x Parallel, 1 x VGA, 2 x RJ-45, 1 x LINE-Out, 1 x MIC-In, 1 x LINE-In
Power Supply	Power Output Wattage	400 W
	Type	Single or Redundant ATX Auto-Switching with Power Factor Correction (PFC)
Cooling	Chassis Fan	3
	Air Filter	Yes
Environment	Temperature	Operating 0 ~ 40°C (32°F ~ 104°F), Non-Operating -20 ~ 60°C (-4°F ~ 140°F)
	Humidity	Operating 10 ~ 85% @ 40°C non-condensing, Non-Operating 10 ~ 95% @ 40°C non-condensing
Physical Characteristics	Color	Black
	Dimensions (W x H x D)	482 x 177 x 480 mm (19" x 7" x 18.9")
Slide Rail	(Optional and configurable)	20" to 28"
Operating Systems	(Optional and configurable)	Microsoft® Windows® XP Professional version, Microsoft® Windows® XP Embedded (upon request)
Watchdog Timer	Output	Interrupt, system reset
	Interval	Programmable 1 ~ 255 sec

## Dimensions

Unit: mm (inch)

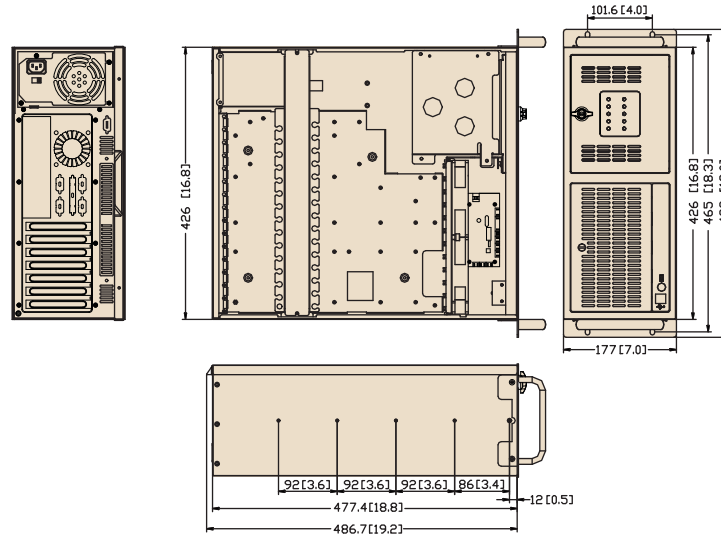

## Configure to Order Services

Please visit Advantech CTOS portal for order entry  
<http://www.advantech.com.tw/CTOS>

## System Content

Item	Description
Chassis	Industrial 4U DVR Chassis
Motherboard	Intel 945G ATX Main board
Power system	400W ATX
CPU cooler	LGA775 UP TO 3.8GHz

## Front View



## Two 85-CFM Cooling Fans



## Inside View



## Rear View

