



MS-328-6 Power Reed Sensor • Flatpack

Electrical Characteristics

| | | |
|-----------------------------------|--------|------------------|
| Contact form | | A |
| Contact rating max. | W / VA | 50 |
| Switching current max. | A | 1.5 |
| Carry current max. | A | 2.0 |
| Switching voltage max. | VDC | 200 |
| | VAC | 250 |
| Breakdown voltage min. | VDC | 400 |
| Contact resistance (initial) max. | mΩ | 100 |
| Insulation resistance min. | Ω | 10 ¹⁰ |
| Capacitance typ. | pF | 0.5 |

Magnetical Characteristics

| | | |
|--------------------------------------|----|-------|
| Pull in range available ¹ | AT | 25-40 |
|--------------------------------------|----|-------|

¹ AT range stated for unmodified Reed Switch

Operating Characteristics

| | | |
|----------------------------------|----|------------|
| Operate time (incl. bounce) max. | ms | 1.0 |
| Release time max. | ms | 0.4 |
| Switching frequency max. | Hz | 300 |
| Resonant frequency typ. | Hz | 2,600 |
| Vibration (50-2000 Hz) | g | 20 |
| Shock (1/2 sin 11 ms) | g | 50 |
| Operating temperature | °C | -20 to +85 |

Dimensions

in mm

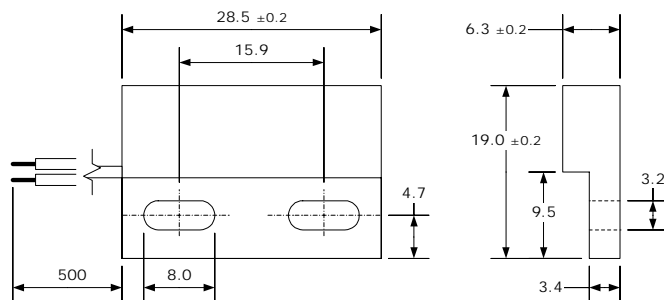

Wire: AWG 20, black, stripped and tinned

Ordering Information

| Series | AT Range |
|----------|-----------------------------------|
| MS-328-5 | 4 = 25-30 / 5 = 30-35 / 6 = 35-40 |

Ordering example: MS-328-6-4 describes MS-328-6 with 25-30 AT

Customized types available.

MS-328-6

Power Reed Sensor • Flatpack



Matching Actuator MSM-328

in mm

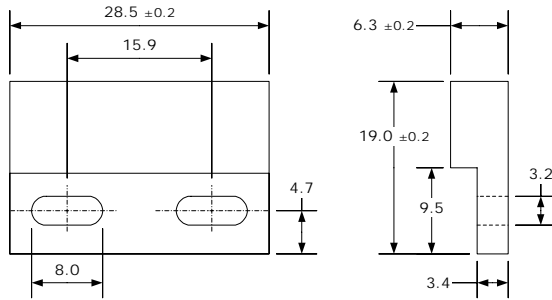

Customized types and other magnet orientations available.