



PRESS FIT AUTOMOTIVE RECTIFIER

LPB501 THRU LPB506
LPBS501 THRU LPBS506

VOLTAGE RANGE 100 to 600 Volts

CURRENT 50.0 Amperes

TECHNICAL SPECIFICATION:

FEATURES

- Low Leakage
- Low forward voltage drop
- High current capability
- High forward surge current capacity

MECHANICAL DATA

- Technology: Cell with Vacuum soldered
- Case: Copper case
- Polarity: As marked of case bottom
- Lead: Plated lead, solderable per MIL-STD-202E method 208C
- Mounting: Press Fit
- Weight: 0.17 ounces, 4.84 grams (LPB)
- Weight: 0.14 ounces, 3.96 grams (LPBS)

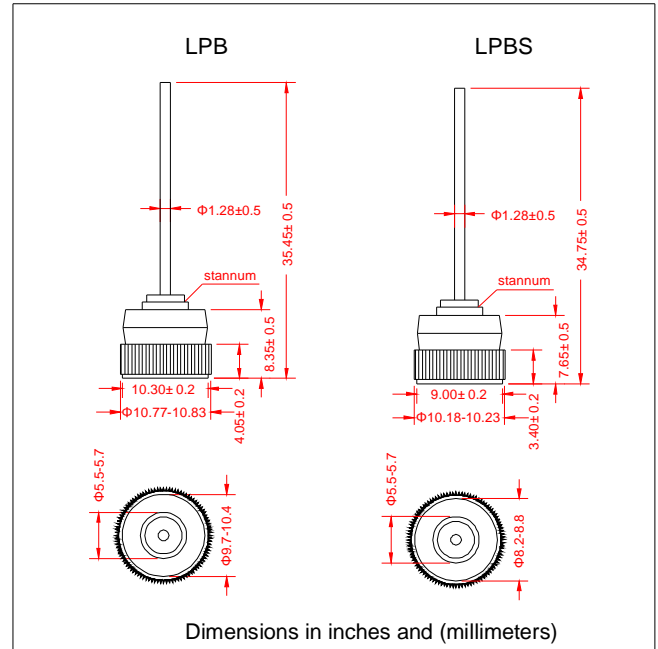

MAXIMUM RATINGS AND ELECTRICAL CHARACTERISTICS

- Ratings at 25°C ambient temperature unless otherwise specified
- Single Phase, half wave, 60HZ, resistive or inductive load
- For capacitive load derate current by 20%

	SYMBOLS	LPB501 LPBS501	LPB502 LPBS502	LPB504 LPBS504	LPB506 LPBS506	UNIT
Maximum Repetitive Peak Reverse Voltage	V_{RRM}	100	200	400	600	Volts
Maximum RMS Voltage	V_{RMS}	70	140	280	420	Volts
Maximum DC Blocking Voltage	V_{DC}	100	200	400	600	Volts
Maximum Average Forward Rectified Current, At $T_c=105^\circ\text{C}$	$I_{(AV)}$	50				Amps
Peak Forward Surge Current 3.3mS single half sine wave superimposed on Rated load (JEDEC method)	I_{FSM}	600				Amps
Rating for fusing ($t < 8.3\text{ms}$)	I^2t	1494				A^2S
Maximum instantaneous Forward Voltage at 100A	V_F	1.08				Volts
Maximum DC Reverse Current at Rated $T_A=25^\circ\text{C}$ DC Blocking Voltage $T_A=100^\circ\text{C}$	I_R	5.0				UA
		400				
Typical Thermal Resistance	$R_{\theta JC}$	0.8				$^\circ\text{C}/\text{W}$
Operating and Storage Temperature Range	T_J, T_{STG}	(-65 to +175)				$^\circ\text{C}$
Polarity and voltage demotion color band (button)		Yellow	Silver	Orange	Green	

Notes:

1. Enough heatsink must be considered in application.



PRESS FIT AUTOMOTIVE RECTIFIER

LPB501 THRU LPB506
LPBS501 THRU LPBS506

VOLTAGE RANGE 100 to 600 Volts
CURRENT 50.0 Amperes

RATINGS AND CHARACTERISTIC CURVES LPB501 THRU LPB506 LPBS501 THRU LPBS506

FIG.1 TYPICAL FORWARD CURRENT DERATING CURVE

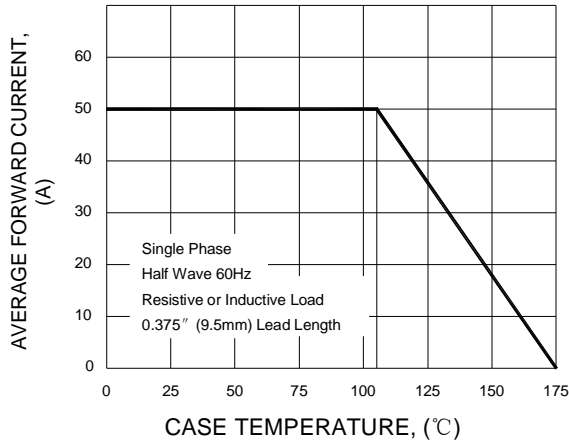

FIG.2 MAXIMUM NON-REPETITIVE PEAK FORWARD SURGE CURRENT

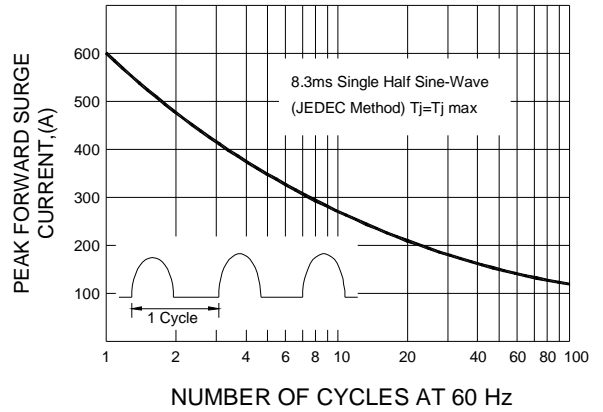

FIG.3 TYPICAL INSTANTANEOUS FORWARD CHARACTERISTICS

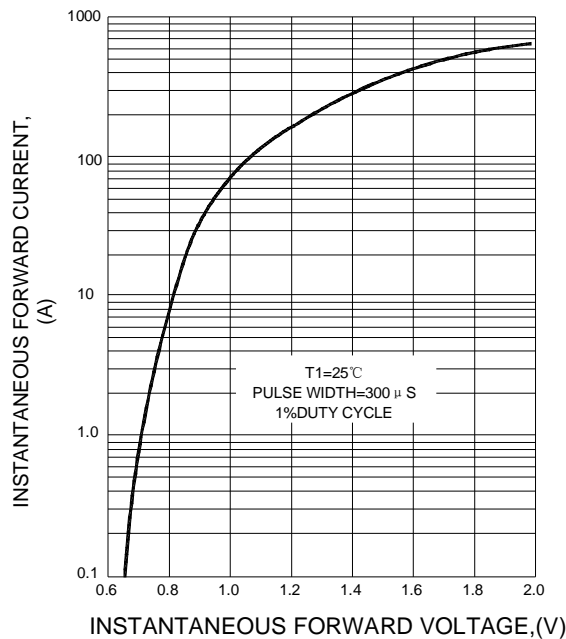

FIG.4 FORWARD POWER DISSIPATION

