

INTRODUCTION:

Adam Tech Right Angle PCB High Density D-Sub connectors are a popular interface for many I/O applications. Offered in 15, 26, 44, 62 and 78 positions they are a good choice for a low cost industry standard high density connection. Adam Tech connectors are manufactured with precision stamped contacts offering a choice of contact plating and a wide selection of mating and mounting options.

FEATURES:

- High Density in standard size shell
- Industry standard compatibility
- Durable metal shell design
- Precision formed contacts
- Variety of Mating and mounting options

MATING CONNECTORS:

Adam Tech high density D-Subminiatures and all industry standard high density D-Subminiature connectors.

SPECIFICATIONS:

Material:

Standard insulator: PBT, 30% glass reinforced, rated UL94V-0
Optional Hi-Temp insulator: Nylon 6T rated UL94V-0
Insulator Colors: HDL Series: Black
HDVG Series: Blue

Contacts: Phosphor Bronze
Shell: Steel, Tin or Zinc plated
Hardware: Brass, Nickel plated

Contact Plating:

Gold Flash (15 and 30 μ m Optional) over Nickel underplate overall.

Electrical:

Operating voltage: 250V AC / DC max.
Current rating: 5 Amps max.
Contact resistance: 20 m Ω max initial
Insulation resistance: 5000 M Ω min.
Dielectric withstanding voltage: 1000V AC for 1 minute

Mechanical:

Insertion force: 0.75 lbs max
Extraction force: 0.44 lbs min

Temperature Rating:

Operating temperature: -65°C to +125°C
Soldering process temperature:
Standard insulator: 235°C
Hi-Temp insulator: 260°C

PACKAGING:

Anti-ESD plastic trays

APPROVALS AND CERTIFICATIONS:

UL Recognized File No. E224053
CSA Certified File No. LR1578596



ORDERING INFORMATION



SERIES INDICATOR

HDL = High Density D-Sub
HDVG = High Density VESA connector with recessed #9 pin and blue insulator

POSITIONS

15, 26, 44, 62, 78

MOUNT OPTIONS

A = #4-40 Jackscrews and forked boardlocks
B = #4-40 Flush threaded inserts and forked boardlocks
C = #4-40 Flush threaded inserts with removable jackscrews and forked boardlocks
D = Topside ground straps with screw holes

CONTACT TYPE

PL = Plug, Right Angle Mount
SL = Socket, Right Angle Mount

OPTIONS:

Add designator(s) to end of part number

- 15** = 15 μ m gold plating in contact area
- 30** = 30 μ m gold plating in contact area
- EMI** = Ferrite filtered version for EMI / RFI suppression (Page 101)
- F** = Retention 4 prong boardlocks
- HT** = Hi-Temp insulator for Hi-Temp soldering processes up to 260°C
- R** = Round Riveted Jackscrews

PLUG

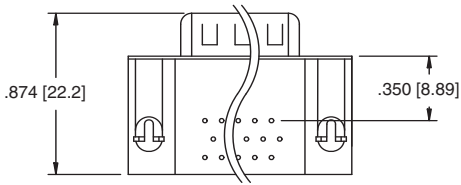
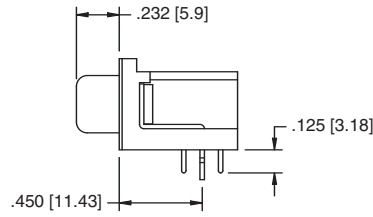
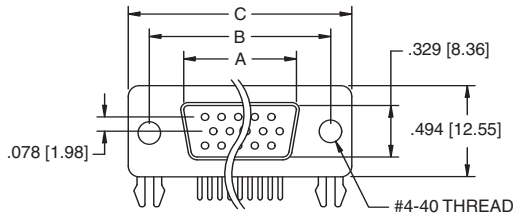

HDL15-PL-B

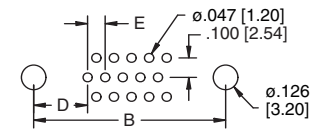

15 Position PCB Layout

SOCKET

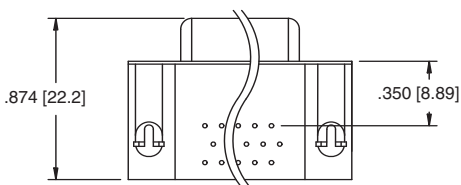
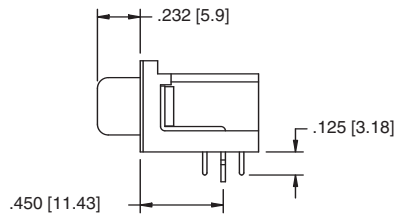
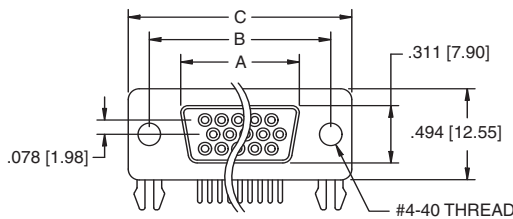

HDL15-SL-B

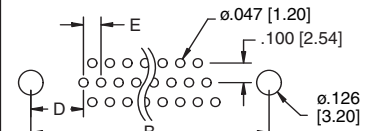

26, 44, 62 Position PCB Layout

Hi Density Video Graphics Connector

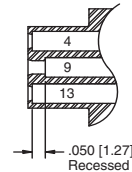

HDVG-15-SL-B

Unit: Inch [mm]

| Positions | PLUG | SOCKET | DIMENSIONS | | | |
|-----------|---------------|---------------|---------------|---------------|-------------|-------------|
| | A | A | B | C | D | E |
| 15 | .666 [16.92] | .643 [16.33] | .984 [24.99] | 1.213 [30.81] | .277 [7.04] | .090 [2.29] |
| 26 | .994 [25.25] | .971 [24.66] | 1.312 [33.32] | 1.541 [39.14] | .277 [7.04] | .090 [2.29] |
| 44 | 1.534 [38.96] | 1.511 [38.38] | 1.852 [47.04] | 2.088 [53.04] | .277 [7.04] | .090 [2.29] |
| 62 | 2.182 [55.43] | 2.159 [54.84] | 2.500 [63.50] | 2.729 [69.32] | .276 [7.00] | .095 [2.41] |
| 78 | 2.079 [52.81] | 2.064 [52.43] | 2.406 [61.11] | 2.635 [66.93] | .300 [7.63] | .095 [2.41] |