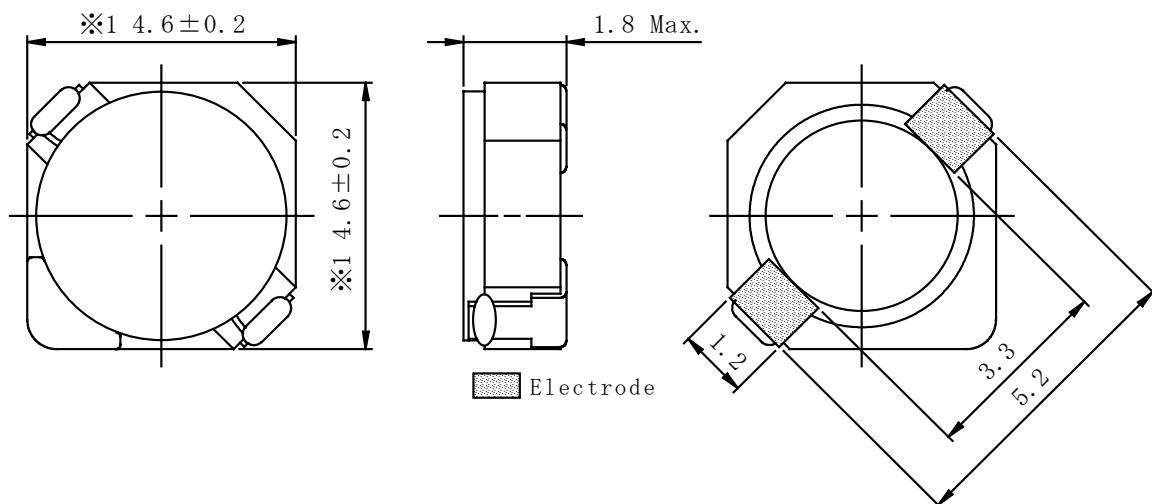
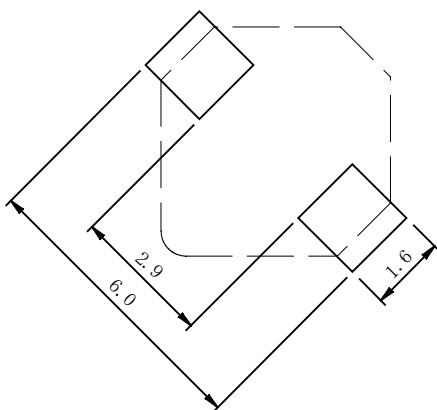

**Type: CDRH4D16**
**◆ Product Description**

- 4.8×4.8mm Max.(L×W),1.8mm Max.Height.
- Inductance Range: 3.0~100  $\mu$  H.
- Rated current range:0.29~1.75A.
- In addition to the standards versions shown here, custom inductors are also available to meet your exact requirements.

**◆ Feature**

- Magnetically shielded construction.
- Ideally used in Mobilephone,PDA,MP3,DSC/DVC,etc as DC-DC Converter inductors.
- RoHS Compliance.

**◆ Dimensions (mm)**

**◆ Land Pattern (mm)**

**Type: CDRH4D16**
**◆ Specification**

Part No. ※	Stamp	Inductance ( $\mu$ H) [Within] 1 00kHz/1V	D.C.R.(m $\Omega$ ) Max.(Typ.) (at 20°C)	Saturation Current(mA) ※1	Temperature rise current (mA) ※2
CDRH4D16NP-3R0N□	3R0	3.0 $\pm$ 25%	53(43)	1750	2300
CDRH4D16NP-4R7N□	4R7	4.7 $\pm$ 25%	75(60)	1400	1650
CDRH4D16NP-6R8N□	6R8	6.8 $\pm$ 25%	110(88)	1150	1300
CDRH4D16NP-100M□	100	10 $\pm$ 20%	155(125)	950	1050
CDRH4D16NP-150M□	150	15 $\pm$ 20%	235(190)	770	820
CDRH4D16NP-220M□	220	22 $\pm$ 20%	330(265)	640	670
CDRH4D16NP-330M□	330	33 $\pm$ 20%	490(395)	520	530
CDRH4D16NP-470M□	470	47 $\pm$ 20%	680(550)	440	470
CDRH4D16NP-680M□	680	68 $\pm$ 20%	980(790)	370	380
CDRH4D16NP-101M□	101	100 $\pm$ 20%	1480(1190)	300	290

**※ Description of Part Name**

CDRH4D16NP-3R0N□

- B Box
- C Carrier Tape

※1.Saturation Current: The DC current at which the inductance decreases to 65% of it's nominal value

※2 Temperature rise current:The DC current at which the temperature rise is  $\Delta t=40^{\circ}\text{C}$ .( $T_a=20^{\circ}\text{C}$ )