



# SAW Components

Data Sheet B7848





**SAW Components**

**B7848**

**Low-Loss Filter for Mobile Communication**

**860,5 MHz**

**Data Sheet**

**Features**

- Low-loss RF filter for iDEN phone, receive path
- Low amplitude ripple
- Usable passband 19,0 MHz
- No matching network required for operation at 50 Ω
- Ceramic package for **Surface Mounted Technology (SMT)**

**Chip sized SAW package QCS5C**

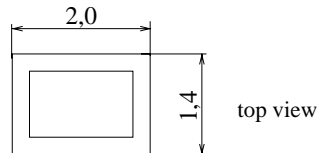
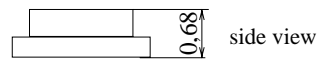
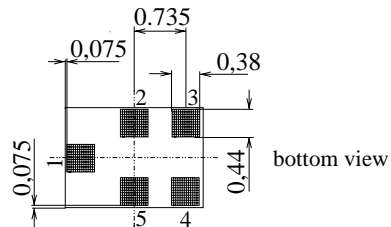

Dimensions in mm, approx. weight 0,009 g

**Terminals**

- Ni, gold-plated

**Pin configuration**

- 1 Input, unbalanced
- 4 Output, unbalanced
- 2, 5 Case ground
- 3 To be grounded

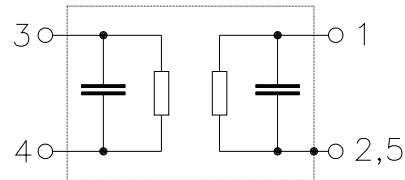

Type	Ordering code	Marking and Package according to	Packing according to
B7848	B39861-B7848-C710	C61157-A7-A111	F61074-V8151-Z000

Electrostatic Sensitive Device (ESD)

**Maximum ratings**

Operable temperature range	$T$	- 30 / + 85	°C	Machine Model, 10 pulses source impedance 50 Ω
Storage temperature range	$T_{stg}$	- 40 / + 85	°C	
DC voltage	$V_{DC}$	0	V	
ESD voltage	$V_{ESD}$	100*	V	
Source power (cw)	$P_s$	0	dBm	

\* - acc. to JESD22-A115A (Machine Model), 10 negative & 10 positive pulses



Data Sheet

Characteristics

Operating temperature range:  $T = +25 \pm 2 \text{ }^\circ\text{C}$   
 Terminating source impedance:  $Z_S = 50 \text{ } \Omega$   
 Terminating load impedance:  $Z_L = 50 \text{ } \Omega$

		min.	typ.	max.	
<b>Nominal frequency</b>	$f_N$	—	860,5	—	MHz
<b>Maximum insertion attenuation</b>	$\alpha_{max}$				
851,0 ... 870,0 MHz		—	1,9	2,7	dB
<b>Amplitude ripple (p-p)</b>	$\Delta\alpha$				
851,0 ... 870,0 MHz		—	0,5	1,0	dB
<b>Group delay ripple (p-p)</b>	$\Delta\tau$				
851,0 ... 870,0 MHz		—	20	50	ns
<b>Return loss (Input and Output)</b>					
851,0 ... 870,0 MHz		11	14	—	dB
<b>Attenuation</b>	$\alpha$				
0,100... 806,000MHz		45	55	—	dB
806,000... 825,000MHz		37	51	—	dB
896,000... 902,000MHz		28	42	—	dB
905,825... 924,825MHz		27	51	—	dB
960,650... 979,650MHz		37	57	—	dB
1070,300...1089,300MHz		47	55	—	dB
1089,300... 3000,000MHz		27	39	—	dB



**SAW Components**

**B7848**

**Low-Loss Filter for Mobile Communication**

**860,5 MHz**

**Data Sheet**

**Characteristics**

Operating temperature range:  $T = -30$  to  $+70$  °C  
 Terminating source impedance:  $Z_S = 50 \Omega$   
 Terminating load impedance:  $Z_L = 50 \Omega$

		<b>min.</b>	<b>typ.</b>	<b>max.</b>	
<b>Nominal frequency</b>	$f_N$	—	860,5	—	MHz
<b>Maximum insertion attenuation</b>	$\alpha_{max}$				
851,0 ... 870,0 MHz		—	2,2	3,0	dB
<b>Amplitude ripple (p-p)</b>	$\Delta\alpha$				
851,0 ... 870,0 MHz		—	0,6	1,0	dB
<b>Group delay ripple (p-p)</b>	$\Delta\tau$				
851,0 ... 870,0 MHz		—	30	60	ns
<b>Return loss (Input and Output)</b>					
851,0 ... 870,0 MHz		11	13	—	dB
<b>Attenuation</b>	$\alpha$				
0,100... 806,000MHz		45	55	—	dB
806,000... 825,000MHz		37	51	—	dB
896,000... 902,000MHz		28	42	—	dB
905,825... 924,825MHz		27	51	—	dB
960,650... 979,650MHz		37	57	—	dB
1070,300...1089,300MHz		47	55	—	dB
1089,300... 3000,000MHz		27	39	—	dB



Data Sheet

Transfer function

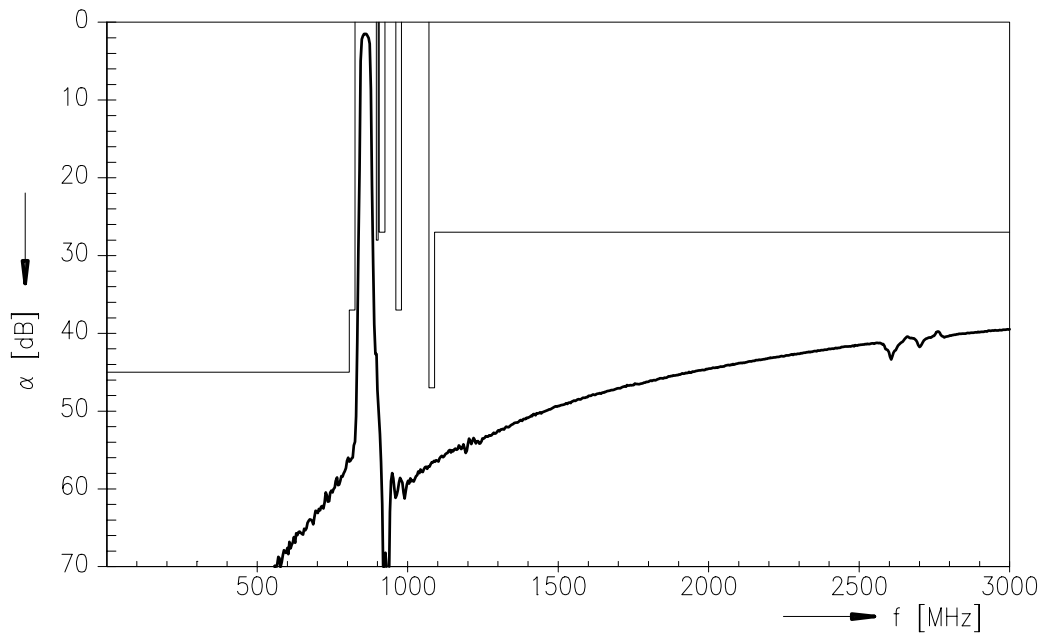

Transfer function (pass band)

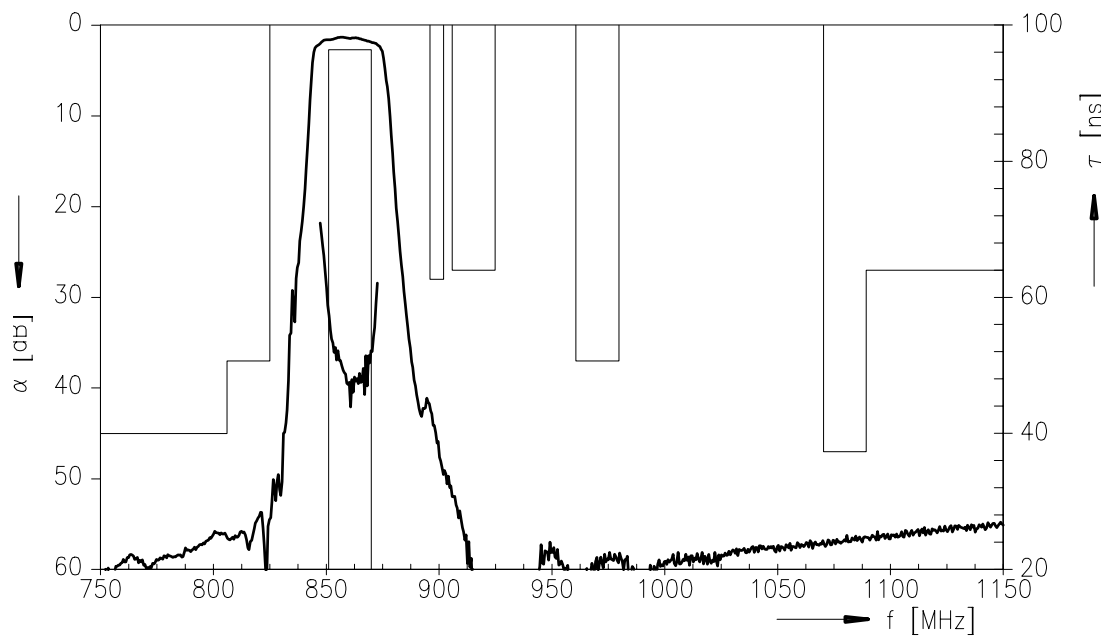



**SAW Components**

**B7848**

**Low-Loss Filter for Mobile Communication**

**860,5 MHz**

**Data Sheet**

**Published by EPCOS AG**

**Surface Acoustic Wave Components Division, SAW MC WT/IS**

**P.O. Box 80 17 09, 81617 Munich, GERMANY**

© EPCOS AG 2004. Reproduction, publication and dissemination of this brochure and the information contained therein without EPCOS' prior express consent is prohibited.

Purchase orders are subject to the General Conditions for the Supply of Products and Services of the Electrical and Electronics Industry recommended by the ZVEI (German Electrical and Electronic Manufacturers' Association), unless otherwise agreed.

This brochure replaces the previous edition.

For questions on technology, prices and delivery please contact the Sales Offices of EPCOS AG or the international Representatives.

Due to technical requirements components may contain dangerous substances. For information on the type in question please also contact one of our Sales Offices.