

Numeric Display

3 Digit 8.0mm (.3") Series

Conventional Part No. Global Part No. Lighting Color
 LN533RAMRS LNM233AS02 Red
 LN533RKMRS LNM233KS02 Red
 LN533GAMGS LNM333AS02 Green
 LN533GKMGS LNM333KS02 Green

Terminal Connection

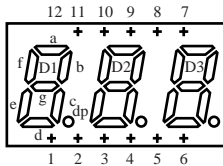

Pin No.	Assignment	Assignment
1	Cathode c	Anode c
2	Common Anode D1	Common Cathode D1
3	Cathode d	Anode d
4	Common Anode D2	Common Cathode D2
5	Common Anode D3	Common Cathode D3
6	Cathode dp	Anode dp
7	Cathode b	Anode b
8	Cathode f	Anode f
9	Cathode a	Anode a
10	Cathode e	Anode e
11	Cathode g	Anode g
12	No Pin	No Pin

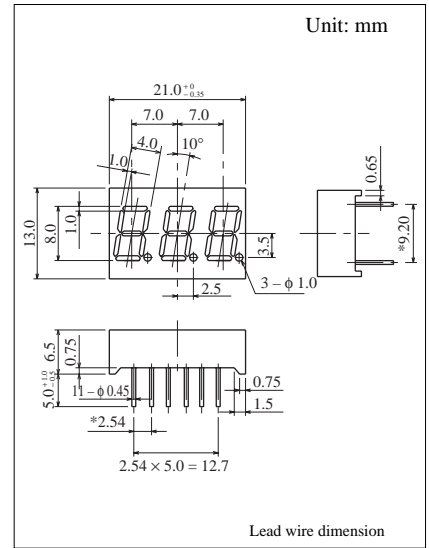

■ Absolute Maximum Ratings (T_a = 25°C)

Lighting Color	P _D (mW)	I _F (mA)	I _{FP} (mA)*	V _R (V)	T _{opr} (°C)	T _{stg} (°C)
Red	34	12	65	5	-25 ~ +80	-30 ~ +85
Green	34	12	65	5	-25 ~ +80	-30 ~ +85

I_{FP}の条件は duty 10% ,Pulse width 1 msec. The condition of I_{FP} is duty 10%, Pulse width 1 msec

■ Electro-Optical Characteristics (T_a = 25°C)

Conventional Part No.	Lighting Color	Common	I _O		I _O /d.p	I _F	V _F		λ _P	Δλ	I _F	I _R	
			Typ	Min			Typ	Typ				Max	V _R
LN533RAMRS	Red	Anode	200	70	70	5	2.03	2.8	700	100	10	10	5
LN533RKMRS	Red	Cathode	200	70	70	5	2.03	2.8	700	100	10	10	5
LN533GAMGS	Green	Anode	1000	300	300	10	2.03	2.8	565	30	10	10	5
LN533GKMGS	Green	Cathode	1000	300	300	10	2.03	2.8	565	30	10	10	5
Unit	—	—	μcd	μcd	μcd	mA	V	V	nm	nm	mA	μA	V

