

K5A2 Series Snap Action Key Switch



Features/Benefits

- Quiet actuation
- Space Saving
- RoHS compliant

Typical Applications

- Automotive
- Computers and network equipment

Construction

FUNCTION: Momentary action
CONTACT ARRANGEMENT: Normally open
TERMINALS: Gullwing type for SMT

Mechanical

OPERATING FORCE: (6N version) 5,5 + 0,5 -1N
3,7 + 0,8N -0,5N
OPERATING LIFE: 50,000 operations
TOTAL TRAVEL: 0.8 mm +/- 0.2 mm
ELECTRICAL TRAVEL: 0,5 mm +/- 0.1 mm

Packaging

Switches are delivered on continuous tape, in reels of 600 pieces

NOTE: Product to be offered as compatible with the lead free soldering profile on Q3 2006.

Note: Specifications listed above are for switches with standard options.
For information on specific and custom switches, consult Customer Service Center.

Electrical

POWER MIN / MAX: .02 VA / 1.0 VA
VOLTAGE MIN / MAX: 20 mV DC / 30 V DC
CURRENT MIN / MAX DC: 0.1mA / 50 mA
CONTACT RESISTANCE: ≤100m Ω
INSULATION RESISTANCE: ≤1 Ω
BOUNCE TIME: 5ms

Environmental

OPERATING TEMPERATURE: -40° C TO 85° C
STORAGE TEMPERATURE: -50° C TO 85° C

Process

SOLDERING: Lead free reflow compatible in accordance with CEI 60068-2-58

Materials

CONTACTS: Au over Ni
SOLDERING: Au
HOUSING: Thermoplastic UL 94 H-B

How To Order

Our easy build-a-switch concept allows you to mix and match options to create the switch you need. To order, select desired option from each category and place it in the appropriate box.

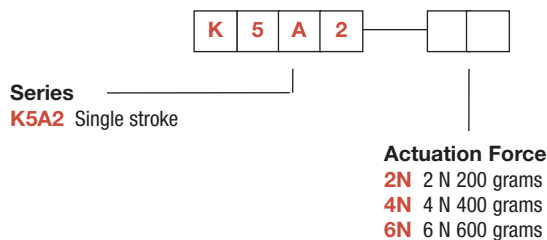

K5A2 Series Snap Action Key Switch

K5A2 WITH LED

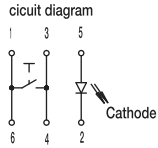
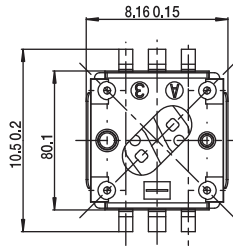

PCB LAYOUT, MOUNTING SIDE

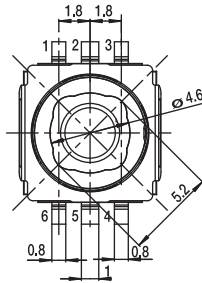
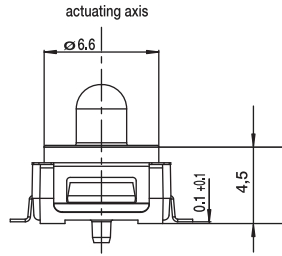
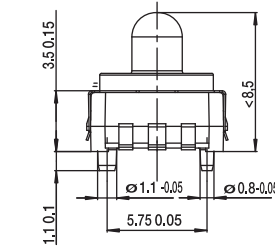
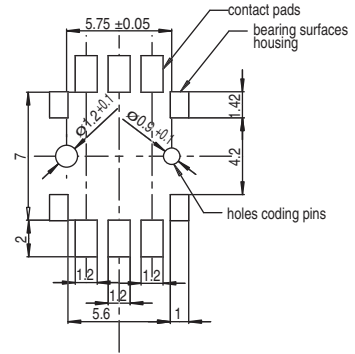

Key Switches

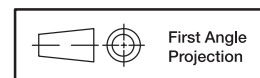

Dimensions are shown: mm (inch)
Specifications and dimensions subject to change

www.ittcannon.com