



N VF 4 - 5

26.5×26.5×25

Features

- Miniature.
- Contact load capacity up to 30A.
- Suitable for automobile.
- Terminal types as inserting.

Ordering Information

NVF4-5 C Z 30 b DC12V R

1 Part number: NVF4-5

2 Contact arrangement: A:1A

3 Enclosure: S: Sealed type; Z: Dust cover

4 Contact Current: 30:30A

5 Terminals: b: PCB type; a: plug in type

6 Coil rated Voltage(V): DC:12

7 Coil transient suppression: R: with resistance; NIL: standard

Contact Data

Contact Arrangement	1A (SPSTNO)
Contact Material	Ag-SnO ₂ , AgNi
Contact Rating (resistive)	30A/14VDC
Max. Switching Power	420W
Max. Switching Voltage	75VDC
Contact Resistance or Voltage drop	≤100mV (at 30A)
Operation life	Electrical 10 ⁵ Mechanical 10 ⁷

Max. Switching Current:30A
Item 3.12 of IEC255-7
Item 3.30 of IEC255-7
Item 3.31 of IEC255-7

Coil Parameter

Dash number	Coil voltage VDC		Coil resistance Ω±10%	Pickup voltage VDC(max) (67%of rated voltage)	release voltage VDC(min) (12.5% of rated voltage)	Coil power consumption W	Operate Time ms	Release Time ms
	Rate d	Max.						
012-2200	12	15.6	67	8	1.5	2.2	≤7	≤5

CAUTION: 1.The use of any coil voltage less than the rated coil voltage will compromise the operation of the relay.

2.Pickup and release voltage are for test purposes only and are not to be used as design criteria.

Operation condition

Insulation Resistance ¹⁾	100M Ω min (at 500VDC)	Item 7 of IEC255-5
Dielectric Strength ¹⁾		
Between contacts	50Hz 500V	Item 6 of IEC255-5
Between contact and coil	50Hz 500V	Item 6 of IEC255-5
Shock resistance	147m/s ² 11ms	IEC68-2-27 Test Ea
Vibration resistance	10~40Hz double amplitude 1.5mm	IEC68-2-6 Test Fc
Terminals strength	8N	IEC68-2-21 Test Ua2
Solderability	235 $^{\circ}$ C \pm 2 $^{\circ}$ C 3 \pm 0.5s	IEC68-2-20 Test Ta method 1
Ambient Temperature	-40~85 $^{\circ}$ C	
Relative Humidity	85% (at 40 $^{\circ}$ C)	IEC68-2-3 Test Ca
Mass	30g	

Note: 1). When testing, coil terminals shall be connect ,If coil transient suppression is installed in relay .

Qualification inspection:

Perform the qualification test as specified in the table IV of IEC255-19-1 and minimum sample size 24.

Dimensions (Unit: mm)

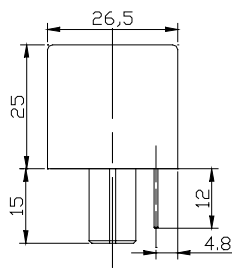

Dimensions

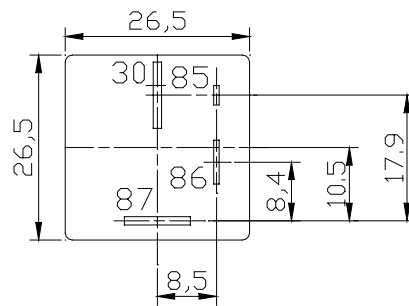
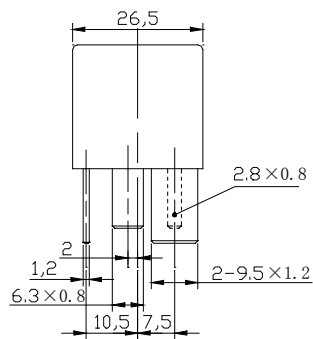

Mounting (Bottom views)

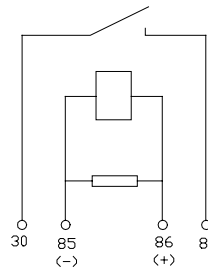

Wiring diagram (Bottom views)

mm	inch
0.8	0.031
1.2	0.047
2	0.079
2.8	0.110
4.8	0.189
6.3	0.248
7.5	0.295
8.4	0.331
8.5	0.335
9.5	0.374
10.5	0.413
11	0.433
12	0.472
15	0.591
16	0.669
17.9	0.705
25	0.984
26.5	1.043

NOTES 1).Dimensions are in millimeter.

2).Inch equivalentents are given for general information only.