

Type	BMS-2701
Rated Impedance(Ω)	16 \pm 20%
Rated(Max.) Power(W)	0.1(0.2)
Resonant Frequency(Hz)	600 \pm 25%
Rated Freq.Range(Hz)	$f_0 \sim 3500$
Sound Pressure Level(dB)	78 \pm 3
Magnet(g)	3.7
Operating Temperature($^{\circ}$ C)	-10 \sim +40

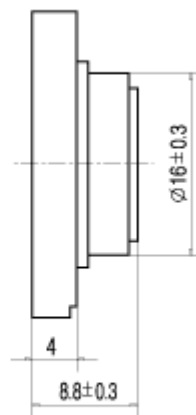

Unit:mm

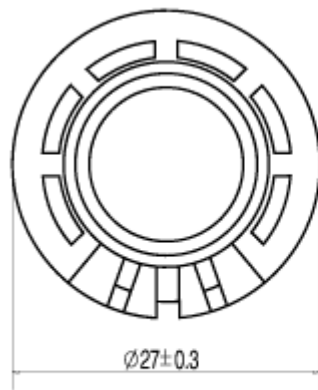