

BIPOLAR ANALOG INTEGRATED CIRCUIT

μ PC2400A Series

THREE TERMINAL LOW DROPOUT VOLTAGE REGULATOR

DESCRIPTION

μ PC2400A Series are low dropout regulators which have 1 A capable for the output current. These ICs are built-in the saturation protection circuit of the output transistor.

FEATURES

- Built-in the saturation protection circuit of the output transistor.
- The capability of output current is 1 A
- High accuracy of output voltage.
 - $|\Delta V_o| \leq \pm 2\%$ ($T_J = 25\text{ }^\circ\text{C}$)
 - $|\Delta V_o| \leq \pm 3\%$ ($0\text{ }^\circ\text{C} \leq T_J \leq 125\text{ }^\circ\text{C}$)
- Low dropout voltage.
 - $V_{DIF} \leq 1\text{ V}$ ($I_o \leq 1\text{ A}$, $T_J \leq 125\text{ }^\circ\text{C}$)
- Built-in overcurrent protection circuit, thermal shut-down circuit.
- Built-in Safe Operating Area protection circuit.
- Compatible for μ PC2400 Series.

CONNECTION DIAGRAM (TOP VIEW)

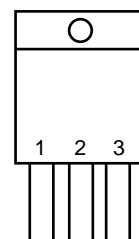

1: INPUT
2: GND
3: OUTPUT

ORDERING INFORMATION

Output Voltage	Type Number	Package
5 V	μ PC2405AHF	MP-45G (Isolated TO-220)
6 V	μ PC2406AHF	
7 V	μ PC2407AHF	
8 V	μ PC2408AHF	
9 V	μ PC2409AHF	
10 V	μ PC2410AHF	
12 V	μ PC2412AHF	
15 V	μ PC2415AHF	
18 V	μ PC2418AHF	

BLOCK DIAGRAM

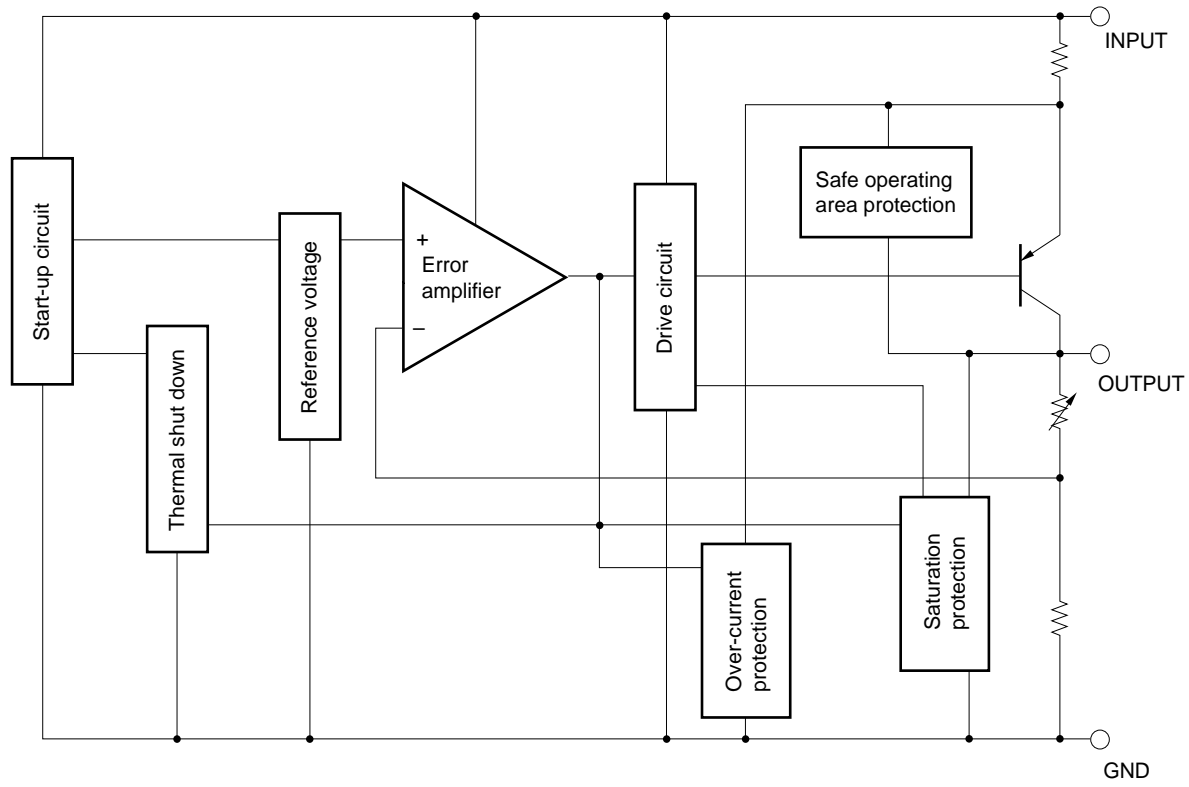

ABSOLUTE MAXIMUM RATINGS (T_A = 25 °C, Unless otherwise specified.)

PARAMETER	SYMBOL	RATING	UNIT
Input Voltage	V _{IN}	36	V
Internal Power Dissipation	P _{T(Tc = 25 °C)}	15 Note	W
Operating Ambient Temperature Range	T _A	-20 to +85	°C
Operating Junction Temperature Range	T _J	-20 to +150	°C
Storage Temperature Range	T _{stg}	-55 to +150	°C
Thermal Resistance (Junction to Case)	R _{th(J - C)}	5.0	°C/W
Thermal Resistance (Junction to Ambient)	R _{th(J - A)}	65	°C/W

Note Internally limited

TYPICAL CONNECTION

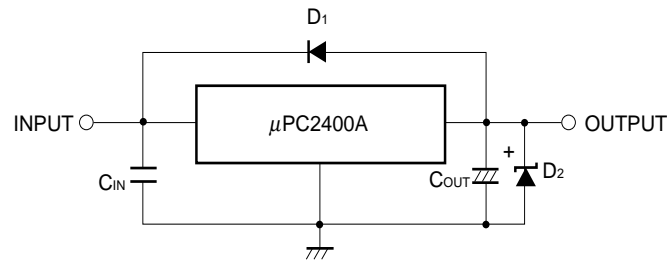

C_{IN} : 0.1 to 0.47 μF.

C_{OUT} : More than 47 μF.

D₁ : Need for V_O > V_{IN}.

D₂ : Need for V_O < GND.

RECOMMENDED OPERATING CONDITIONS

PARAMETER	SYMBOL	TYPE NUMBER	MIN.	TYP.	MAX.	UNIT
Input Voltage	V _{IN}	μPC2405AHF	6	9	20	V
		μPC2406AHF	7	10	21	
		μPC2407AHF	8	11	22	
		μPC2408AHF	9	13	23	
		μPC2409AHF	10	14	24	
		μPC2410AHF	11	15	25	
		μPC2412AHF	13	18	27	
		μPC2415AHF	16	22	27	
μPC2418AHF	19	25	28			
Output Current	I _o	All	0		1	A
Operating Ambient Temperature Range	T _A	All	-20		+85	°C
Operating Junction Temperature Range	T _J	All	-20		+125	°C

ELECTRICAL CHARACTERISTICS

μPC2405A ($V_{IN} = 9\text{ V}$, $I_o = 500\text{ mA}$, $T_J = 25\text{ °C}$, Unless otherwise specified)

PARAMETER	SYMBOL	MIN.	TYP.	MAX.	UNIT	TEST CONDITIONS
Output Voltage	V_o	4.9	5.0	5.1	V	
		4.85		5.15		$6\text{ V} \leq V_{IN} \leq 20\text{ V}$, $5\text{ mA} \leq I_o \leq 500\text{ mA}$, $0\text{ °C} \leq T_J \leq 125\text{ °C}$
		4.85		5.15		$5\text{ mA} \leq I_o \leq 1\text{ A}$, $0\text{ °C} \leq T_J \leq 125\text{ °C}$
Line Regulation	REG_{IN}		6	50	mV	$6.5\text{ V} \leq V_{IN} \leq 20\text{ V}$
Load Regulation	REG_L		3	50	mV	$5\text{ mA} \leq I_o \leq 1\text{ A}$
Quiescent Current	I_{BIAS}		2.3	3.2	mA	$I_o = 0$
			9	60		$I_o = 1\text{ A}$
Start-up Current	$I_{BIAS(S)}$			15	mA	$V_{IN} = 4.5\text{ V}$, $I_o = 0\text{ mA}$
				75		$V_{IN} = 4.5\text{ V}$, $I_o = 1\text{ A}$
Quiescent Current Change	ΔI_{BIAS}			20	mA	$6.5\text{ V} \leq V_{IN} \leq 20\text{ V}$, $I_o = 1\text{ A}$
Output Noise Voltage	V_n		90		μV_{rms}	$10\text{ Hz} \leq f \leq 100\text{ kHz}$
Ripple Rejection	R·R	59	64		dB	$f = 120\text{ Hz}$, $6.5\text{ V} \leq V_{IN} \leq 16.5\text{ V}$
Dropout Voltage	V_{DIF}		0.5	1.0	V	$I_o = 1\text{ A}$, $0\text{ °C} \leq T_J \leq 125\text{ °C}$
Short Circuit Current	I_{Oshort}		1.2		A	$V_{IN} = 20\text{ V}$
Peak Output Current	I_{Opeak}	1.65	2.2	3.1	A	
Temperature Coefficient of Output Voltage	$\Delta V_o/\Delta T$		-0.4		mV/°C	$I_o = 5\text{ mA}$, $0\text{ °C} \leq T_J \leq 125\text{ °C}$

μPC2406A ($V_{IN} = 10\text{ V}$, $I_o = 500\text{ mA}$, $T_J = 25\text{ °C}$, Unless otherwise specified)

PARAMETER	SYMBOL	MIN.	TYP.	MAX.	UNIT	TEST CONDITIONS
Output Voltage	V_o	5.88	6.0	6.12	V	
		5.82		6.18		$7\text{ V} \leq V_{IN} \leq 21\text{ V}$, $5\text{ mA} \leq I_o \leq 500\text{ mA}$, $0\text{ °C} \leq T_J \leq 125\text{ °C}$
		5.82		6.18		$5\text{ mA} \leq I_o \leq 1\text{ A}$, $0\text{ °C} \leq T_J \leq 125\text{ °C}$
Line Regulation	REG_{IN}		7	60	mV	$7.5\text{ V} \leq V_{IN} \leq 21\text{ V}$
Load Regulation	REG_L		4	60	mV	$5\text{ mA} \leq I_o \leq 1\text{ A}$
Quiescent Current	I_{BIAS}		2.3	3.2	mA	$I_o = 0$
			9	60		$I_o = 1\text{ A}$
Start-up Current	$I_{BIAS(S)}$			15	mA	$V_{IN} = 5.5\text{ V}$, $I_o = 0\text{ mA}$
				75		$V_{IN} = 5.5\text{ V}$, $I_o = 1\text{ A}$
Quiescent Current Change	ΔI_{BIAS}			20	mA	$7.5\text{ V} \leq V_{IN} \leq 21\text{ V}$, $I_o = 1\text{ A}$
Output Noise Voltage	V_n		110		μV_{rms}	$10\text{ Hz} \leq f \leq 100\text{ kHz}$
Ripple Rejection	R·R	58	63		dB	$f = 120\text{ Hz}$, $7.5\text{ V} \leq V_{IN} \leq 17.5\text{ V}$
Dropout Voltage	V_{DIF}		0.5	1.0	V	$I_o = 1\text{ A}$, $0\text{ °C} \leq T_J \leq 125\text{ °C}$
Short Circuit Current	I_{Oshort}		1.2		A	$V_{IN} = 21\text{ V}$
Peak Output Current	I_{Opeak}	1.65	2.2	3.1	A	
Temperature Coefficient of Output Voltage	$\Delta V_o/\Delta T$		0.4		mV/°C	$I_o = 5\text{ mA}$, $0\text{ °C} \leq T_J \leq 125\text{ °C}$

μPC2407A (V_{IN} = 11 V, I_o = 500 mA, T_J = 25 °C, Unless otherwise specified)

PARAMETER	SYMBOL	MIN.	TYP.	MAX.	UNIT	TEST CONDITIONS
Output Voltage	V _O	6.86	7.0	7.14	V	
		6.79		7.21		8 V ≤ V _{IN} ≤ 22 V, 5 mA ≤ I _o ≤ 500 mA, 0 °C ≤ T _J ≤ 125 °C
		6.79		7.21		5 mA ≤ I _o ≤ 1 A, 0 °C ≤ T _J ≤ 125 °C
Line Regulation	REG _{IN}		8	70	mV	8.5 V ≤ V _{IN} ≤ 22 V
Load Regulation	REG _L		4	70	mV	5 mA ≤ I _o ≤ 1 A
Quiescent Current	I _{BIAS}		2.3	3.2	mA	I _o = 0
			9	60		I _o = 1 A
Start-up Current	I _{BIAS(S)}			15	mA	V _{IN} = 6.5 V, I _o = 0 mA
				75		V _{IN} = 6.5 V, I _o = 1 A
Quiescent Current Change	ΔI _{BIAS}			20	mA	8.5 V ≤ V _{IN} ≤ 22 V, I _o = 1 A
Output Noise Voltage	V _n		130		μV _{rms}	10 Hz ≤ f ≤ 100 kHz
Ripple Rejection	R·R	57	62		dB	f = 120 Hz, 8.5 V ≤ V _{IN} ≤ 18.5 V
Dropout Voltage	V _{DIF}		0.5	1.0	V	I _o = 1 A, 0 °C ≤ T _J ≤ 125 °C
Short Circuit Current	I _{short}		1.2		A	V _{IN} = 22 V
Peak Output Current	I _{peak}	1.65	2.2	3.1	A	
Temperature Coefficient of Output Voltage	ΔV _O /ΔT		0.4		mV/°C	I _o = 5 mA, 0 °C ≤ T _J ≤ 125 °C

μPC2408A (V_{IN} = 13 V, I_o = 500 mA, T_J = 25 °C, Unless otherwise specified)

PARAMETER	SYMBOL	MIN.	TYP.	MAX.	UNIT	TEST CONDITIONS
Output Voltage	V _O	7.85	8.0	8.15	V	
		7.75		8.25		9 V ≤ V _{IN} ≤ 23 V, 5 mA ≤ I _o ≤ 500 mA, 0 °C ≤ T _J ≤ 125 °C
		7.75		8.25		5 mA ≤ I _o ≤ 1 A, 0 °C ≤ T _J ≤ 125 °C
Line Regulation	REG _{IN}		9	80	mV	9.5 V ≤ V _{IN} ≤ 23 V
Load Regulation	REG _L		5	80	mV	5 mA ≤ I _o ≤ 1 A
Quiescent Current	I _{BIAS}		2.3	3.2	mA	I _o = 0
			9	60		I _o = 1 A
Start-up Current	I _{BIAS(S)}			15	mA	V _{IN} = 7.5 V, I _o = 0 mA
				75		V _{IN} = 7.5 V, I _o = 1 A
Quiescent Current Change	ΔI _{BIAS}			20	mA	9.5 V ≤ V _{IN} ≤ 23 V, I _o = 1 A
Output Noise Voltage	V _n		150		μV _{rms}	10 Hz ≤ f ≤ 100 kHz
Ripple Rejection	R·R	56	61		dB	f = 120 Hz, 9.5 V ≤ V _{IN} ≤ 19.5 V
Dropout Voltage	V _{DIF}		0.5	1.0	V	I _o = 1 A, 0 °C ≤ T _J ≤ 125 °C
Short Circuit Current	I _{short}		1.2		A	V _{IN} = 23 V
Peak Output Current	I _{peak}	1.6	2.2	3.05	A	
Temperature Coefficient of Output Voltage	ΔV _O /ΔT		0.5		mV/°C	I _o = 5 mA, 0 °C ≤ T _J ≤ 125 °C

μPC2409A (V_{IN} = 14 V, I_o = 500 mA, T_J = 25 °C, Unless otherwise specified)

PARAMETER	SYMBOL	MIN.	TYP.	MAX.	UNIT	TEST CONDITIONS
Output Voltage	V _O	8.82	9.0	9.18	V	
		8.73		9.27		10 V ≤ V _{IN} ≤ 24 V, 5 mA ≤ I _o ≤ 500 mA, 0 °C ≤ T _J ≤ 125 °C
		8.73		9.27		5 mA ≤ I _o ≤ 1 A, 0 °C ≤ T _J ≤ 125 °C
Line Regulation	REG _{IN}		11	90	mV	10.5 V ≤ V _{IN} ≤ 24 V
Load Regulation	REG _L		5	90	mV	5 mA ≤ I _o ≤ 1 A
Quiescent Current	I _{BIAS}		2.4	3.2	mA	I _o = 0
			9	60		I _o = 1 A
Start-up Current	I _{BIAS(S)}			15	mA	V _{IN} = 8.5 V, I _o = 0 mA
				75		V _{IN} = 8.5 V, I _o = 1 A
Quiescent Current Change	ΔI _{BIAS}			20	mA	10.5 V ≤ V _{IN} ≤ 24 V, I _o = 1 A
Output Noise Voltage	V _n		170		μV _{rms}	10 Hz ≤ f ≤ 100 kHz
Ripple Rejection	R·R	55	60		dB	f = 120 Hz, 10.5 V ≤ V _{IN} ≤ 20.5 V
Dropout Voltage	V _{DIF}		0.5	1.0	V	I _o = 1 A, 0 °C ≤ T _J ≤ 125 °C
Short Circuit Current	I _{Oshort}		1.0		A	V _{IN} = 24 V
Peak Output Current	I _{Opeak}	1.6	2.2	3.05	A	
Temperature Coefficient of Output Voltage	ΔV _O /ΔT		0.9		mV/°C	I _o = 5 mA, 0 °C ≤ T _J ≤ 125 °C

μPC2410A (V_{IN} = 15 V, I_o = 500 mA, T_J = 25 °C, Unless otherwise specified)

PARAMETER	SYMBOL	MIN.	TYP.	MAX.	UNIT	TEST CONDITIONS
Output Voltage	V _O	9.8	10	10.2	V	
		9.7		10.3		11 V ≤ V _{IN} ≤ 25 V, 5 mA ≤ I _o ≤ 500 mA, 0 °C ≤ T _J ≤ 125 °C
		9.7		10.3		5 mA ≤ I _o ≤ 1 A, 0 °C ≤ T _J ≤ 125 °C
Line Regulation	REG _{IN}		12	100	mV	11.5 V ≤ V _{IN} ≤ 25 V
Load Regulation	REG _L		6	100	mV	5 mA ≤ I _o ≤ 1A
Quiescent Current	I _{BIAS}		2.4	3.2	mA	I _o = 0
			9	60		I _o = 1 A
Start-up Current	I _{BIAS(S)}			15	mA	V _{IN} = 9.5 V, I _o = 0 mA
				75		V _{IN} = 9.5 V, I _o = 1 A
Quiescent Current Change	ΔI _{BIAS}			20	mA	11.5 V ≤ V _{IN} ≤ 25 V, I _o = 1 A
Output Noise Voltage	V _n		190		μV _{rms}	10 Hz ≤ f ≤ 100 kHz
Ripple Rejection	R·R	54	59		dB	f = 120 Hz, 11.5 V ≤ V _{IN} ≤ 21.5 V
Dropout Voltage	V _{DIF}		0.5	1.0	V	I _o = 1 A, 0 °C ≤ T _J ≤ 125 °C
Short Circuit Current	I _{Oshort}		1.0		A	V _{IN} = 25 V
Peak Output Current	I _{Opeak}	1.6	2.2	3.05	A	
Temperature Coefficient of Output Voltage	ΔV _O /ΔT		0.8		mV/°C	I _o = 5 mA, 0 °C ≤ T _J ≤ 125 °C

μPC2412A (V_{IN} = 18 V, I_o = 500 mA, T_J = 25 °C, Unless otherwise specified)

PARAMETER	SYMBOL	MIN.	TYP.	MAX.	UNIT	TEST CONDITIONS
Output Voltage	V _O	11.75	12	12.25	V	
		11.65		12.35		13 V ≤ V _{IN} ≤ 27 V, 5 mA ≤ I _o ≤ 500 mA, 0 °C ≤ T _J ≤ 125 °C
		11.65		12.35		5 mA ≤ I _o ≤ 1 A, 0 °C ≤ T _J ≤ 125 °C
Line Regulation	REG _{IN}		14	120	mV	14 V ≤ V _{IN} ≤ 27 V
Load Regulation	REG _L		7	120	mV	5 mA ≤ I _o ≤ 1 A
Quiescent Current	I _{BIAS}		2.4	3.2	mA	I _o = 0
			10	60		I _o = 1 A
Start-up Current	I _{BIAS(S)}			15	mA	V _{IN} = 11.5 V, I _o = 0 mA
				75		V _{IN} = 11.5 V, I _o = 1 A
Quiescent Current Change	ΔI _{BIAS}			20	mA	14 V ≤ V _{IN} ≤ 27 V, I _o = 1 A
Output Noise Voltage	V _n		230		μV _{rms}	10 Hz ≤ f ≤ 100 kHz
Ripple Rejection	R·R	53	58		dB	f = 120 Hz, 14 V ≤ V _{IN} ≤ 24 V
Dropout Voltage	V _{DIF}		0.5	1.0	V	I _o = 1 A, 0 °C ≤ T _J ≤ 125 °C
Short Circuit Current	I _{short}		0.8		A	V _{IN} = 27 V
Peak Output Current	I _{opeak}	1.58	2.2	3.03	A	
Temperature Coefficient of Output Voltage	ΔV _O /ΔT		0.8		mV/°C	I _o = 5 mA, 0 °C ≤ T _J ≤ 125 °C

μPC2415A (V_{IN} = 22 V, I_o = 500 mA, T_J = 25 °C, Unless otherwise specified)

PARAMETER	SYMBOL	MIN.	TYP.	MAX.	UNIT	TEST CONDITIONS
Output Voltage	V _O	14.7	15	15.3	V	
		14.55		15.45		16 V ≤ V _{IN} ≤ 27 V, 5 mA ≤ I _o ≤ 500 mA, 0 °C ≤ T _J ≤ 125 °C
		14.55		15.45		5 mA ≤ I _o ≤ 1 A, 0 °C ≤ T _J ≤ 125 °C
Line Regulation	REG _{IN}		18	150	mV	17 V ≤ V _{IN} ≤ 27 V
Load Regulation	REG _L		9	150	mV	5 mA ≤ I _o ≤ 1A
Quiescent Current	I _{BIAS}		2.5	3.2	mA	I _o = 0
			10	60		I _o = 1 A
Start-up Current	I _{BIAS(S)}			15	mA	V _{IN} = 14.5 V, I _o = 0 mA
				75		V _{IN} = 14.5 V, I _o = 1 A
Quiescent Current Change	ΔI _{BIAS}			20	mA	17 V ≤ V _{IN} ≤ 27 V, I _o = 1 A
Output Noise Voltage	V _n		290		μV _{rms}	10 Hz ≤ f ≤ 100 kHz
Ripple Rejection	R·R	51	56		dB	f = 120 Hz, 17 V ≤ V _{IN} ≤ 27 V
Dropout Voltage	V _{DIF}		0.5	1.0	V	I _o = 1 A, 0 °C ≤ T _J ≤ 125 °C
Short Circuit Current	I _{short}		0.8		A	V _{IN} = 27 V
Peak Output Current	I _{opeak}	1.55	2.2	3.0	A	
Temperature Coefficient of Output Voltage	ΔV _O /ΔT		1.6		mV/°C	I _o = 5 mA, 0 °C ≤ T _J ≤ 125 °C

μ PC2418A ($V_{IN} = 25\text{ V}$, $I_o = 500\text{ mA}$, $T_J = 25\text{ }^\circ\text{C}$, Unless otherwise specified)

PARAMETER	SYMBOL	MIN.	TYP.	MAX.	UNIT	TEST CONDITIONS
Output Voltage	V_o	17.64	18	18.36	V	
		17.46		18.54		$19\text{ V} \leq V_{IN} \leq 28\text{ V}$, $5\text{ mA} \leq I_o \leq 500\text{ mA}$, $0\text{ }^\circ\text{C} \leq T_J \leq 125\text{ }^\circ\text{C}$
		17.46		18.54		$5\text{ mA} \leq I_o \leq 1\text{ A}$, $0\text{ }^\circ\text{C} \leq T_J \leq 125\text{ }^\circ\text{C}$
Line Regulation	REG_{IN}		22	180	mV	$20\text{ V} \leq V_{IN} \leq 28\text{ V}$
Load Regulation	REG_L		11	180	mV	$5\text{ mA} \leq I_o \leq 1\text{ A}$
Quiescent Current	I_{BIAS}		2.5	3.2	mA	$I_o = 0$
			10	60		$I_o = 1\text{ A}$
Start-up Current	$I_{BIAS(S)}$			15	mA	$V_{IN} = 17.5\text{ V}$, $I_o = 0\text{ mA}$
				75		$V_{IN} = 17.5\text{ V}$, $I_o = 1\text{ A}$
Quiescent Current Change	ΔI_{BIAS}			20	mA	$20\text{ V} \leq V_{IN} \leq 28\text{ V}$, $I_o = 1\text{ A}$
Output Noise Voltage	V_n		350		μV_{rms}	$10\text{ Hz} \leq f \leq 100\text{ kHz}$
Ripple Rejection	R·R	49	54		dB	$f = 120\text{ Hz}$, $20\text{ V} \leq V_{IN} \leq 28\text{ V}$
Dropout Voltage	V_{DIF}		0.5	1.0	V	$I_o = 1\text{ A}$, $0\text{ }^\circ\text{C} \leq T_J \leq 125\text{ }^\circ\text{C}$
Short Circuit Current	I_{Oshort}		0.8		A	$V_{IN} = 28\text{ V}$
Peak Output Current	I_{Opeak}	1.55	2.2	3.0	A	
Temperature Coefficient of Output Voltage	$\Delta V_o/\Delta T$		2.5		$\text{mV}/^\circ\text{C}$	$I_o = 5\text{ mA}$, $0\text{ }^\circ\text{C} \leq T_J \leq 125\text{ }^\circ\text{C}$

TYPICAL CHARACTERISTICS

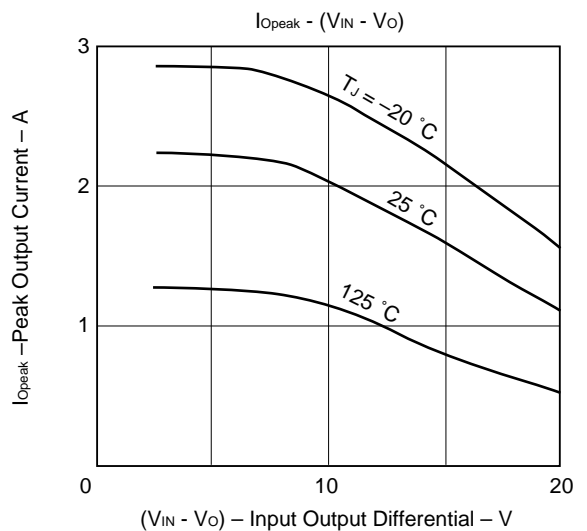
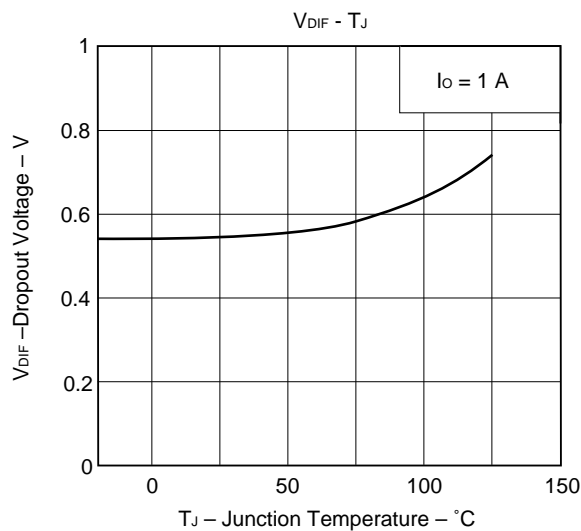
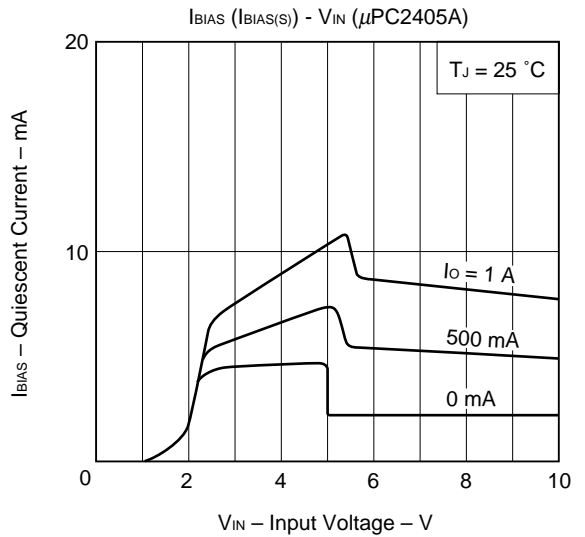
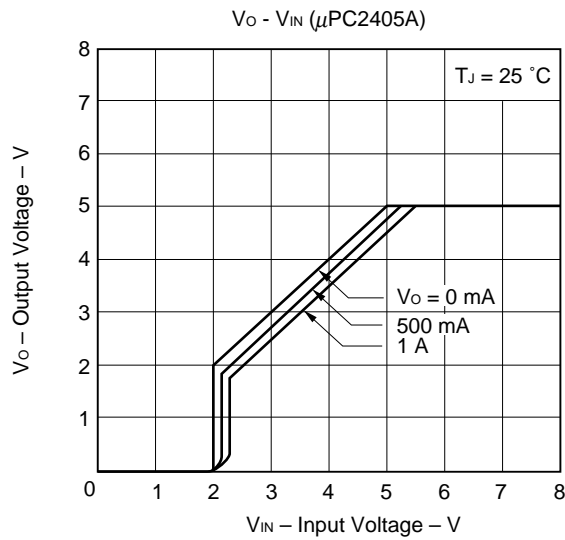
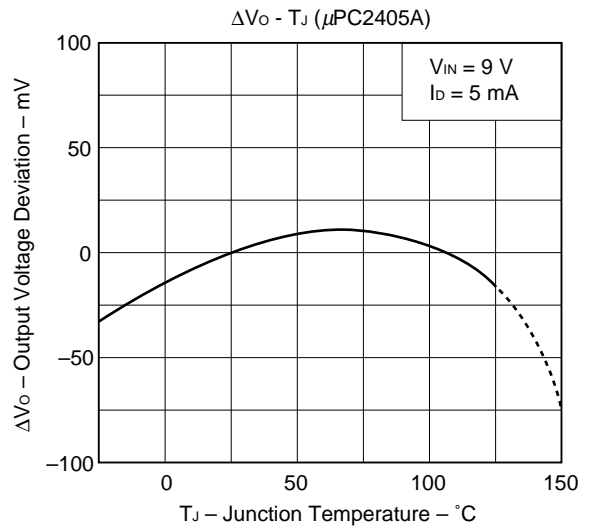
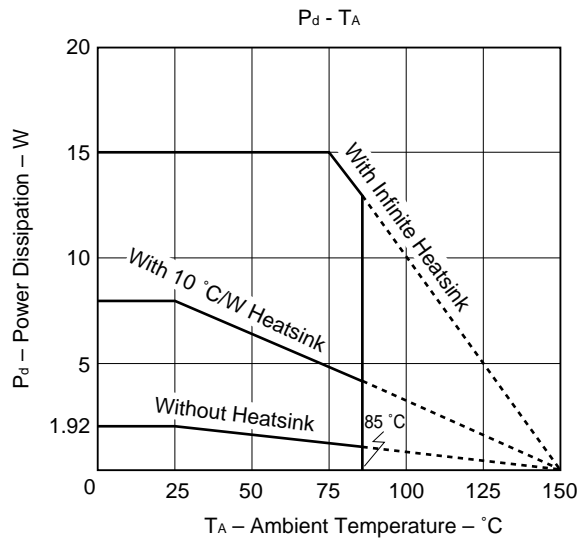

TYPICAL CHARACTERISTICS

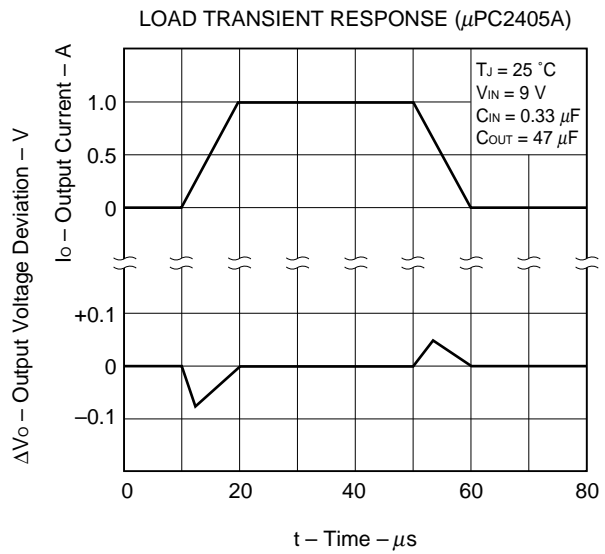
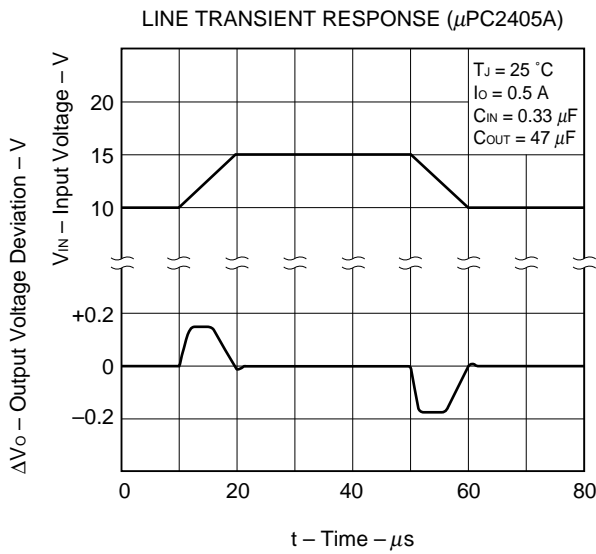
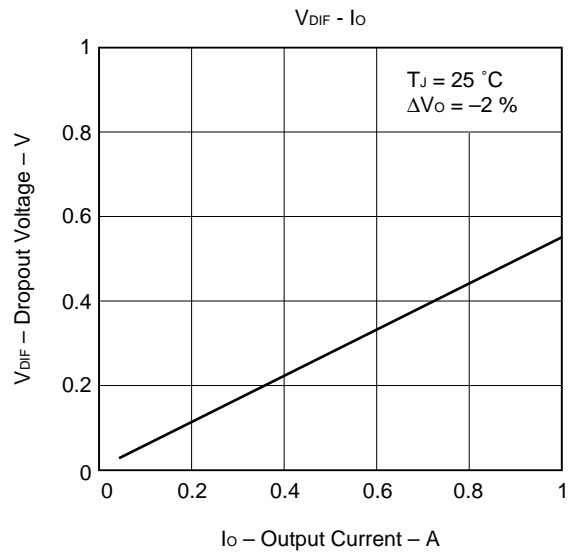
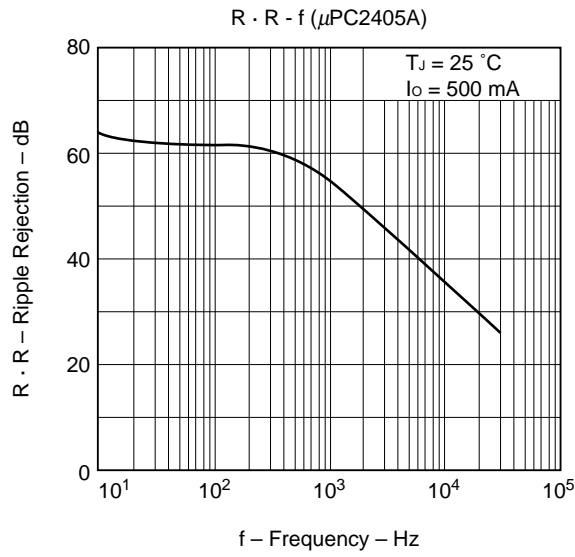

PACKAGE DIMENSIONS (Unit: mm)

μPC2400AHF Series

3PIN PLASTIC SIP (MP-45G)

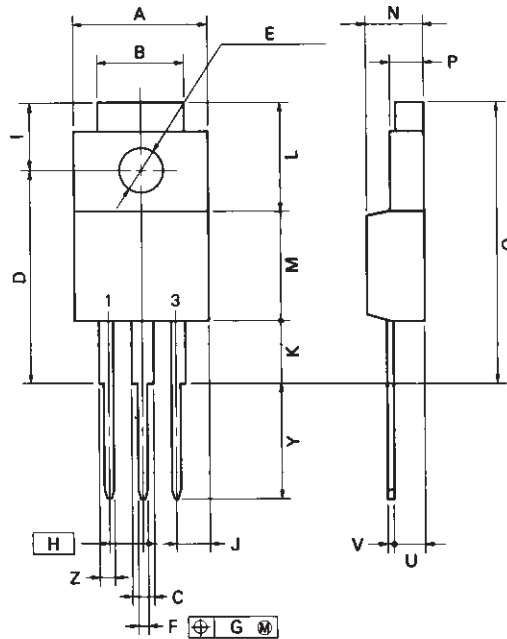

P3HF-254B-1

NOTE

Each lead centerline is located within 0.25 mm (0.01 inch) of its true position (T.P.) at maximum material condition.

ITEM	MILLIMETERS	INCHES
A	10.4 MAX.	0.410 MAX.
B	7.0	0.276
C	1.2 MIN.	0.047 MIN.
D	17.0 ^{±0.3}	0.669 ^{+0.012} _{-0.013}
E	φ3.3 ^{±0.2}	φ0.130 ^{+0.008}
F	0.75 ^{±0.10}	0.030 ^{+0.004} _{-0.005}
G	0.25	0.010
H	2.54 (T.P.)	0.100 (T.P.)
I	5.0 ^{±0.3}	0.197 ^{±0.012}
J	2.66 MAX.	0.105 MAX.
K	4.8 MIN.	0.188 MIN.
L	8.5	0.335
M	8.5	0.335
N	4.5 ^{±0.2}	0.177 ^{±0.008}
P	2.8 ^{±0.2}	0.110 ^{+0.008} _{-0.008}
Q	22.4 MAX.	0.882 MAX.
U	2.4 ^{±0.5}	0.094 ^{+0.021} _{-0.020}
V	0.65 ^{±0.10}	0.026 ^{+0.004} _{-0.005}
Y	8.9 ^{±0.7}	0.350 ^{±0.028}
Z	1.0 MIN.	0.039 MIN.

RECOMMENDED SOLDERING CONDITIONS

The following conditions (see table below) must be met when soldering this product.

Please consult with our sales offices in case other soldering process is used, or in case soldering is done under different conditions.

TYPES OF THROUGH HOLE MOUNT DEVICE

μPC2400AHF Series

Soldering Process	Soldering Conditions	Symbol
Wave soldering	Solder temperature: 260 °C or below. Flow Time: 10 seconds or below.	

REFERENCE

Document Name	Document No.
NEC semiconductor device reliability/quality control system.	IEI-1212
Quality grade on NEC semiconductor devices.	IEI-1209
Semiconductor device mounting technology manual.	IEI-1207
Semiconductor device package manual.	IEI-1213
Guide to quality assurance for semiconductor devices.	MEI-1202
Semiconductor selection guide.	MF-1134

[MEMO]